



Questions and Responses

C003623

Bayard Cutting Visitor Center Exhibits

No.	IFB Section	IFB Page	Question	Response
1	Exhibit A	X003	Will an onsite dumpster be provided by the Visitors Center?	Exhibit Contractor is responsible to remove all trash from the site per Exhibit B - Exhibit Specifications 8.4.D.3.
2	Exhibit A	X100 & X340	Is the bird strike film in the exhibit fabricators scope of work? If so, can more information be provided about Area 6 - Commercial Feather Friendly window markers? Is the exhibit fabricator's scope of work – Full coverage of windows using a specified film per Exhibit C A-201 (shaded glass panels)? Is the same type / design film being used on all windows and can the final specification be provided?	Yes, this work is included in the Exhibit Contractor's scope. Include in your bid cost to install full coverage of all windows around the Visitor Center. Specification is provided in Exhibit B - 6.11 Bird Friendly Window Application.
3	Exhibit A	X103	Will all HDMI Data Cable, 24GA Speaker Cable and Audio Cable runs from Control Room to outlets at AV locations be by the Visitor Center electrical contractor?	Yes, this scope is included in the Exhibit Contractor's work.
4	Exhibit A	X104	Is the exhibit contractor responsible for supply and installation of any of the Luxam light track or fixtures?	Yes, this scope is included in the Exhibit Contractor's work.
5	Exhibit A	X311	Is the petri dish provided by the client? If not, can a specification be provided?	Petri dishes shall be 100mm Polypropylene Petri Dish as manufactured by Eisco or approved equal.
6	Exhibit A	X321	How many tree tags are required?	Include a maximum of 16 tree tags.

7	Exhibit A	X330	Is the magnifying glass provided by the client? If not, can a specification be provided?	Magnifying glass will be provided by owner, therefore no specification is provided. Exhibit contractor to provide attachment of magnifying glass to the exhibit rail as shown in the detail.
8	Exhibit A	X330	Note mentions small cases and graphic pull-out drawers, how many of each are required?	There are no small cases or graphic pull-out drawers in this scope. Drawing has be revised.
9	Exhibit A	X340	Are the glass petri dish vitrines and magnifying glass provided by the client? If not, can a specification be provided?	Magnifying glass will be provided by owner, therefore no specification is provided. Petri dishes shall be 100mm Polypropylene Petri Dish as manufactured by Eisco or approved equal.
10	Exhibit A	X340	Note mentions small cases and graphic pull-out drawers, how many of each are required?	There are no small cases or graphic pull-out drawers in this scope. Drawing has be revised.
11	Exhibit A	X350	Can a quantity for the logbook and other artifacts be provided?	One (1) logbook as shown on X350 to be provided by owner for Exhibit Contractor to install and secure onto Exhibit 06. There will be no logbook or artifacts for Exhibit 01, these drawers will be storage.
12	Exhibit A	X412	Luxam Lighting – Please confirm the quantity of Micro LED Spotlights required and if possible, provide a list of required components.	12 lights per X104. 11 for installation and 1 for attic stock.
13	Exhibit A	X412	Is the duplex outlet shown by the Visitor Center electrical contractor?	Duplex outlet shown is part of Exhibit Contractor's scope.
14	Exhibit A	1/X421 & 2/X422	Are the track and light fixtures in the soffit millwork by the GC?	Track and lighting fixtures as listed on X104 is part of the Exhibit Contractor's scope. These include track and light fixtures in this millwork soffit.
15	Exhibit A	1&2/X 421, 2/X 422 & 1/X 423	Curved back panels are noted as WD-5 Pluma-Ply which is a rigid panel. Can a lay-up of bending ply core with a hardboard of equal be used in lieu of the Pluma-Ply?	The proposed alternate is acceptable.
16	Exhibit A	2/X423	Can a powder coat finish (RAL 7005 Mouse Gray, Matte or equal) be used in lieu of the clear anodized finish for the 8" aluminum tube?	The proposed alternate is acceptable.
17	Exhibit A	X424 & X431	Can 3/16" thick aluminum be used for the brackets in lieu of 3/16" steel?	Aluminum brackets are not acceptable for this application.

18	Exhibit A	1/X441	Are the glass petri dish vitrines provided by the client? If not, can a specification be provided?	To be provided by Exhibit Contractor, Petri dishes shall be 100mm Polypropylene Petri Dish as manufactured by Eisco or approved equal.
19	Exhibit B, Section 8	46	Is union labor a requirement for onsite installation?	Yes, this is a prevailing wage project per IFB 5.20.
20	Exhibit B	8	Can Mock-Ups be first article?	Mock-up can be used as a final product pending it meets all approvals.
21	Exhibit B	29-40	Graphics – Please confirm the production / print ready graphic / text files will be provided.	Yes, files will be provided by Owner. Files will be ready for proofing by Exhibit Contractor.
22	Exhibit A	X203	Who provides the botanical models?	Owner will provide.
23	Exhibit A	X203	Are they actual specimens or replicas?	Replicas.
24	Exhibit A	X310	Can you provide more information on the diachromatic printing specifications?	Owner may select either dichromatic or dye sublimation printing for the items shown on X310 based on constructability and ease of maintenance. Diachromatic shall be dual color filament 3D printing using polylactic acid (PLA) material. Dye sublimation shall be dyes that are infused onto the matte aluminum panel with a UV-resistant coating. See revised Exhibit B - 6.8.A 3 and 4.
25	Exhibit A	X104	Our understanding of the drawings has the exhibit contractor responsible for providing: - Six LSI LX2030 fixtures, reflectors, and baffles and one Luxam Micro Track. - All the Luxam equipment in Exhibit 01: Museum of Trees - All of the Lusam equipment in Exhibit 02: Tree Science. Can you confirm?	Confirmed. Exhibit Contractor to provide (6) LSI LX2030 fixtures, reflectors, and baffles and (1) Luxam Micro Track, all the Luxam equipment in Exhibit 01 and Exhibit 02. All other light fixtures not in Exhibit Contractor scope.
26	Exhibit A	X100	Does the exhibit space and reception area have a drop ceiling?	Yes, A-550 will be provided for reference.

27	Exhibit A	X410-X450	The drawings specify white oak as the wood species for the exhibit structures. However there is no specification for the type of veneer. Bidding would dictate that we budget for the least expense option. This would be disappointing in an exhibit about trees. Can you be more specific about the type of veneer -- flat cut, plain sliced, quarter sawn, or rift sawn?	White oak veneer shall be flat cut, bookmatched, 5-inch minimum veneer width.
28	Exhibit A	X320	There is a call out that the fabricator is to "treat and preserve" the horizontal tree sections. Are these sections fresh cut or have they been dried? Is it necessary to prevent them from splitting and cracking or do they only need to be sealed. Do the sections need to be treated for pests like powder post beetles?	This scope has been removed from the Exhibit Contractor's scope of work. Owner will treat and preserve the horizontal tree sections and provide them to the Exhibit Contractor to attach mounts and install on the Tree Science wall.
29	Exhibit A	X320	When was the vertical tree section cut? Is the wood dry or wet? Will it be shipped to the fabricators facility or is it there responsibility to pick it up at the site?	Information on when tree sections was removed is not available, however tree sections will be treated and preserved by the owner. These will be dry and on site ready for mounting and installation onto Tree Science wall.
30	General		Who is General Contractor working on building.	G&M Earthmoving
31	General		Is there a target budget for exhibit fabrication?	Budget is not available.
32	General		What is largest doorway into exhibit space?	39 1/2" x 94 1/4" clear
33	Exhibit A	X410	1- North Elevation 2- Plan Exhibit 01 Glass Display Cloches Vertical support "D" proper location?	Refer to dimensions in plan. Final dimensions to be confirmed in shop drawing submittal.
34	Exhibit A	X442 & X443	Stamped Removed – Please Confirm?	Detail 2 has been removed from the scope.
35	Audiovisual		Who is responsible for the content/media files, touchscreen control files, exhibit scheduling?	Owner to provide content/media files and touchscreen control files.

36	Audiovisual		Who is responsible for loading the content/media files onto the playback devices?	A/V consultant will load media onto devices.
37	Audiovisual		Will there be a requirement for Content Management Solution to handle upgrades, changes, and remote access?	Control Management Solutions and remote access are not required.
38	Audiovisual		What is the control strategy for Audiovisual control of the AV components?	All media will be loaded onto SD drives.
39	Audiovisual		Will there be a need for network connection to the digital media player?	Network communication outlets will all be installed by Visitor Center electric contractor near A/V devices for future network connectivity.
40	Audiovisual		What are the anticipated display resolution(s) for the Content Media?	All media devices will be provided by owner.
41	Audiovisual		Will all the AC power requirements from the Circuit Panel to the Exhibits be handled by the GC or EC?	Yes, all power is provided by the Visitor Center electric contractor, Rolands Electric.
42	Audiovisual		Will the Data drops for signal and control also be handled by the GC & EC?	Yes, all data drops are provided by the Visitor Center electric contractor, Rolands Electric.
43	Audiovisual		Who is responsible for the structural elements (blocking, Unistrut, hang-points, Etc.) for all the projector and display locations?	Exhibit contractor is responsible for all necessary structural elements. Coordination will be required with the Visitor Center GC contractor.
44	Audiovisual		AV-2, AV-3, AV-4, AV-5, AV-7 Touchscreens and Displays require bezels?	Yes, for AV-2, AV-3, AV-4, AV-5 A, see drawings X422, X442, X452. AV-7 is not part of Exhibit Contractor's scope.
45	Audiovisual		Who is responsible for providing and installing the Draper 142028 Reverse Scrolling Projection Screen in AV-6?	Owner will provide scrolling projector screen for Exhibit Fabricator to install.
46	Audiovisual		Will the above projection screen require low-voltage remote control from an AV Control Solution?	Yes, Exhibit Contractor to provide open and close control switch.
47	Audiovisual		Drawing X-105 Note #2: All AV Outlets will be switched with the exception of AV-6, which shall have its own independent switch. Can you please elaborate on the intended use of these 110VAC switches? Are these to be used for turning the AV Systems On/Off?	The intention with Note 2 is to provide an open and close control switch for the Scrolling Projection Screen.

48	Audiovisual		The Planar URP85-ERO-T LCD Touch Display is not recommended for use as a touch table. It is also recommended that the display have a PCAP touch overlay and not IR. Please specify an alternative for the AV-5 Touch Table.	Touch Display for this project has been changed to 65" EloTouch TouchPro PCAP (with anti-glare) - Model E215435.
49	Exhibit B		Is there a graphic panel schedule (excel, pdf) identifying Graphic Files (including labels), Production Method, Substrate (Dichromatic film is produced in multiple colors), Laminates, Size, Adhesion Method?	Owner will provide near or at the time of contract award. Information covered in Exhibit A & B provide the maximum amount of expected scope size for each graphic application.
50	Exhibit B		Is there a style guide identifying required color matches, font, panel hierarchy?	Owner will provide all graphics as production-ready files—ready for proofing—that follow the style guide as developed by the Owner's graphic design consultant. Style Guide will be provided for reference near or at the time of award. Fonts will need to be purchased for use by Exhibit Fabricator.
51	Exhibit B		Is the fabricator responsible for any part of the Comment book?	Comment Book to be provided by Owner. Exhibit Contractor to install/secure Comment Book to display.
52	X103	9	Please elaborate on "owner-provided AV hardware". Will the owner design firm install software programs on actual equipment, then ship to Exhibit Fabricator? Or will they forward programs that Exhibit Fabricator will install and adjust as needed to function?	Exhibit Contractor to install all owner provided A/V hardware. Owner's A/V consultant will come in and load and start up all programs after hardware is installed and powered on.
53	X103	9	Please confirm "owner-provided AV hardware". The cost for all multimedia equipment is by owner and NOT by Exhibit Fabricator.	Owner will provide all AV equipment for the Exhibit Contractor to install. All equipment will be on site.
54	X103	9	Is the drop down screen part of the "owner-provided AV hardware"?	Yes, owner will provide rolling projector screen for Exhibit Contractor to install.
55	X103	9	Does the "owner-provided AV hardware" include equipment rack(s) and wiring to each of the media stations?	Owner to provided listed items on X-103 - Wiring to be provided by Exhibit Contractor.

56	X203		Will the owner ship artifacts/samples/specimens to Exhibit Fabricator? Or will Exhibit Fabricator be responsible to pick up same at site and transport to shop?	All owner supplied material/artifacts will be located at the site for the Exhibit Contractor to install.
57	X204		Is the vinyl window film covering the entire pane of glass? or Are the graphics individual decals placed at strategic locations?	Vinyl window film aka Cadcut vinyl graphics will be placed in various areas to "annotate" trees viewed through the windows and located in Oak Park. Owner's graphic design consultant is designing these and locations will also be informed by/in conjunction with Feather Friendly application on all windows. Assume a maximum of 20 percent coverage of glass surface.
58	X310		Will owner supply the (21) botanical models ?	Yes.
59	Exhibit B		Since this is a fabrication scope, are there any final art files for production and can those be provided? Or do those need to be created and based on which documentation? The 100 CD set provided?	Owner is creating and providing all art files near or at the time of contract award for the Exhibit Contractor to produce and install.
60	Exhibit B		Is there final approved exhibit copy? Or would that need to be created?	Owner is creating and providing all art files that include exhibit copy near or at the time of contract award for the Exhibit Contractor to produce and install. Owner expects select hard proofs as well as digital proofs for ALL files.
61	Exhibit B		Is there a final visual styleguide with fonts, font hierarchy and a color palette?	Owner will provide all graphics as production-ready files—ready for proofing—that follow the style guide as developed by the Owner's graphic design consultant. Style Guide will be provided for reference. Fonts will need to be purchased for use by Exhibit Contractor.
62	Exhibit B		Has all media been procured and image acquired? If not, has the media been identified to estimate?	Owner will provide all media and images rights.
63	Exhibit B		Is there a graphics schedule?	Owner will provide near or at the time of contract award.

64	Exhibit B		Are there final material samples?	Exhibit Contractor to provide all material samples. Exhibit Contractor to proof and provide control sample for each graphic/material combo to ensure quality production.
----	-----------	--	-----------------------------------	---

**Bayard Cutting Arboretum
Parking & Visitor Center**

Bayard Cutting Arboretum State Park
440 Montauk Hwy, Great River, NY 11739

Consultants

Architect
Murphy Burnham & Bultrick Architects
48 West 37th Street, 14th Floor
New York, NY 10018
212.768.7676

Landscape Architect
Starr Whitehouse Landscape Architects
80 Broad Street, 1700
New York, NY, 10004
212.487.3272

Civil Engineer
Cashin Associates, P.C.
1200 Veterans Memorial Highway
Hauppauge, New York 11788
631.348.7600

Structural Engineer
Silman
32 Old Slip
New York, NY 10005
212.620.7970

Mechanical Engineer
Altieri Sebor Wieber Consulting Engineers
31 Knight Street
Norwalk, CT 06851
203.866.5538

Cost Consultant
Slocum Construction Consulting, Inc.
37 Pulver Road
Hudson, NY 12534
518.822.0834

Lighting Designer
Melanie Freundlich Lighting Design
252 West 38th Street
New York, NY 10018
212.741.0194

Surveyor
Naik Group
200 Metroplex Drive, Suite 403
Edison, New Jersey, 08817
212.575.2701

PV Installation Consultant
National Solar Technologies
166 Taylor Drive
Buffalo, NY, 14043
716.725.5913

Graphic Consultant
LVCK, Environmental Graphics
55 Broadway, Suite 322
New York, NY 10006
347.709.3927

Date	Issue	Rev.
20.12.18	50% Construction Documents	
21.05.19	90% Construction Documents	
22.05.26	100% Bid Set	
22.08.26	Conformed Set	

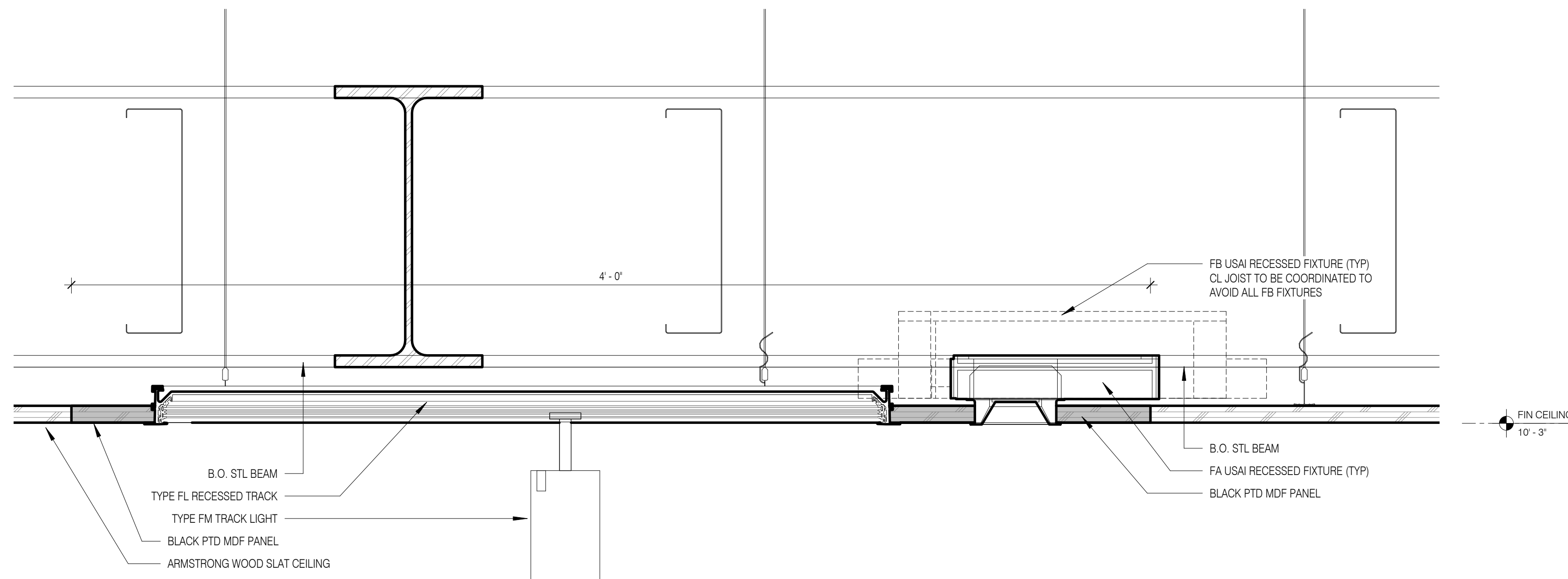
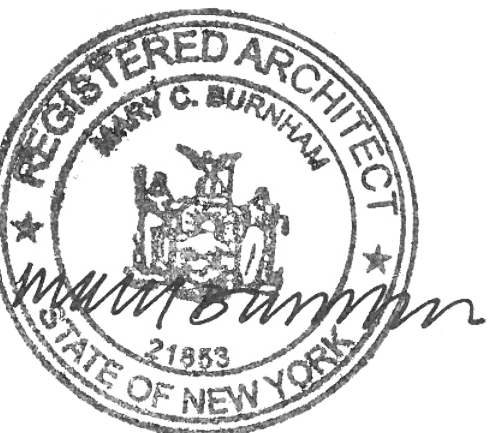

05 NORTH SOUTH INTERIOR WOOD CEILING SECTION 1
SCALE: 3" = 1'-0"

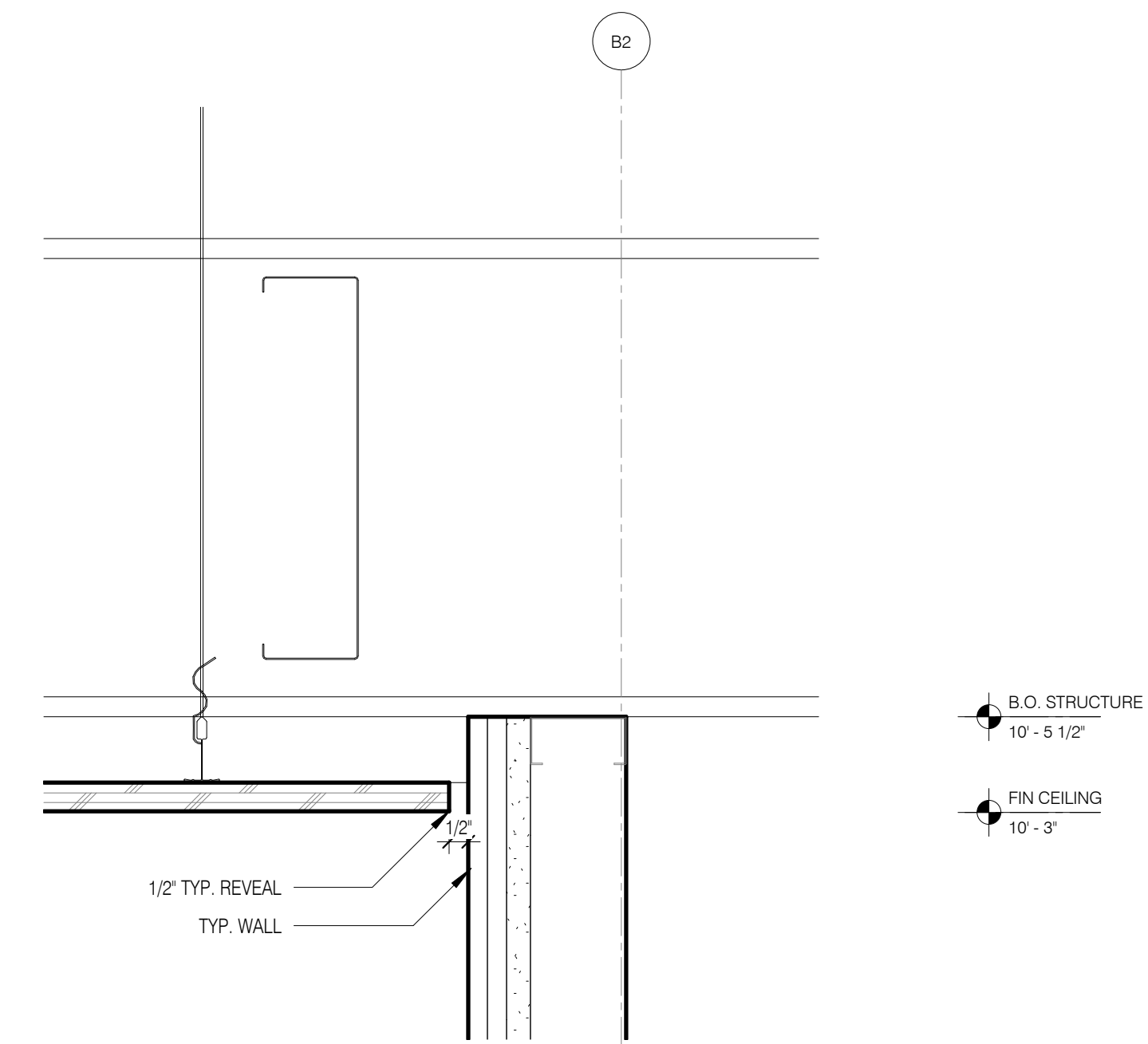

04 INTERIOR WOOD CEILING EDGE SECTION
SCALE: 3" = 1'-0"

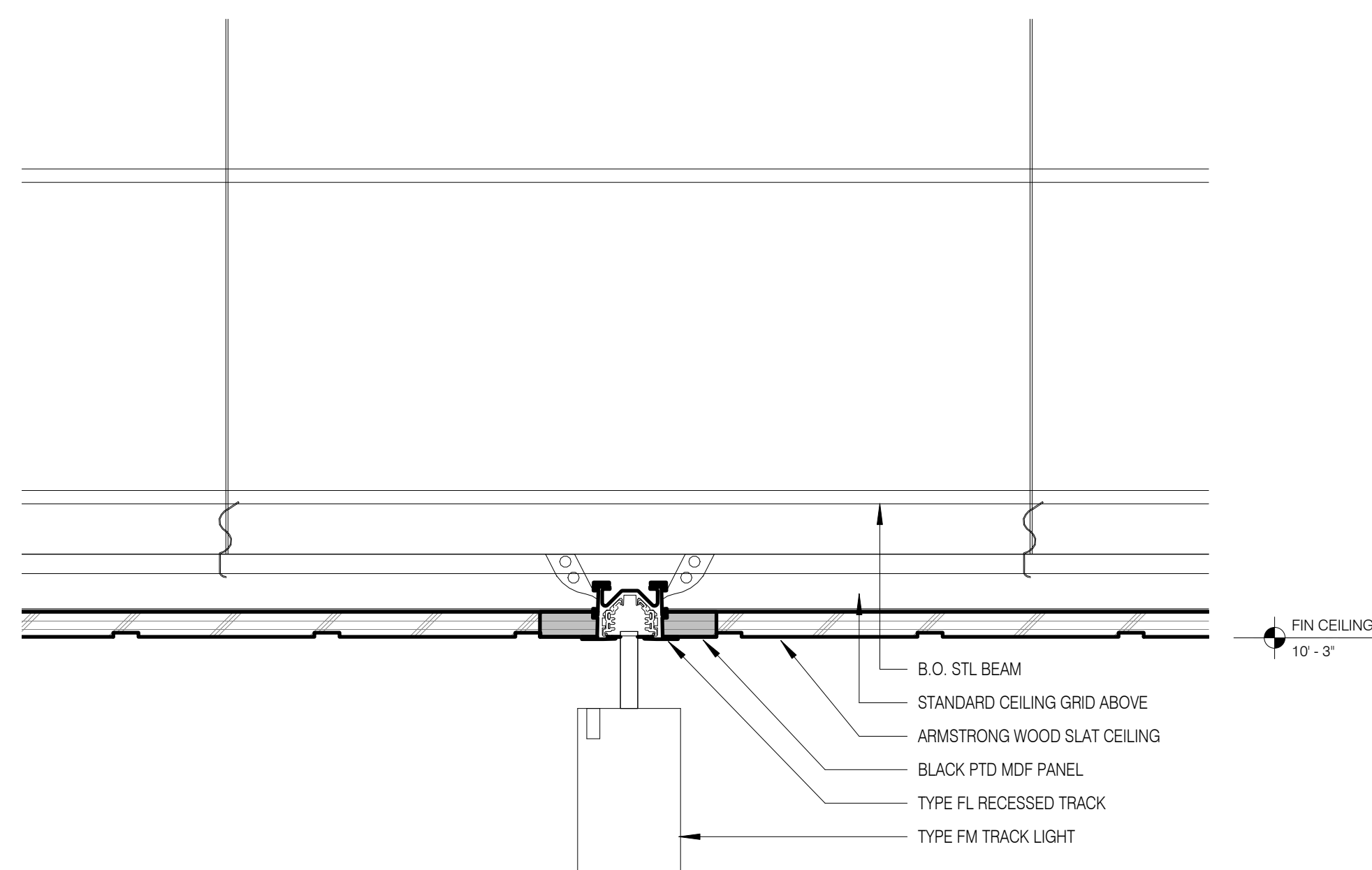

03 EAST WEST INTERIOR WOOD CEILING SECTION 2
SCALE: 3" = 1'-0"

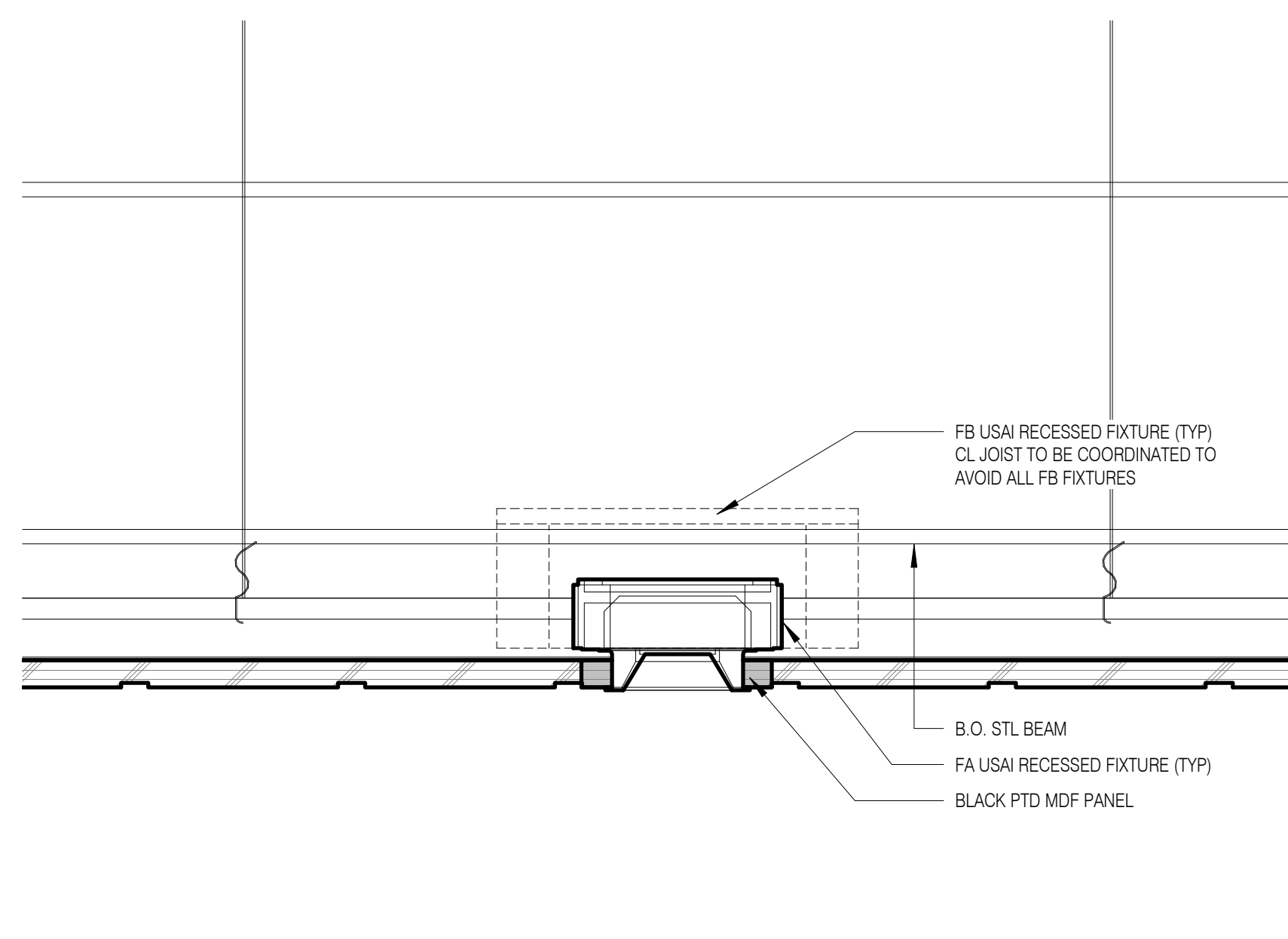

02 EAST WEST INTERIOR WOOD CEILING SECTION 1
SCALE: 3" = 1'-0"

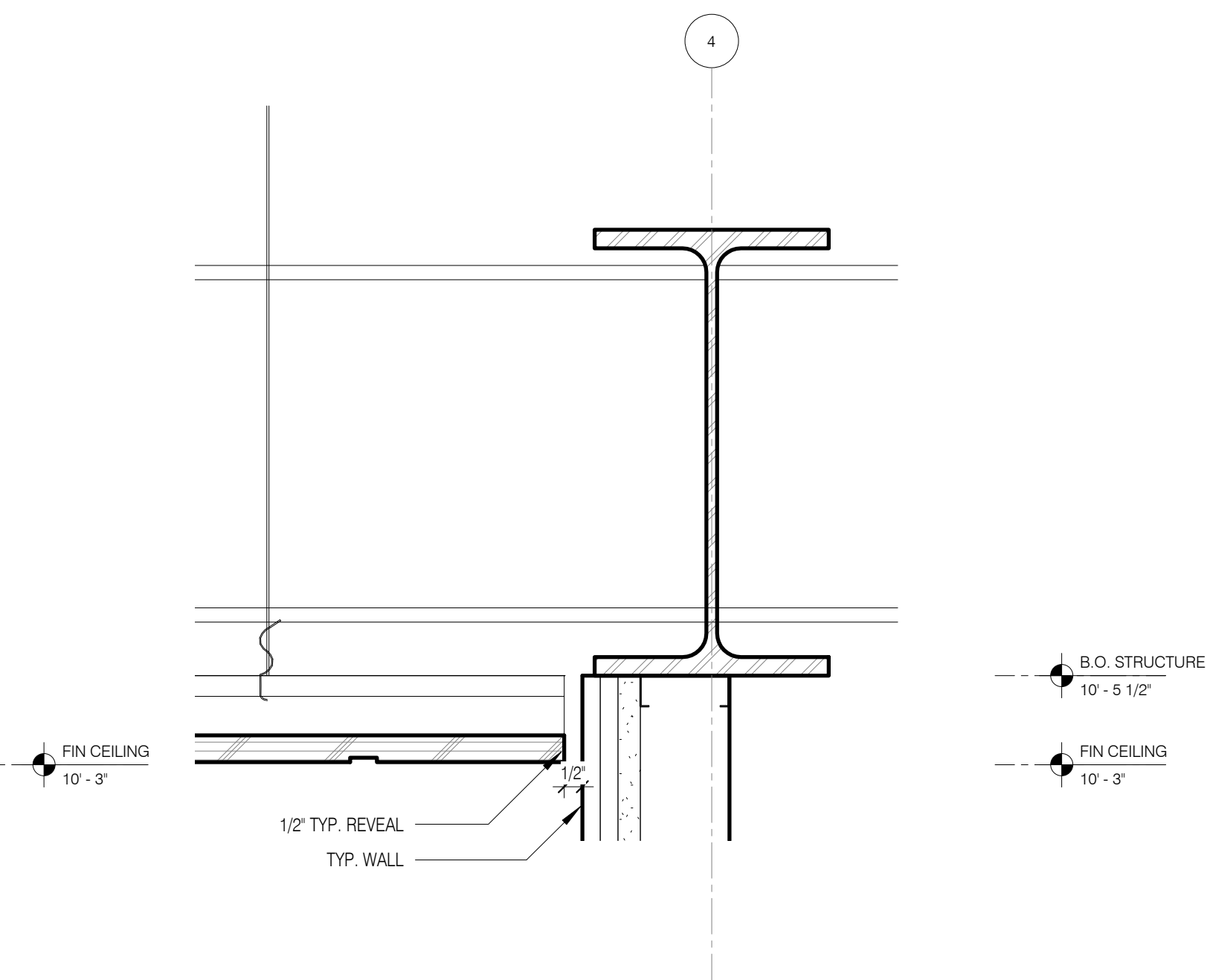

01 EAST WEST INTERIOR WOOD CEILING EDGE SECTION
SCALE: 3" = 1'-0"

A-550

INTERIOR DETAILS