

See Sheet 4 ↑

EMERGENCY ACCESS ROAD TO TRAIL ON ROAD TO FORMER BOILER PLANT.

TWO NARROW PARCELS TO BE ACQUIRED

HOSPITAL TRAIL LINK TO BLACK DIAMOND TRAIL

FUTURE LINKAGE TO PALEONTOLOGICAL RESEARCH INSTITUTE

TRAIL ON RAILROAD GRADE BETWEEN CASS PARK AND VILLAGE OF TRUMANSBURG

NYSEG OVERHEAD UTILITY LINES FROM STATION 23+000 TO 32+000. COORDINATE TRAIL LOCATION WITH NYSEG.

HOG HOLE UNIQUE NATURAL AREA

CORNELL/CITY OF ITHACA OVERLOOK AT CREEK

CAYUGA WATERFRONT TRAILHEAD AT CASS PARK RINK BY CITY OF ITHACA

EXISTING RESTROOMS

EMERGENCY ACCESS ON EXISTING DIRT ROAD

BLACK DIAMOND TRAIL ON OLD RAILROAD GRADE BETWEEN CASS PARK AND TRUMANSBURG

CAYUGA WATERFRONT TRAIL IN CASS PARK IS TRAIL SPUR TO TREMAN STATE MARINE PARK

BLACK DIAMOND TRAILHEAD IN CASS PARK. PROVIDE CABOOSE WITH TOURIST INFORMATION AND KIOSK.

See Sheet 2 ↓



MASTER PLAN

FIGURE MP-3
2007

Allan H. Treman State Marina Park to Taughannock Falls State Park

Legend

- Black Diamond Trail Alignment
- Black Diamond Trail Spurs
- Finger Lakes Trail
- Bridge/Creek Crossing
- Road Crossing
- Black Diamond Trail Stations
- Trailheads
- Emergency Access
- Kiosk
- Interpretive Site
- Seating Area
- Areas of Enlargement
- Buildings (1992)
- Municipal Boundaries
- Rail Road
- NYS Parks Lands
- Property to be Acquired
- Other Public Lands
- Forested Areas
- Taxparcels

References:
Tompkins County GIS Program
Digital Planimetric Series
2006 Tax Parcels

NYS Office of Parks, Recreation, & Historic Preservation
Finger Lakes Region
Trumansburg, N.Y. 14886

Consultants
Larsen Engineers
Northeast Greenways
Greg Potter

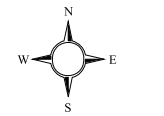

New York State Plane
Central Projection
1983 North American Datum

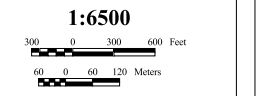



BLACK DIAMOND TRAIL

MASTER PLAN

FIGURE MP-4
2007

Allan H. Treman State Marina Park
to Taughannock Falls State Park

Legend

- Black Diamond Trail Alignment
- Black Diamond Trail Spurs
- Finger Lakes Trail
- Bridge/Creek Crossing
- Road Crossing
- Black Diamond Trail Stations
- Trailheads
- Emergency Access
- Kiosk
- Interpretive Site
- Seating Area
- Areas of Enlargement
- Buildings (1992)
- Municipal Boundaries
- Rail Road
- NYS Parks Lands
- Property to be Acquired
- Other Public Lands
- Forested Areas
- Taxparcels

References:
Tompkins County GIS Program
Digital Planimetric Series
2006 Tax Parcels

NYS Office of Parks,
Recreation, & Historic Preservation
Finger Lakes Region
Trumansburg, N.Y. 14886

Consultants
Larsen Engineers
Northeast Greenways
Greg Potter

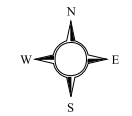

New York State Plane
Central Projection
1983 North American Datum

1:6500

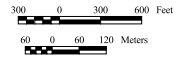

See Sheet 5 ↑

See Sheet 3 ↓

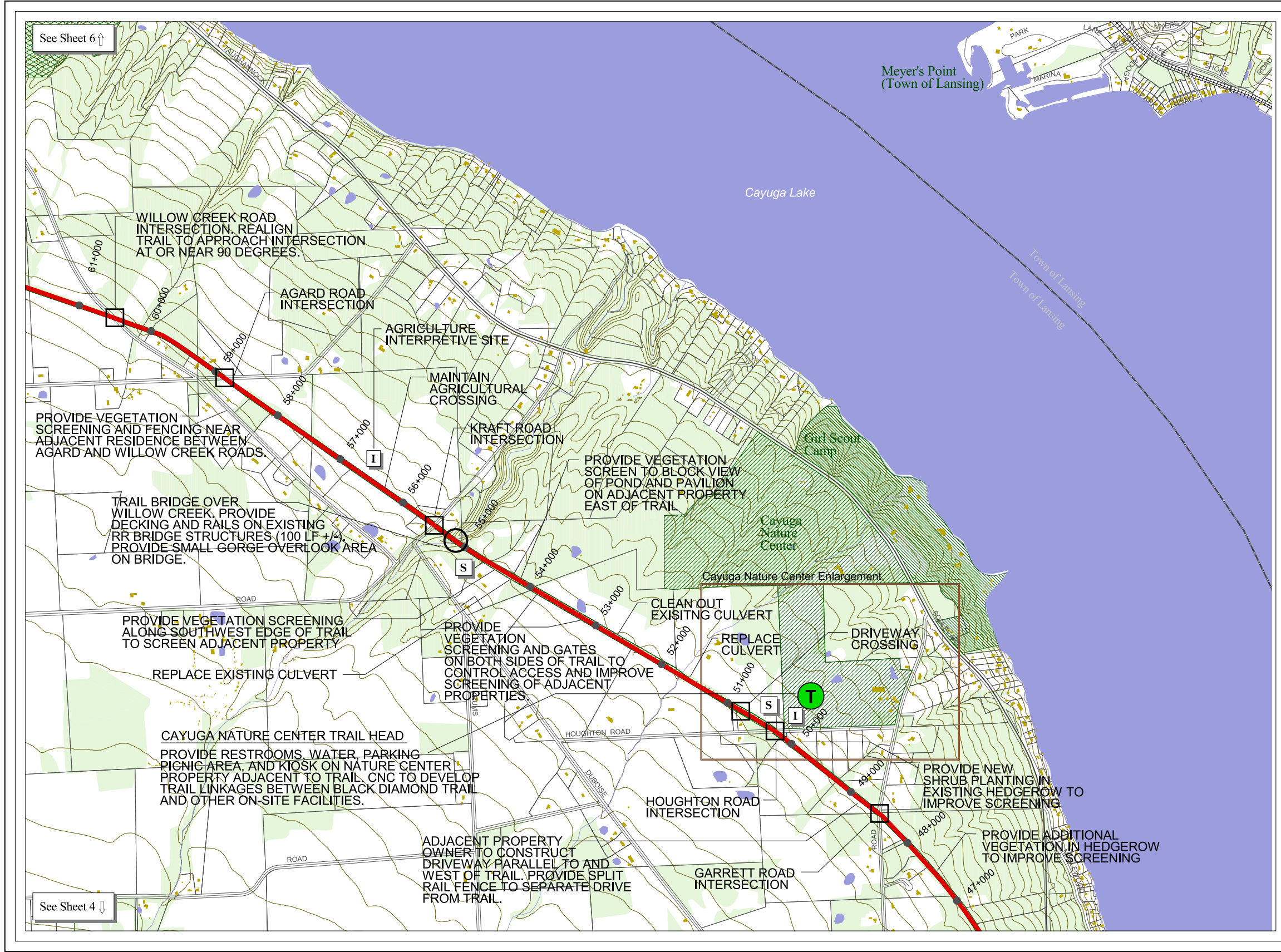

See Sheet 6 ↑

See Sheet 4 ↓

BLACK DIAMOND TRAIL

MASTER PLAN

FIGURE MP-5
2007

Allan H. Treman State Marina Park
to Taughannock Falls State Park

Legend

- Black Diamond Trail Alignment
- Black Diamond Trail Spurs
- Finger Lakes Trail
- Bridge/Creek Crossing
- Road Crossing
- Black Diamond Trail Stations
- Trailheads
- Emergency Access
- Kiosk
- Interpretive Site
- Seating Area
- Areas of Enlargement
- Buildings (1992)
- Municipal Boundaries
- Rail Road
- NYS Parks Lands
- Property to be Acquired
- Other Public Lands
- Forested Areas
- Taxparcels

References:
Tompkins County GIS Program
Digital Planimetric Series
2006 Tax Parcels

NYS Office of Parks,
Recreation, & Historic Preservation
Finger Lakes Region
Trumansburg, N.Y. 14886

Consultants
Larsen Engineers
Northeast Greenways
Greg Potter

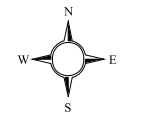

New York State Plane
Central Projection
1983 North American Datum

1:6500

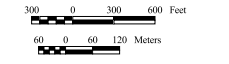

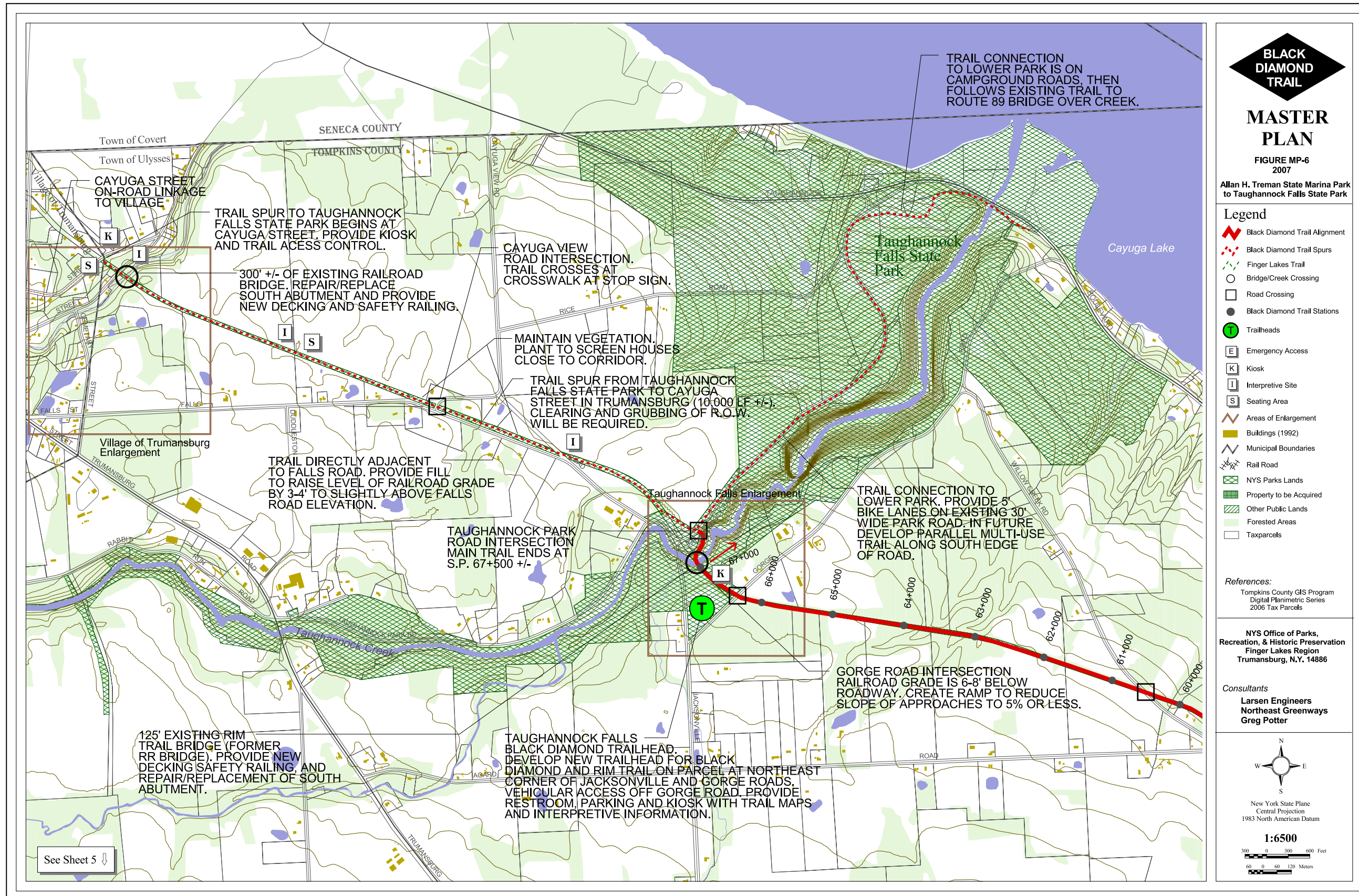

BLACK DIAMOND TRAIL

MASTER PLAN

FIGURE MP-6
2007

Allan H. Treman State Marina Park
to Taughannock Falls State Park

Legend

- Black Diamond Trail Alignment
- Black Diamond Trail Spurs
- Finger Lakes Trail
- Bridge/Creek Crossing
- Road Crossing
- Black Diamond Trail Stations
- Trailheads
- Emergency Access
- Kiosk
- Interpretive Site
- Seating Area
- Areas of Enlargement
- Buildings (1992)
- Municipal Boundaries
- Rail Road
- NYS Parks Lands
- Property to be Acquired
- Other Public Lands
- Forested Areas
- Taxparcels

References:
Tompkins County GIS Program
Digital Planimetric Series
2006 Tax Parcels

NYS Office of Parks,
Recreation, & Historic Preservation
Finger Lakes Region
Trumansburg, N.Y. 14886

Consultants
Larsen Engineers
Northeast Greenways
Greg Potter



New York State Plane
Central Projection
1983 North American Datum

1:6500

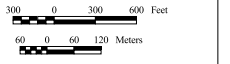

See Sheet 5