

Appendix D

Existing and Proposed Drawings

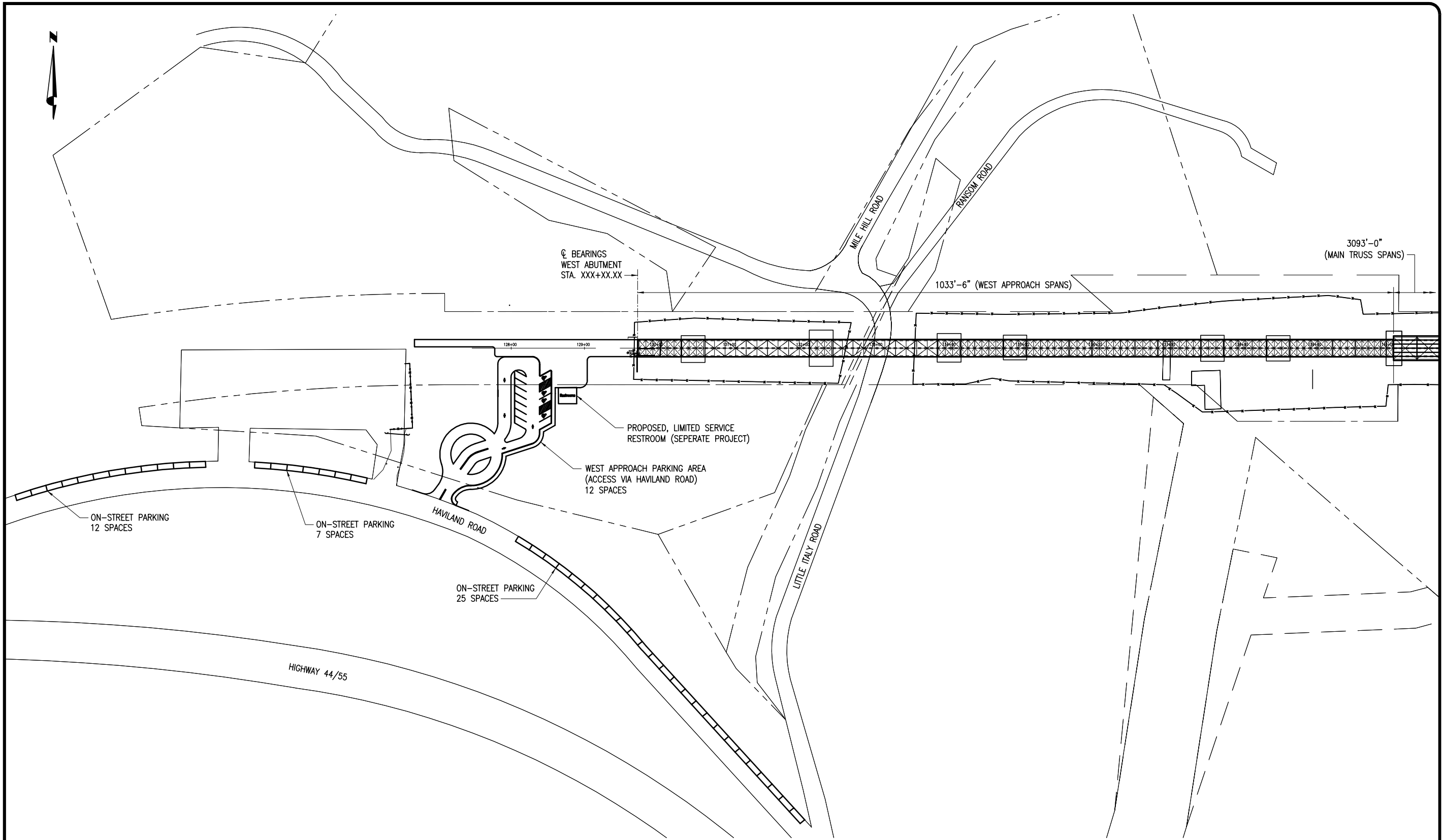

**SITE PLAN
(WEST APPROACH)**
NO SCALE

NOTES:
 1. FOR THE FOLLOWING SEE: _____ DWG. NO.
 A. XXXXXXXXXXXX _____ XX-XX
 B. XXXXXXXXXXXX _____ XX-XX



STATE OF NEW YORK
 OFFICE OF PARKS, RECREATION AND HISTORIC PRESERVATION
 EASTERN DISTRICT - TACONIC REGION
 P.O. BOX 308, 75 MILLS MANSION DRIVE
 STAATSBURG, NEW YORK 12580
 (XXX) XXX-XXXX FAX: (XXX) XXX-XXXX

WARNING:
 ANY ALTERATIONS TO THIS DOCUMENT NOT
 CONFORMING TO SECTION 209,
 SUBDIVISION 2, NEW YORK STATE EDUCATION
 LAW, ARE STRICTLY PROHIBITED.



**WALKWAY OVER THE HUDSON
 POUGHKEEPSIE - HIGHLAND
 RAILROAD BRIDGE
 GENERAL SITE PLAN
 WEST APPROACH**

XXX DESIGNED		
XXX DRAWN		
XXX CHECKED		
AS SHOWN SCALE		
FEB. 2008 DATE	NO. REVISIONS	DATE

SHEET NO. **D-1**

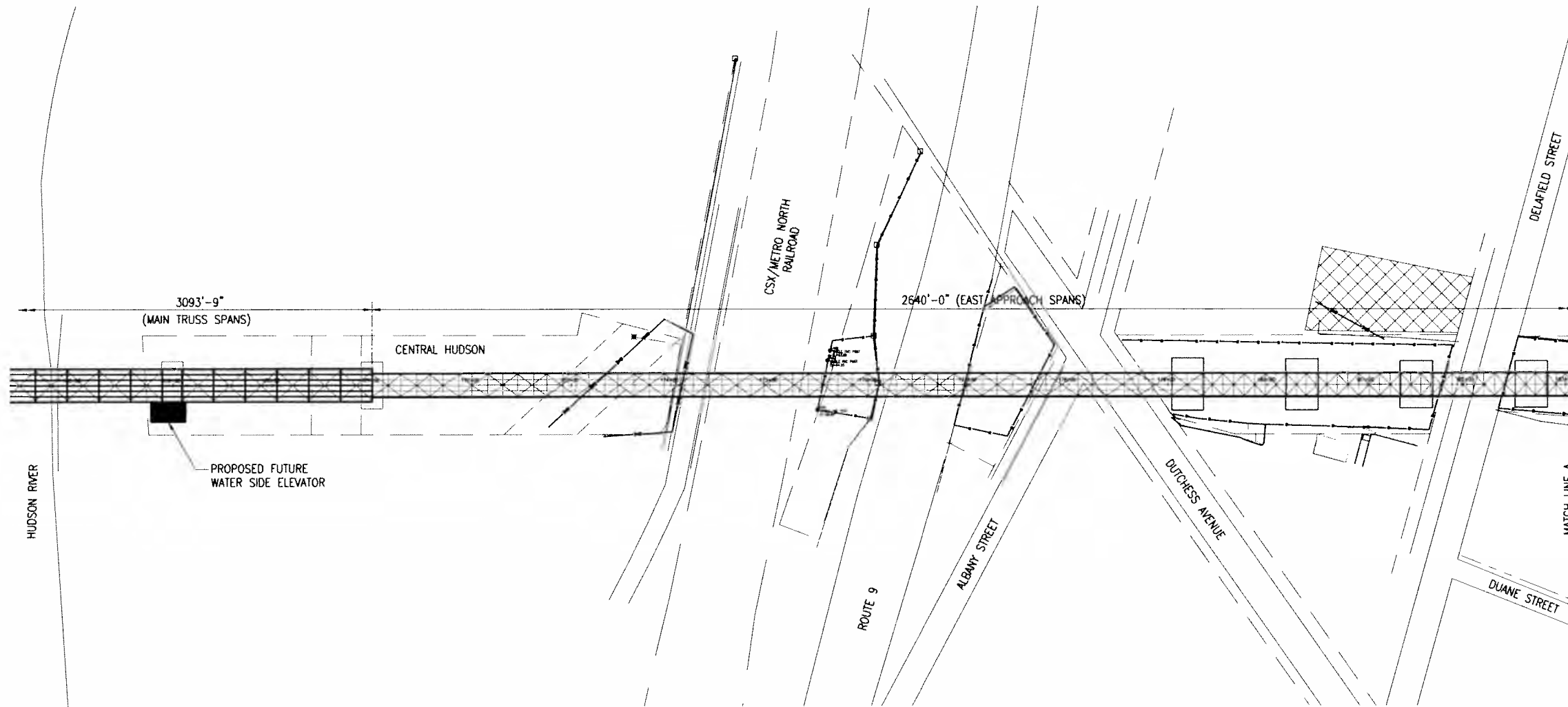

**SITE PLAN
(EAST APPROACH)**
NO SCALE

LEGEND:

 PROPOSED ELEVATOR LOCATION

NOTES:

1. FOR THE FOLLOWING SEE: DWG. NO.
 A. XXXXXXXXXXXX XX-XX
 B. XXXXXXXXXXXX XX-XX



STATE OF NEW YORK
 OFFICE OF PARKS, RECREATION AND HISTORIC PRESERVATION
 EASTERN DISTRICT - TACONIC REGION
 P.O. BOX 308, 75 MILLS MANSION DRIVE
 STAATSBURG, NEW YORK 12580
 (XXX) XXX-XXXX FAX: (XXX) XXX-XXXX

WARNING:
 ANY ALTERATIONS TO THIS DOCUMENT NOT
 CONFORMING TO SECTION 7209
 SUBDIVISION 2, NEW YORK STATE EDUCATION
 LAW, ARE STRICTLY PROHIBITED.



WALKWAY OVER THE HUDSON
 POUGHKEEPSIE - HIGHLAND
 RAILROAD BRIDGE

GENERAL SITE PLAN
 EAST APPROACH

XXX DESIGNED		
XXX DRAWN		
XXX CHECKED		
AS SHOWN SCALE		
FEB. 2008 DATE	NO.	DATE
	REVISIONS	
SHEET NO.	D-2	
FILE NO.	SP1.DWG	

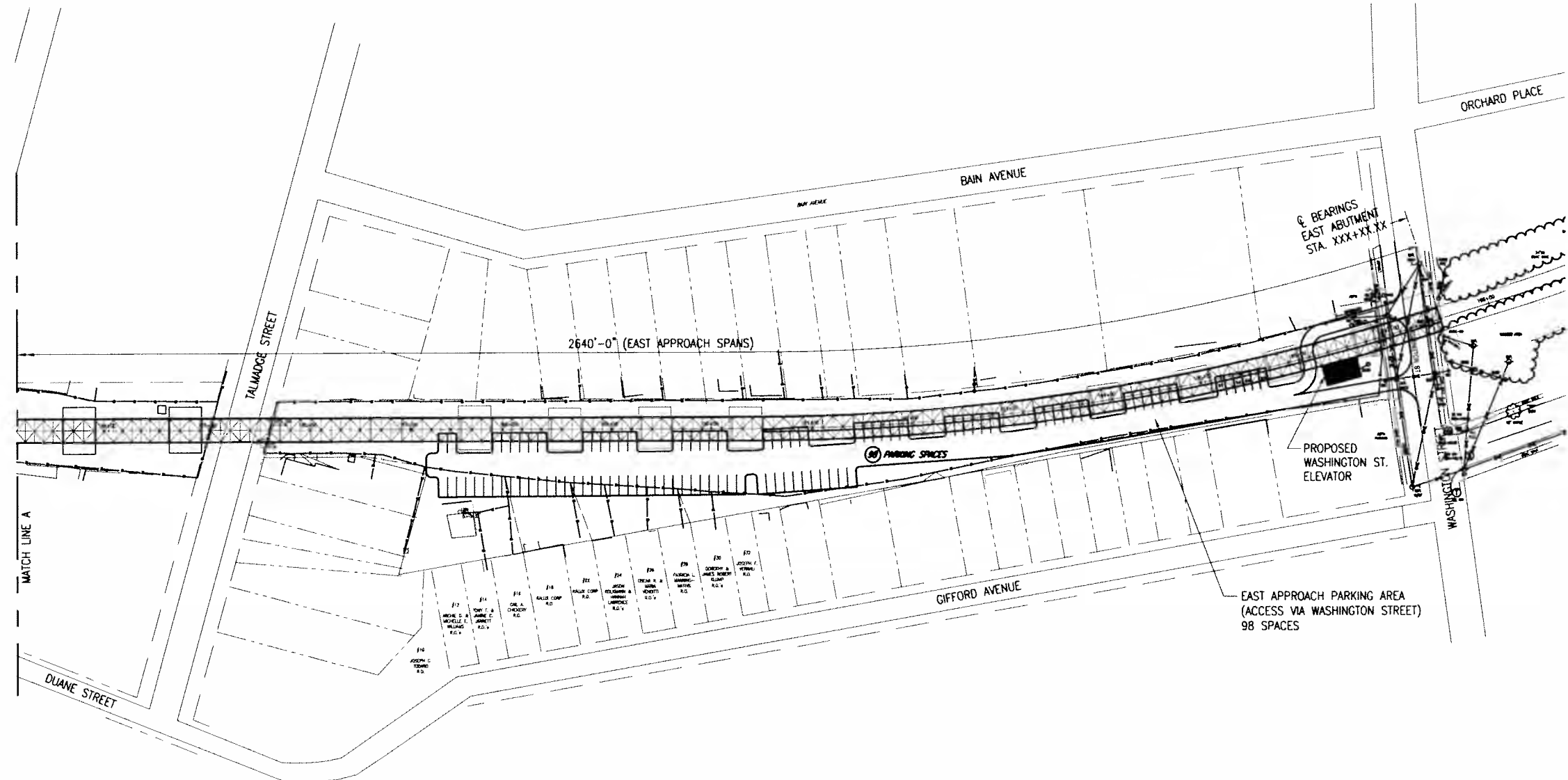

**SITE PLAN
(EAST APPROACH)**
NO SCALE

NOTES:

1. FOR THE FOLLOWING SEE: DWG. NO.
 A. XXXXXXXXXXXX XX-XX
 B. XXXXXXXXXXXX XX-XX

LEGEND:

PROPOSED ELEVATOR LOCATION



STATE OF NEW YORK
 OFFICE OF PARKS, RECREATION AND HISTORIC PRESERVATION
 EASTERN DISTRICT - TACONIC REGION
 P.O. BOX 308, 75 MILLS MANSION DRIVE
 STAATSBURG, NEW YORK 12580
 (XXX) XXX-XXXX FAX: (XXX) XXX-XXXX

WARNING:
 ANY ALTERATIONS TO THIS DOCUMENT NOT
 CONFORMING TO SECTION 1709
 SUBDIVISION 2, NEW YORK STATE EDUCATION
 LAW, ARE STRICTLY PROHIBITED.



**WALKWAY OVER THE HUDSON
 POUGHKEEPSIE - HIGHLAND
 RAILROAD BRIDGE**
**GENERAL SITE PLAN
 EAST APPROACH**

XXX DESIGNED		
XXX DRAWN		
XXX CHECKED		
AS SHOWN SCALE		
FEB. 2008 DATE	NO.	DATE
	REVISIONS	

SHEET NO. **D-3**

WARNING:
 ANY ALTERATIONS TO THIS DOCUMENT NOT
 CONFORMING TO SECTION 7209
 SUBDIVISION 2, NEW YORK STATE EDUCATION
 LAW, ARE STRICTLY PROHIBITED.



WALKWAY OVER THE HUDSON
 POUGHKEEPSIE - HIGHLAND
 RAILROAD BRIDGE

GENERAL
 PLAN AND ELEVATION - 1

XXX DESIGNED		
XXX DRAWN		
XXX CHECKED		
AS SHOWN SCALE		
FEB. 2008 DATE	NO. REVISIONS	DATE
SHEET NO.	D-4	
FILE NO. 7494_P01.DWG		

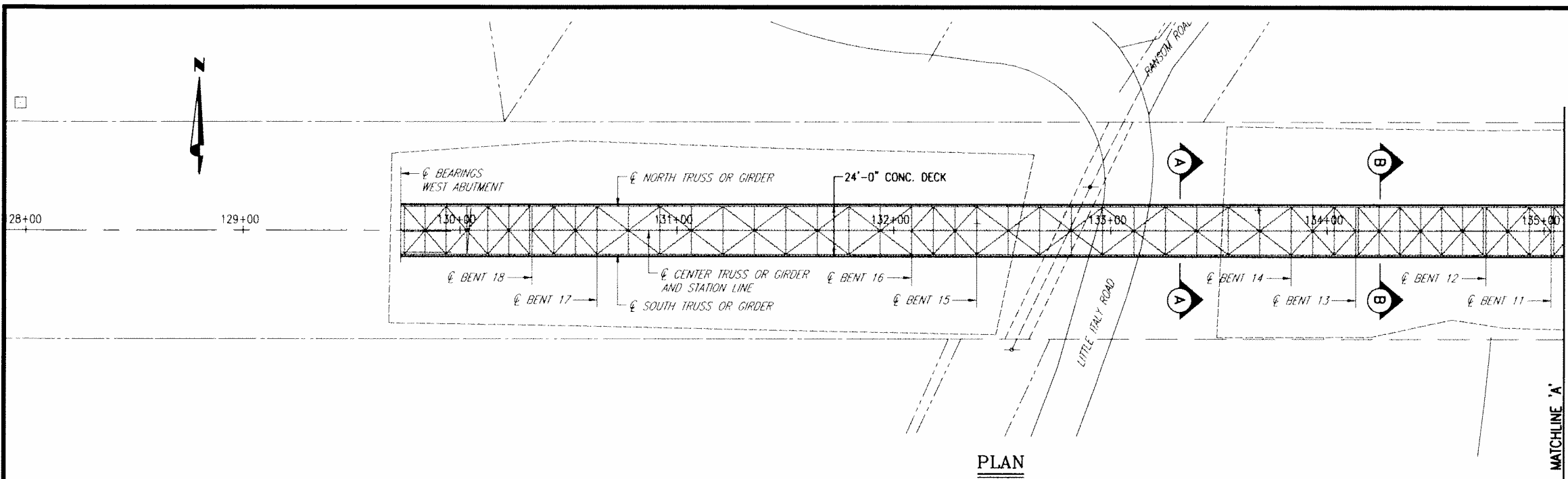

PLAN

MATCHLINE 'A'

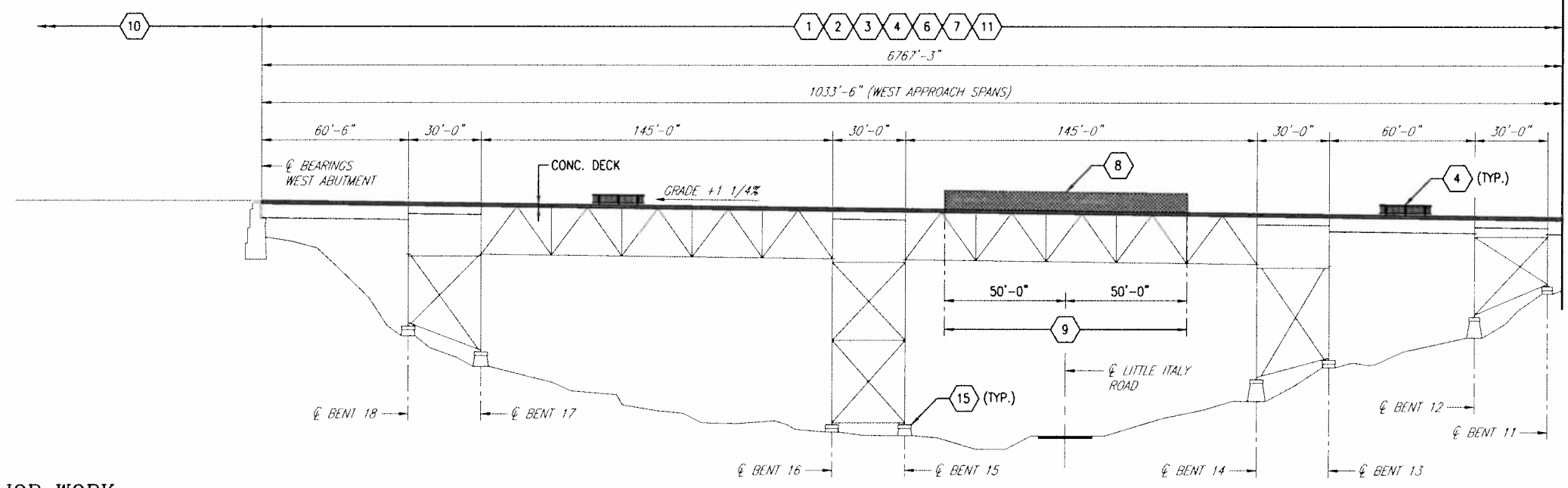

SOUTH ELEVATION
 (NORTH ELEVATION SIMILAR)

LEGEND OF MAJOR WORK:

- | | |
|--|--|
| CONTRACT #1: DEMOLITION | CONTRACT #4: GENERAL CONTRACT CON'T |
| 1 DECK REMOVAL, INCLUDING TIMBER TIES, STEEL RAILS, HAND RAILING, OPEN GRATE DECK, AND ALL OTHER ELEMENTS CONNECTED THERE TO | 10 TRAIL FEATURES |
| 2 ASBESTOS ABATEMENT | 11 LIGHTING |
| CONTRACT #2: PRE-PURCHASE DECK PANELS | 12 SECURITY FEATURES |
| 3 NEW DECK (FABRICATION) | 13 ELEVATOR & STAIR TOWER |
| CONTRACT #3: PRE-PURCHASE RAILING | 14 GLASS PANELS IN DECK |
| 4 NEW RAILING | 15 ASBESTOS ABATEMENT |
| CONTRACT #4: GENERAL CONTRACT | CONTRACT #5: MAIN SPAN PIER REPAIRS |
| 5 REMOVE ABANDONED UTILITY SUPPORT FRAMES AND POWER LINES | 16 PIER REPAIRS (MAIN SPAN) |
| 6 NEW DECK (INSTALLATION) | |
| 7 STEEL REPAIRS | |
| 8 PEDESTRIAN FENCE | |
| 9 CLOSED DRAINAGE SYSTEM | |

NOTES:

- FOR THE FOLLOWING SEE:
 A. XXXXXXXXXXXXX
 B. XXXXXXXXXXXXX

DWG. NO.
 XX-XX
 XX-XX

LEGEND:

- 1 INDICATES WORK ITEMS
- INDICATES NEW CONCRETE DECK

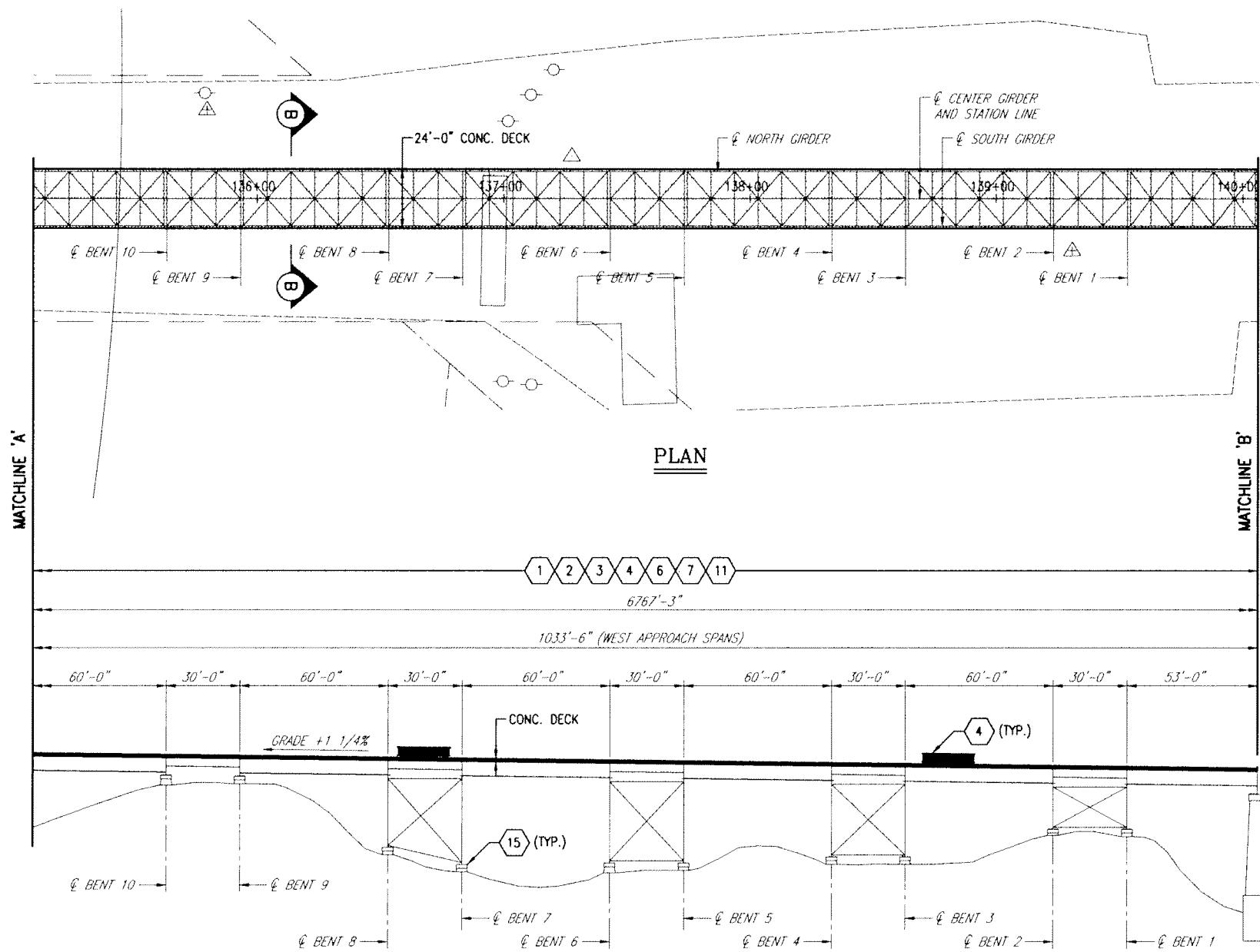

LEGEND OF MAJOR WORK:

CONTRACT #1: DEMOLITION

- ① DECK REMOVAL, INCLUDING TIMBER TIES, STEEL RAILS, HAND RAILING, OPEN GRATE DECK, AND ALL OTHER ELEMENTS CONNECTED THERE TO
- ② ASBESTOS ABATEMENT

CONTRACT #2: PRE-PURCHASE DECK PANELS

- ③ NEW DECK (FABRICATION)

CONTRACT #3: PRE-PURCHASE RAILING

- ④ NEW RAILING

CONTRACT #4: GENERAL CONTRACT

- ⑤ REMOVE ABANDONED UTILITY SUPPORT FRAMES AND POWER LINES
- ⑥ NEW DECK (INSTALLATION)
- ⑦ STEEL REPAIRS
- ⑧ PEDESTRIAN FENCE
- ⑨ CLOSED DRAINAGE SYSTEM

CONTRACT #4: GENERAL CONTRACT CONT

- ⑩ TRAIL FEATURES
- ⑪ LIGHTING
- ⑫ SECURITY FEATURES
- ⑬ ELEVATOR & STAIR TOWER
- ⑭ GLASS PANELS IN DECK
- ⑮ ASBESTOS ABATEMENT

CONTRACT #5: MAIN SPAN PIER REPAIRS

- ⑯ PIER REPAIRS (MAIN SPAN)

SOUTH ELEVATION

(NORTH ELEVATION SIMILAR)

NOTES:

- 1. FOR THE FOLLOWING SEE:
A. XXXXXXXXXXXXX
B. XXXXXXXXXXXXX

DWG. NO.
XX-XX
XX-XX

LEGEND:

- ① INDICATES WORK ITEMS
- ▭ INDICATES NEW CONCRETE DECK



STATE OF NEW YORK
OFFICE OF PARKS, RECREATION AND HISTORIC PRESERVATION
EASTERN DISTRICT - TACONIC REGION
P.O. BOX 308, 75 MILLS MANSION DRIVE
STAATSBURG, NEW YORK 12580
(XXX) XXX-XXXX FAX: (XXX) XXX-XXXX

WARNING:
ANY ALTERATIONS TO THIS DOCUMENT NOT
CONFORMING TO SECTION 7206
SUBDIVISION 2, NEW YORK STATE EDUCATION
LAW, ARE STRICTLY PROHIBITED.



WALKWAY OVER THE HUDSON
POUGHKEEPSIE - HIGHLAND
RAILROAD BRIDGE
GENERAL
PLAN AND ELEVATION - 2

XXX DESIGNED		
XXX DRAWN		
XXX CHECKED		
AS SHOWN SCALE		
FEB 2008 DATE	NO. REVISIONS	DATE
SHEET NO. D-5		
FILE NO. 7494_PER.DWG		

WARNING:
 ANY ALTERATIONS TO THIS DOCUMENT NOT
 CONFORMING TO SECTION 7209
 SUBSECTION 2, NEW YORK STATE EDUCATION
 LAW, ARE STRICTLY PROHIBITED.



WALKWAY OVER THE HUDSON
 POUGHKEEPSIE - HIGHLAND
 RAILROAD BRIDGE
 GENERAL
 PLAN AND ELEVATION - 3

XXX DESIGNED	
XXX DRAWN	
XXX CHECKED	
AS SHOWN SCALE	
FEB. 2008 DATE	NO. DATE REVISIONS

SHEET NO. D-6

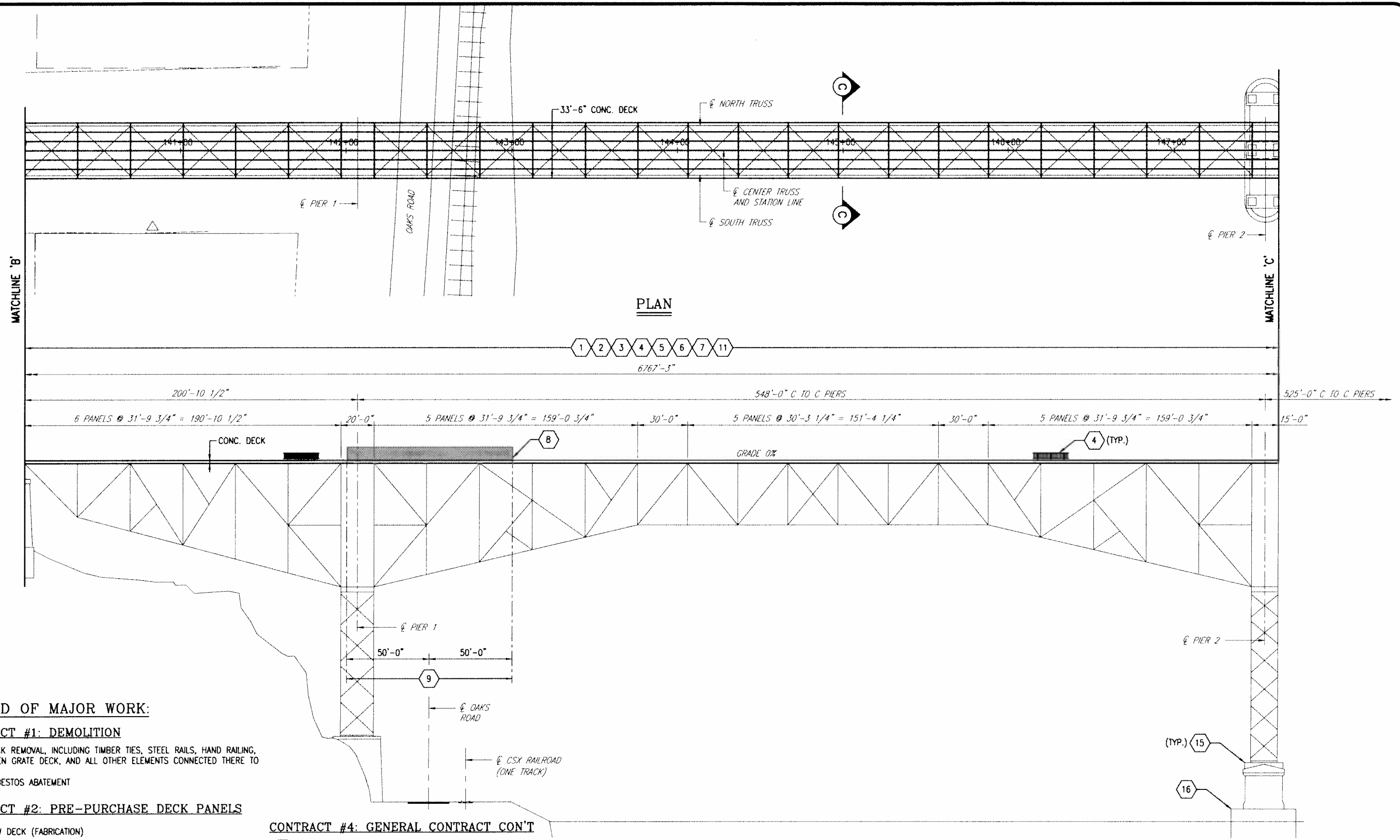

LEGEND OF MAJOR WORK:

CONTRACT #1: DEMOLITION

- 1 DECK REMOVAL, INCLUDING TIMBER TIES, STEEL RAILS, HAND RAILING, OPEN GRATE DECK, AND ALL OTHER ELEMENTS CONNECTED THERE TO
- 2 ASBESTOS ABATEMENT

CONTRACT #2: PRE-PURCHASE DECK PANELS

- 3 NEW DECK (FABRICATION)

CONTRACT #3: PRE-PURCHASE RAILING

- 4 NEW RAILING

CONTRACT #4: GENERAL CONTRACT

- 5 REMOVE ABANDONED UTILITY SUPPORT FRAMES AND POWER LINES
- 6 NEW DECK (INSTALLATION)
- 7 STEEL REPAIRS
- 8 PEDESTRIAN FENCE
- 9 CLOSED DRAINAGE SYSTEM

CONTRACT #4: GENERAL CONTRACT CON'T

- 10 TRAIL FEATURES
- 11 LIGHTING
- 12 SECURITY FEATURES
- 13 ELEVATOR & STAIR TOWER
- 14 GLASS PANELS IN DECK
- 15 ASBESTOS ABATEMENT

CONTRACT #5: MAIN SPAN PIER REPAIRS

- 16 PIER REPAIRS (MAIN SPAN)

SOUTH ELEVATION
 (NORTH ELEVATION SIMILAR)

NOTES:

- 1. FOR THE FOLLOWING SEE:
 A. XXXXXXXXXXXXX
 B. XXXXXXXXXXXXX

DWG. NO.
 XX-XX
 XX-XX

LEGEND:

- 1 INDICATES WORK ITEMS
- [] INDICATES NEW CONCRETE DECK

WARNING:
 ANY ALTERATIONS TO THIS DOCUMENT NOT
 CONFORMING TO SECTION 1709
 SUBDIVISION 2, NEW YORK STATE EDUCATION
 LAW, ARE STRICTLY PROHIBITED



WALKWAY OVER THE HUDSON
 POUGHKEEPSIE - HIGHLAND
 RAILROAD BRIDGE
 GENERAL
 PLAN AND ELEVATION - 4

DESIGNED	XXX		
DRAWN	XXX		
CHECKED	XXX		
AS SHOWN			
SCALE			
FEB. 2008	NO.	DATE	
DATE		REVISIONS	
SHEET NO.	D-7		
FILE NO.	7494_PE4.DWG		

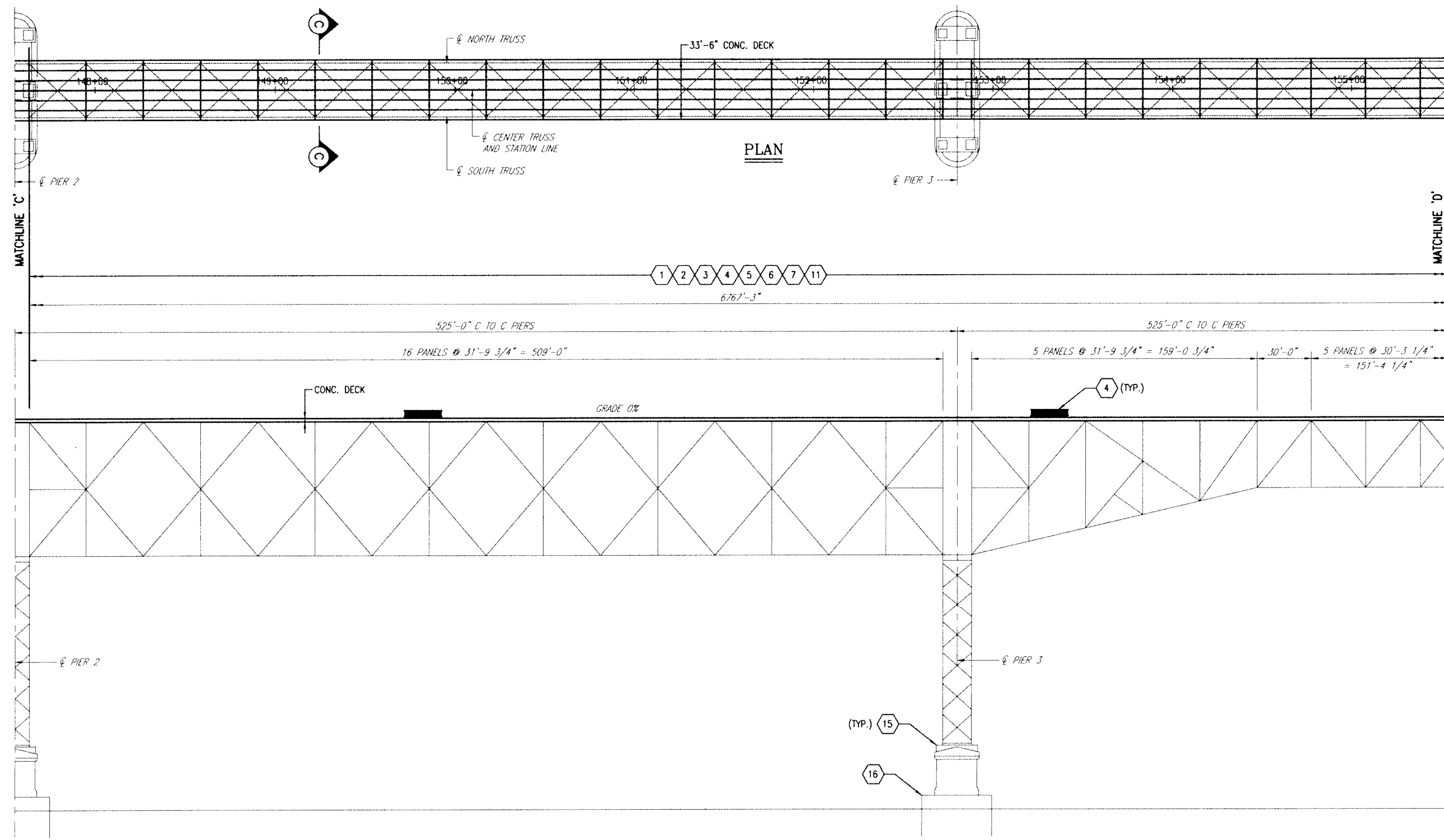

- LEGEND OF MAJOR WORK:**
- CONTRACT #1: DEMOLITION**
- 1 DECK REMOVAL, INCLUDING TIMBER TIES, STEEL RAILS, HAND RAILING, OPEN GRATE DECK, AND ALL OTHER ELEMENTS CONNECTED THERE TO
 - 2 ASBESTOS ABATEMENT
- CONTRACT #2: PRE-PURCHASE DECK PANELS**
- 3 NEW DECK (FABRICATION)
- CONTRACT #3: PRE-PURCHASE RAILING**
- 4 NEW RAILING
- CONTRACT #4: GENERAL CONTRACT**
- 5 REMOVE ABANDONED UTILITY SUPPORT FRAMES AND POWER LINES

- CONTRACT #4: GENERAL CONTRACT CONT'**
- 6 NEW DECK (INSTALLATION)
 - 7 STEEL REPAIRS
 - 8 PEDESTRIAN FENCE
 - 9 CLOSED DRAINAGE SYSTEM
 - 10 TRAIL FEATURES
 - 11 LIGHTING
 - 12 SECURITY FEATURES
 - 13 ELEVATOR & STAIR TOWER
 - 14 GLASS PANELS IN DECK
 - 15 ASBESTOS ABATEMENT
- CONTRACT #5: MAIN SPAN PIER REPAIRS**
- 16 PIER REPAIRS (MAIN SPAN)

SOUTH ELEVATION
 (NORTH ELEVATION SIMILAR)

NOTES:

1. FOR THE FOLLOWING SEE:
 A. XXXXXXXXXXXXX
 B. XXXXXXXXXXXXX

DWG. NO.
 XX-XX
 XX-XX

- LEGEND:**
- 1 INDICATES WORK ITEMS
 - INDICATES NEW CONCRETE DECK

WARNING:
 ANY ALTERATIONS TO THIS DOCUMENT NOT
 CONFORMING TO SECTION 7236
 SUBDIVISION 2, NEW YORK STATE EDUCATION
 LAW, ARE STRICTLY PROHIBITED.



WALKWAY OVER THE HUDSON
 POUGHKEEPSIE - HIGHLAND
 RAILROAD BRIDGE

GENERAL
 PLAN AND ELEVATION - 5

XXX DESIGNED		
XXX DRAWN		
XXX CHECKED		
AS SHOWN SCALE		
FEB. 2008 DATE	NO. REVISIONS	DATE
SHEET NO.	D-8	
FILE NO. 7494_PES.DWG		

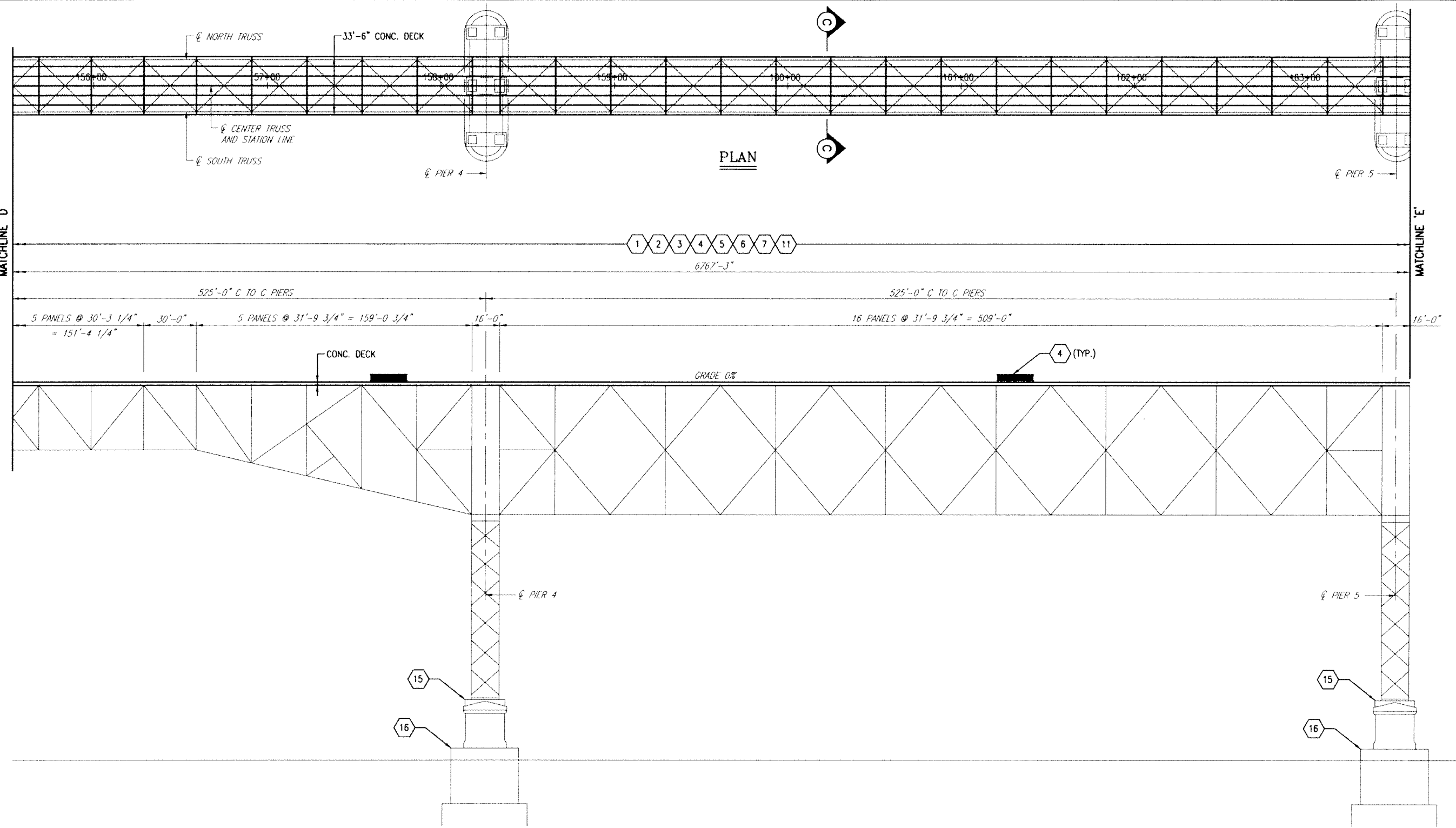

LEGEND OF MAJOR WORK:

CONTRACT #1: DEMOLITION

- ① DECK REMOVAL, INCLUDING TIMBER TIES, STEEL RAILS, HAND RAILING, OPEN GRATE DECK, AND ALL OTHER ELEMENTS CONNECTED THERE TO
- ② ASBESTOS ABATEMENT

CONTRACT #2: PRE-PURCHASE DECK PANELS

- ③ NEW DECK (FABRICATION)

CONTRACT #3: PRE-PURCHASE RAILING

- ④ NEW RAILING

CONTRACT #4: GENERAL CONTRACT

- ⑤ REMOVE ABANDONED UTILITY SUPPORT FRAMES AND POWER LINES
- ⑥ NEW DECK (INSTALLATION)
- ⑦ STEEL REPAIRS
- ⑧ PEDESTRIAN FENCE
- ⑨ CLOSED DRAINAGE SYSTEM
- ⑩ TRAIL FEATURES
- ⑪ LIGHTING
- ⑫ SECURITY FEATURES
- ⑬ ELEVATOR & STAIR TOWER
- ⑭ GLASS PANELS IN DECK
- ⑮ ASBESTOS ABATEMENT

CONTRACT #5: MAIN SPAN PIER REPAIRS

- ⑯ PIER REPAIRS (MAIN SPAN)

SOUTH ELEVATION
 (NORTH ELEVATION SIMILAR)

NOTES:

- 1. FOR THE FOLLOWING SEE:
 A. XXXXXXXXXXXX
 B. XXXXXXXXXXXX

DWG. NO.
 XX-XX
 XX-XX

LEGEND:

- ① INDICATES WORK ITEMS
- ▭ INDICATES NEW CONCRETE DECK

WARNING:
 ANY ALTERATIONS TO THIS DOCUMENT NOT
 CONFORMING TO SECTION 7006
 SUBDIVISION 2, NEW YORK STATE EDUCATION
 LAW, ARE STRICTLY PROHIBITED.



WALKWAY OVER THE HUDSON
 POUGHKEEPSIE - HIGHLAND
 RAILROAD BRIDGE
 GENERAL
 PLAN AND ELEVATION - 6

XXX DESIGNED		
XXX DRAWN		
XXX CHECKED		
AS SHOWN SCALE		
FEB. 2008 DATE	NO.	DATE
	REVISIONS	
SHEET NO.	D-9	
FILE NO. 7494_P28.DWG		

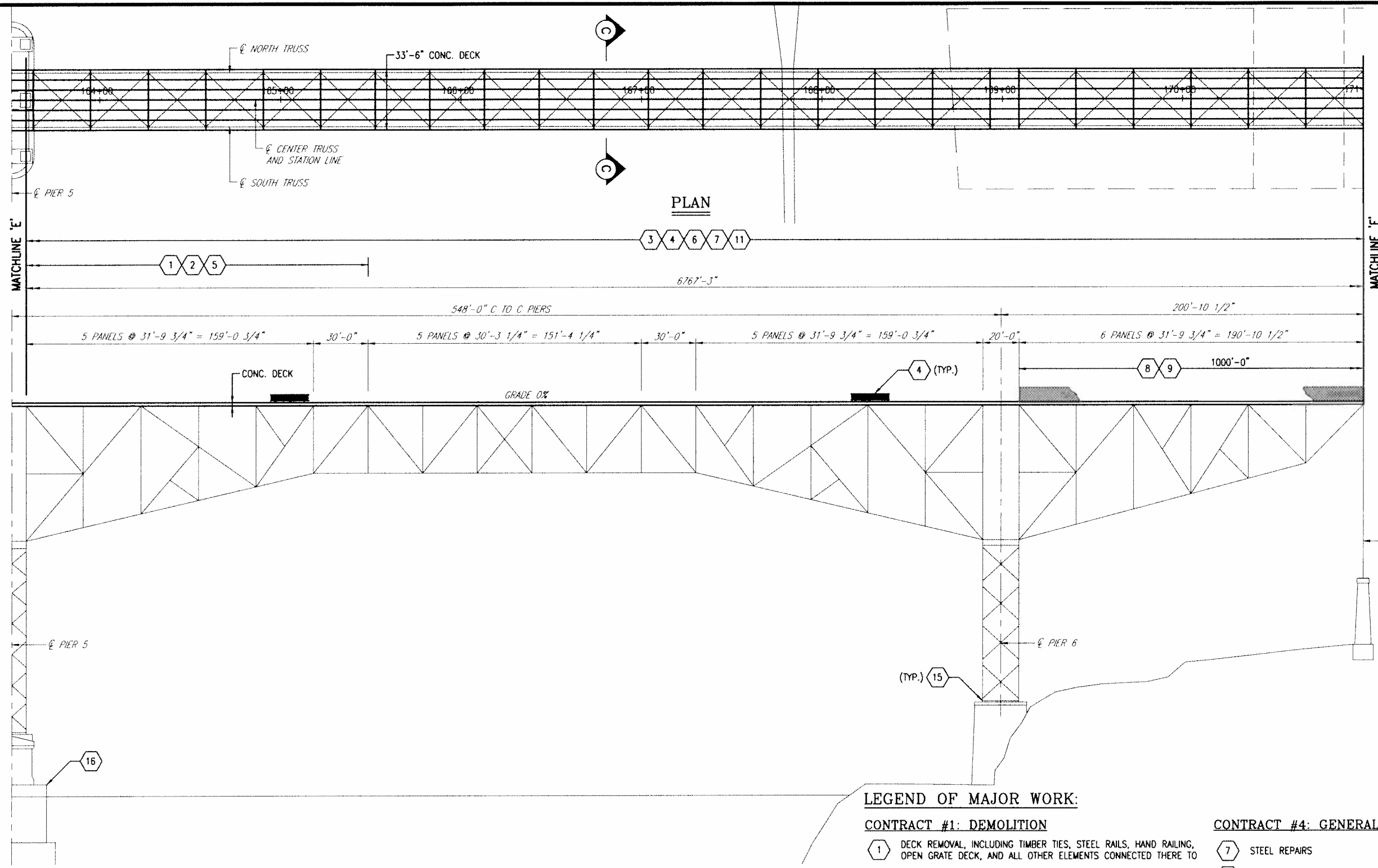

NOTES:
 1. FOR THE FOLLOWING SEE:
 A. XXXXXXXXXXXX
 B. XXXXXXXXXXXX
 DWG. NO.
 XX-XX
 XX-XX

LEGEND:
 1 INDICATES WORK ITEMS
 [] INDICATES NEW CONCRETE DECK

SOUTH ELEVATION
 (NORTH ELEVATION SIMILAR)

LEGEND OF MAJOR WORK:

CONTRACT #1: DEMOLITION

- 1 DECK REMOVAL, INCLUDING TIMBER TIES, STEEL RAILS, HAND RAILING, OPEN GRATE DECK, AND ALL OTHER ELEMENTS CONNECTED THERE TO
- 2 ASBESTOS ABATEMENT

CONTRACT #2: PRE-PURCHASE DECK PANELS

- 3 NEW DECK (FABRICATION)

CONTRACT #3: PRE-PURCHASE RAILING

- 4 NEW RAILING

CONTRACT #4: GENERAL CONTRACT

- 5 REMOVE ABANDONED UTILITY SUPPORT FRAMES AND POWER LINES
- 6 NEW DECK (INSTALLATION)

CONTRACT #4: GENERAL CONTRACT CON'T

- 7 STEEL REPAIRS
- 8 PEDESTRIAN FENCE
- 9 CLOSED DRAINAGE SYSTEM
- 10 TRAIL FEATURES
- 11 LIGHTING
- 12 SECURITY FEATURES
- 13 ELEVATOR & STAIR TOWER
- 14 GLASS PANELS IN DECK
- 15 ASBESTOS ABATEMENT

CONTRACT #5: MAIN SPAN PIER REPAIRS

- 16 PIER REPAIRS (MAIN SPAN)

WARNING:
 ANY ALTERATIONS TO THIS DOCUMENT NOT
 CONFORMING TO SECTION 1206,
 SUBDIVISION 2, NEW YORK STATE EDUCATION
 LAW, ARE STRICTLY PROHIBITED.



WALKWAY OVER THE HUDSON
 POUGHKEEPSIE - HIGHLAND
 RAILROAD BRIDGE
 GENERAL
 PLAN AND ELEVATION - 7

XXX DESIGNED		
XXX DRAWN		
XXX CHECKED		
AS SHOWN SCALE		
FEB 2008 DATE	NO. REVISIONS	DATE
SHEET NO. D-10		
FILE NO. 7494_PE7.DWG		

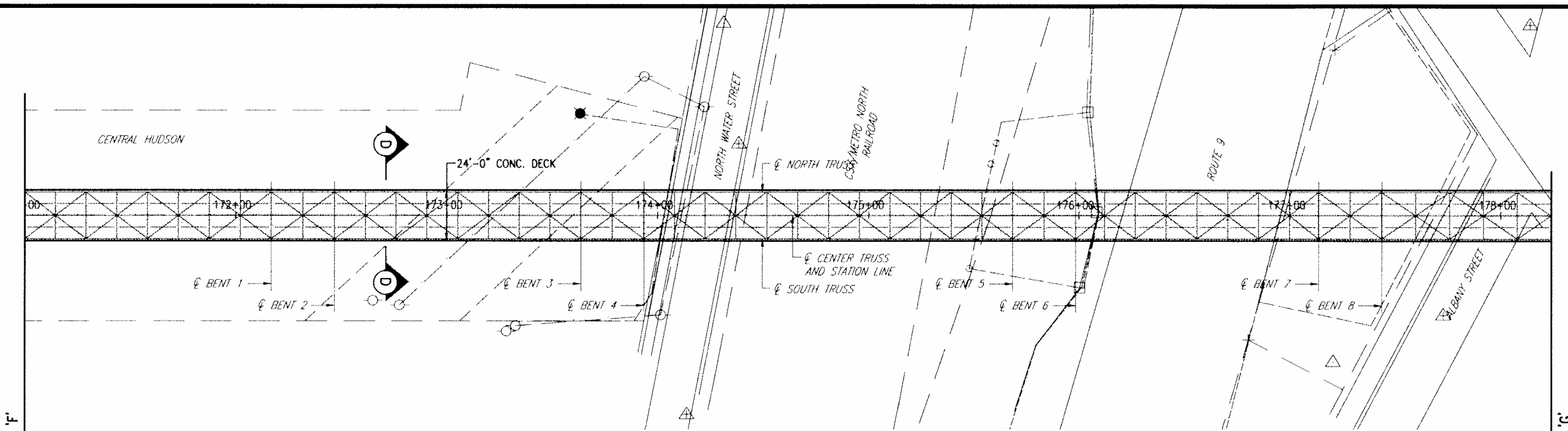

PLAN

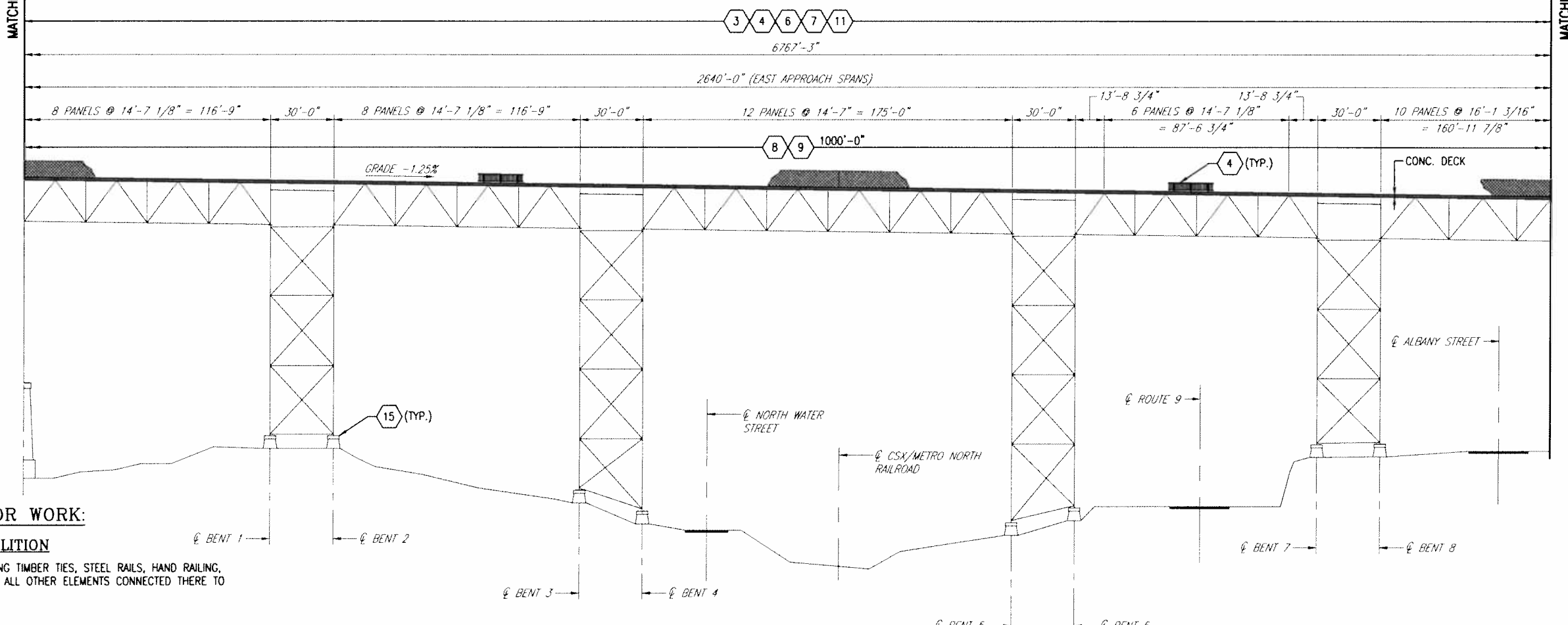

SOUTH ELEVATION
 (NORTH ELEVATION SIMILAR)

LEGEND OF MAJOR WORK:

CONTRACT #1: DEMOLITION

- 1 DECK REMOVAL, INCLUDING TIMBER TIES, STEEL RAILS, HAND RAILING, OPEN GRATE DECK, AND ALL OTHER ELEMENTS CONNECTED THERE TO
- 2 ASBESTOS ABATEMENT

CONTRACT #2: PRE-PURCHASE DECK PANELS

- 3 NEW DECK (FABRICATION)

CONTRACT #3: PRE-PURCHASE RAILING

- 4 NEW RAILING

CONTRACT #4: GENERAL CONTRACT

- 5 REMOVE ABANDONED UTILITY SUPPORT FRAMES AND POWER LINES
- 6 NEW DECK (INSTALLATION)
- 7 STEEL REPAIRS

CONTRACT #4: GENERAL CONTRACT CON'T:

- 8 PEDESTRIAN FENCE
- 9 CLOSED DRAINAGE SYSTEM
- 10 TRAIL FEATURES
- 11 LIGHTING
- 12 SECURITY FEATURES
- 13 ELEVATOR & STAIR TOWER
- 14 GLASS PANELS IN DECK
- 15 ASBESTOS ABATEMENT

CONTRACT #5: MAIN SPAN PIER REPAIRS

- 16 PIER REPAIRS (MAIN SPAN)

NOTES:

- 1. FOR THE FOLLOWING SEE:
 A. XXXXXXXXXXXXX
 B. XXXXXXXXXXXXX

DWG. NO.
 XX-XX
 XX-XX

LEGEND:

- 1 INDICATES WORK ITEMS
- INDICATES NEW CONCRETE DECK

WARNING:
 ANY ALTERATIONS TO THIS DOCUMENT NOT
 CONFORMING TO SECTION 2200,
 SUBDIVISION 2, NEW YORK STATE EDUCATION
 LAW, ARE STRICTLY PROHIBITED.



WALKWAY OVER THE HUDSON
 POUGHKEEPSIE - HIGHLAND
 RAILROAD BRIDGE

GENERAL
 PLAN AND ELEVATION - 8

XXX DESIGNED		
XXX DRAWN		
XXX CHECKED		
AS SHOWN SCALE		
FEB. 2008 DATE	NO. DATE	REVISIONS
SHEET NO.	D-11	
FILE NO. 7494_PEB.DWG		

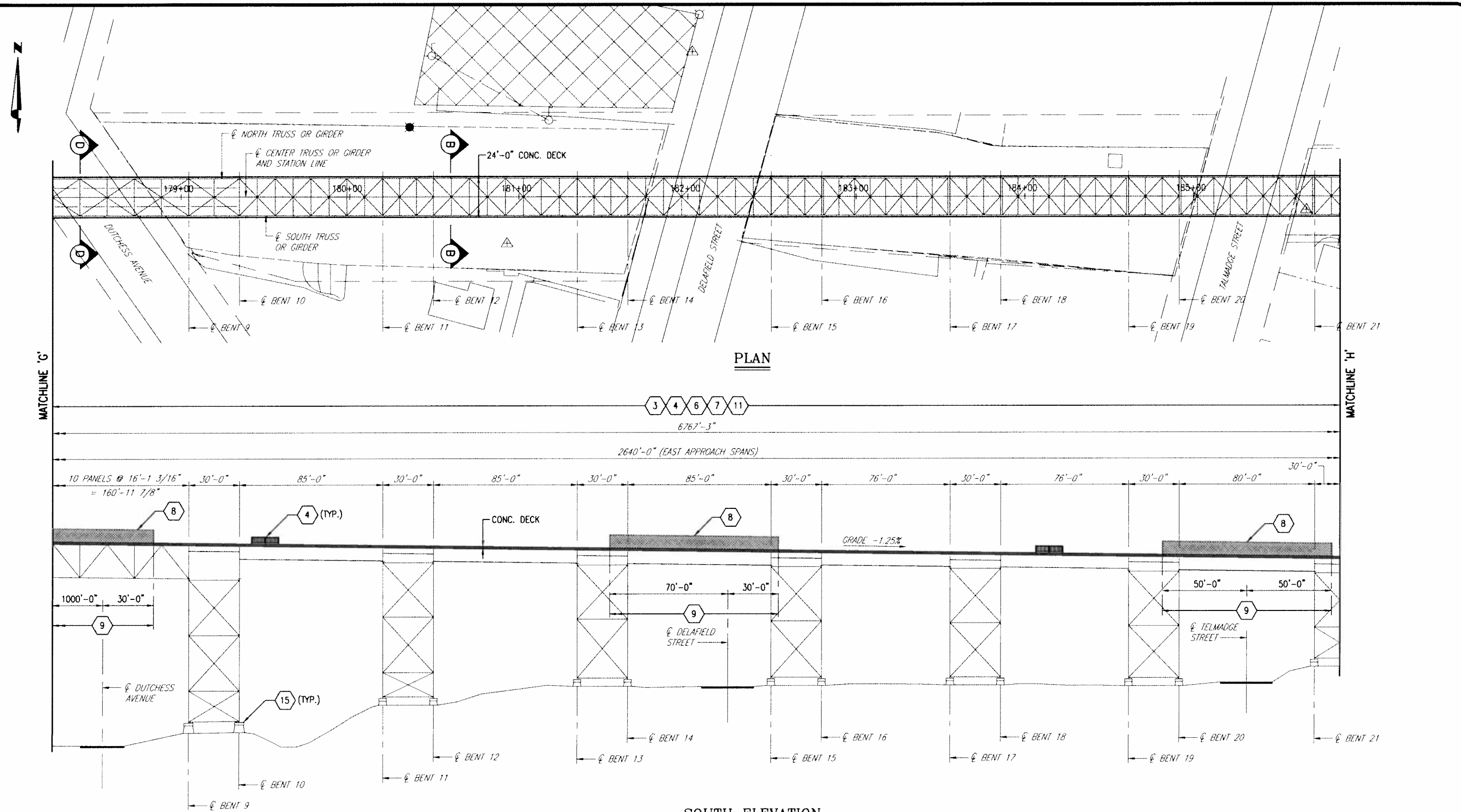

PLAN

SOUTH ELEVATION
 (NORTH ELEVATION SIMILAR)

LEGEND OF MAJOR WORK:

CONTRACT #1: DEMOLITION

- 1 DECK REMOVAL, INCLUDING TIMBER TIES, STEEL RAILS, HAND RAILING, OPEN GRATE DECK, AND ALL OTHER ELEMENTS CONNECTED THERE TO
- 2 ASBESTOS ABATEMENT

CONTRACT #2: PRE-PURCHASE DECK PANELS

- 3 NEW DECK (FABRICATION)

CONTRACT #3: PRE-PURCHASE RAILING

- 4 NEW RAILING

CONTRACT #4: GENERAL CONTRACT

- 5 REMOVE ABANDONED UTILITY SUPPORT FRAMES AND POWER LINES
- 6 NEW DECK (INSTALLATION)
- 7 STEEL REPAIRS
- 8 PEDESTRIAN FENCE
- 9 CLOSED DRAINAGE SYSTEM
- 10 TRAIL FEATURES
- 11 LIGHTING
- 12 SECURITY FEATURES
- 13 ELEVATOR & STAIR TOWER
- 14 GLASS PANELS IN DECK
- 15 ASBESTOS ABATEMENT

CONTRACT #5: MAIN SPAN PIER REPAIRS

- 16 PIER REPAIRS (MAIN SPAN)

NOTES:

- 1. FOR THE FOLLOWING SEE:
 A. XXXXXXXXXXXXX
 B. XXXXXXXXXXXXX

DWG. NO.
 XX-XX
 XX-XX

LEGEND:

- 1 INDICATES WORK ITEMS
- [] INDICATES NEW CONCRETE DECK

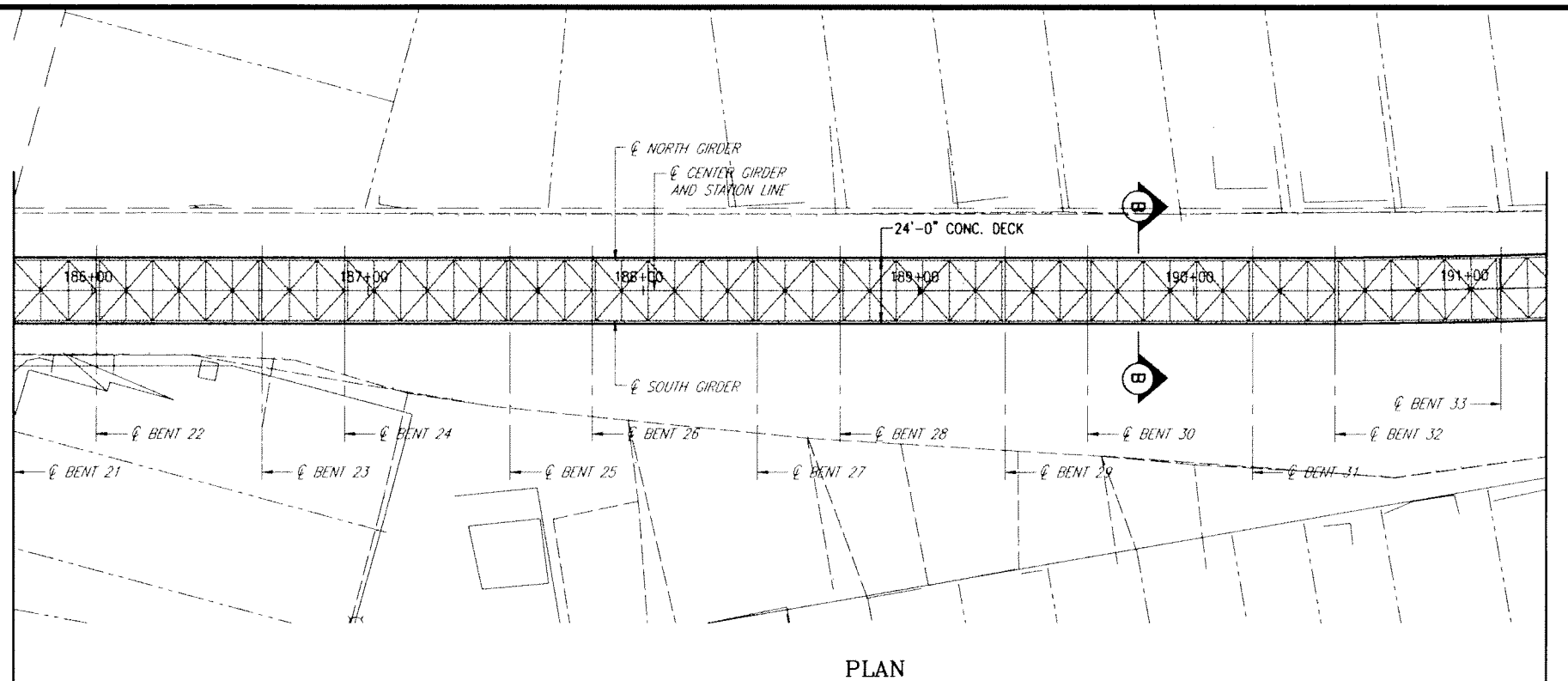

PLAN

MATCHLINE 'H'

MATCHLINE 'I'

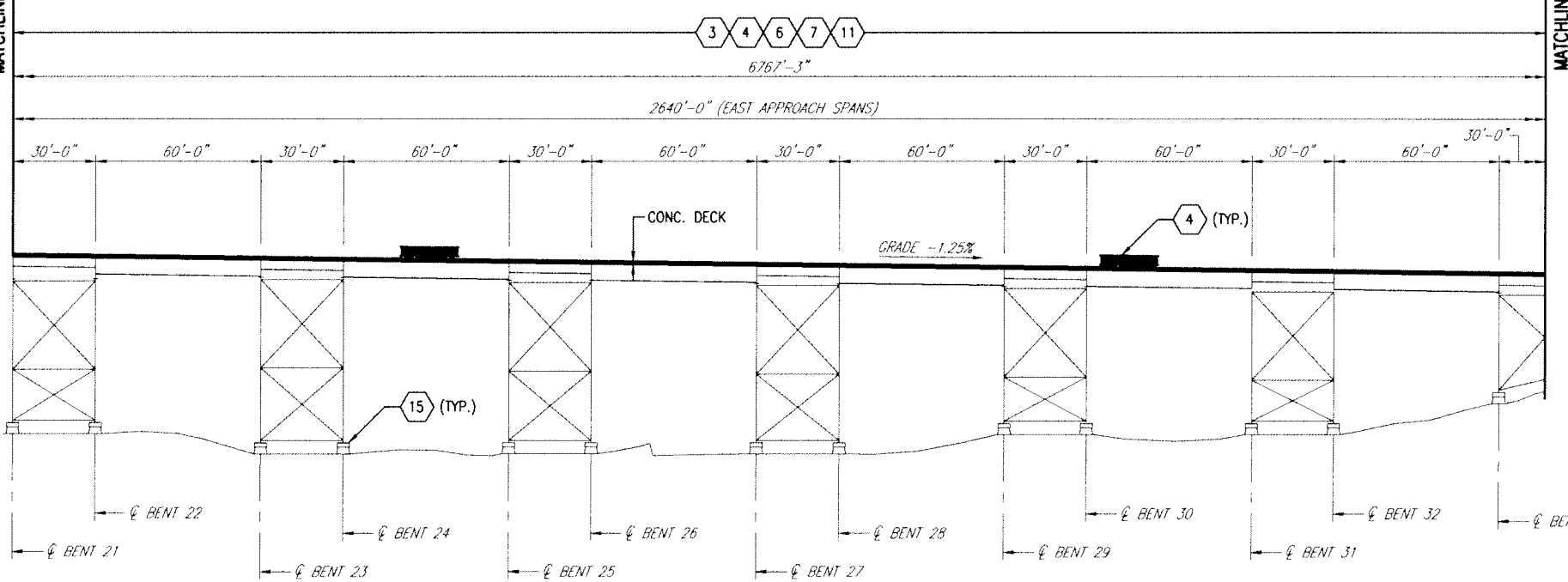

SOUTH ELEVATION

(NORTH ELEVATION SIMILAR)

LEGEND OF MAJOR WORK:

CONTRACT #1: DEMOLITION

- 1 DECK REMOVAL, INCLUDING TIMBER TIES, STEEL RAILS, HAND RAILING, OPEN GRATE DECK, AND ALL OTHER ELEMENTS CONNECTED THERE TO
- 2 ASBESTOS ABATEMENT

CONTRACT #2: PRE-PURCHASE DECK PANELS

- 3 NEW DECK (FABRICATION)

CONTRACT #3: PRE-PURCHASE RAILING

- 4 NEW RAILING

CONTRACT #4: GENERAL CONTRACT

- 5 REMOVE ABANDONED UTILITY SUPPORT FRAMES AND POWER LINES
- 6 NEW DECK (INSTALLATION)
- 7 STEEL REPAIRS

CONTRACT #4: GENERAL CONTRACT CONT'

- 8 PEDESTRIAN FENCE
- 9 CLOSED DRAINAGE SYSTEM
- 10 TRAIL FEATURES
- 11 LIGHTING
- 12 SECURITY FEATURES
- 13 ELEVATOR & STAIR TOWER
- 14 GLASS PANELS IN DECK
- 15 ASBESTOS ABATEMENT

CONTRACT #5: MAIN SPAN PIER REPAIRS

- 16 PIER REPAIRS (MAIN SPAN)

NOTES:

- 1. FOR THE FOLLOWING SEE:
A. XXXXXXXXXXXX
B. XXXXXXXXXXXX

DWG. NO.
XX-XX
XX-XX

LEGEND:

- 1 INDICATES WORK ITEMS
- [] INDICATES NEW CONCRETE DECK



STATE OF NEW YORK
OFFICE OF PARKS, RECREATION AND HISTORIC PRESERVATION
EASTERN DISTRICT - TACONIC REGION
P.O. BOX 308, 75 MILLS MANSION DRIVE
STAATSBURG, NEW YORK 12580
(XXX) XXX-XXXX FAX: (XXX) XXX-XXXX

WARNING:
ANY ALTERATIONS TO THIS DOCUMENT NOT
CONFORMING TO SECTION 7209
SUBDIVISION 2, NEW YORK STATE EDUCATION
LAW, ARE STRICTLY PROHIBITED.



**WALKWAY OVER THE HUDSON
POUGHKEEPSIE - HIGHLAND
RAILROAD BRIDGE**

**GENERAL
PLAN AND ELEVATION - 9**

XXX DESIGNED		
XXX DRAWN		
XXX CHECKED		
AS SHOWN SCALE		
FEB. 2008 DATE	NO. DATE	REVISIONS
SHEET NO. D-12		
FILE NO. 7494_P69.DWG		

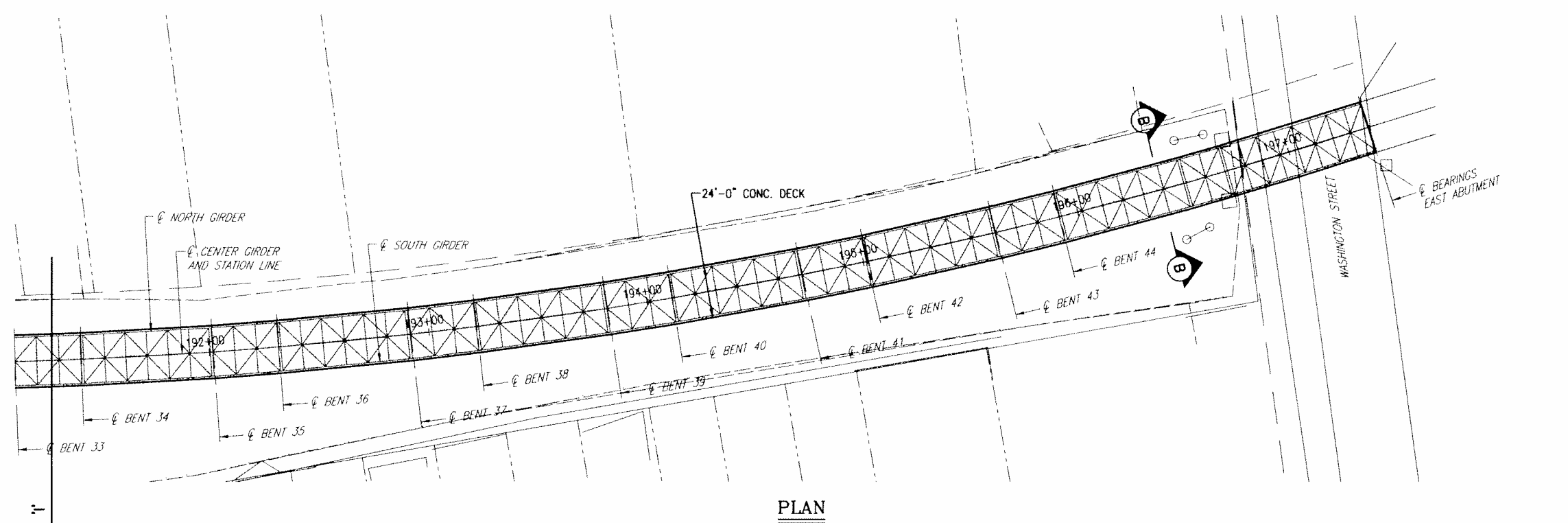

PLAN

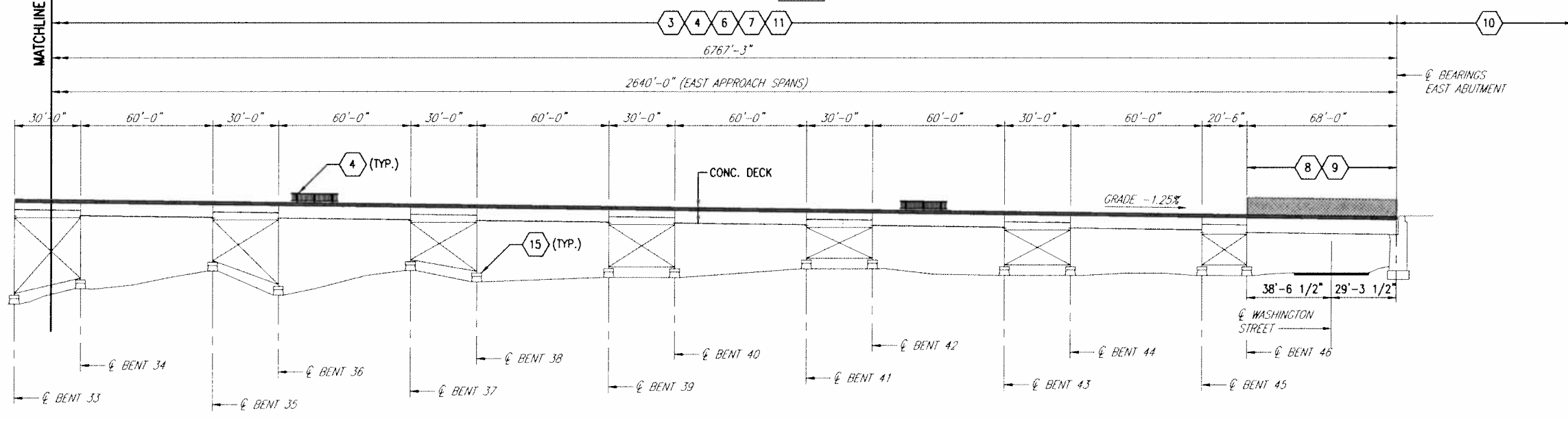

SOUTH ELEVATION
(NORTH ELEVATION SIMILAR)

LEGEND OF MAJOR WORK:

CONTRACT #1: DEMOLITION

- 1 DECK REMOVAL, INCLUDING TIMBER TIES, STEEL RAILS, HAND RAILING, OPEN GRATE DECK, AND ALL OTHER ELEMENTS CONNECTED THERE TO
- 2 ASBESTOS ABATEMENT

CONTRACT #2: PRE-PURCHASE DECK PANELS

- 3 NEW DECK (FABRICATION)

CONTRACT #3: PRE-PURCHASE RAILING

- 4 NEW RAILING

CONTRACT #4: GENERAL CONTRACT

- 5 REMOVE ABANDONED UTILITY SUPPORT FRAMES AND POWER LINES
- 6 NEW DECK (INSTALLATION)
- 7 STEEL REPAIRS
- 8 PEDESTRIAN FENCE
- 9 CLOSED DRAINAGE SYSTEM
- 10 TRAIL FEATURES
- 11 LIGHTING
- 12 SECURITY FEATURES
- 13 ELEVATOR & STAIR TOWER
- 14 GLASS PANELS IN DECK
- 15 ASBESTOS ABATEMENT

CONTRACT #5: MAIN SPAN PIER REPAIRS

- 16 PIER REPAIRS (MAIN SPAN)

NOTES:

- 1. FOR THE FOLLOWING SEE:
A. XXXXXXXXXXXXX
B. XXXXXXXXXXXXX

LEGEND:

- 1 INDICATES WORK ITEMS
- [] INDICATES NEW CONCRETE DECK



STATE OF NEW YORK
OFFICE OF PARKS, RECREATION AND HISTORIC PRESERVATION
EASTERN DISTRICT - TACONIC REGION
P.O. BOX 308, 75 MILLS MANSION DRIVE
STAATSBURG, NEW YORK 12580
(XXX) XXX-XXXX FAX: (XXX) XXX-XXXX

WARNING:
ANY ALTERATIONS TO THIS DOCUMENT NOT
CONFORMING TO SECTION 7209
SUBDIVISION 2, NEW YORK STATE EDUCATION
LAW, ARE STRICTLY PROHIBITED.



WALKWAY OVER THE HUDSON
POUGHKEEPSIE - HIGHLAND
RAILROAD BRIDGE
GENERAL
PLAN AND ELEVATION - 10

XXX DESIGNED		
XXX DRAWN		
XXX CHECKED		
AS SHOWN SCALE		
FEB. 2008	NO.	DATE
DATE	REVISIONS	
SHEET NO.	D-13	
FILE NO. 7494_PE10.DWG		

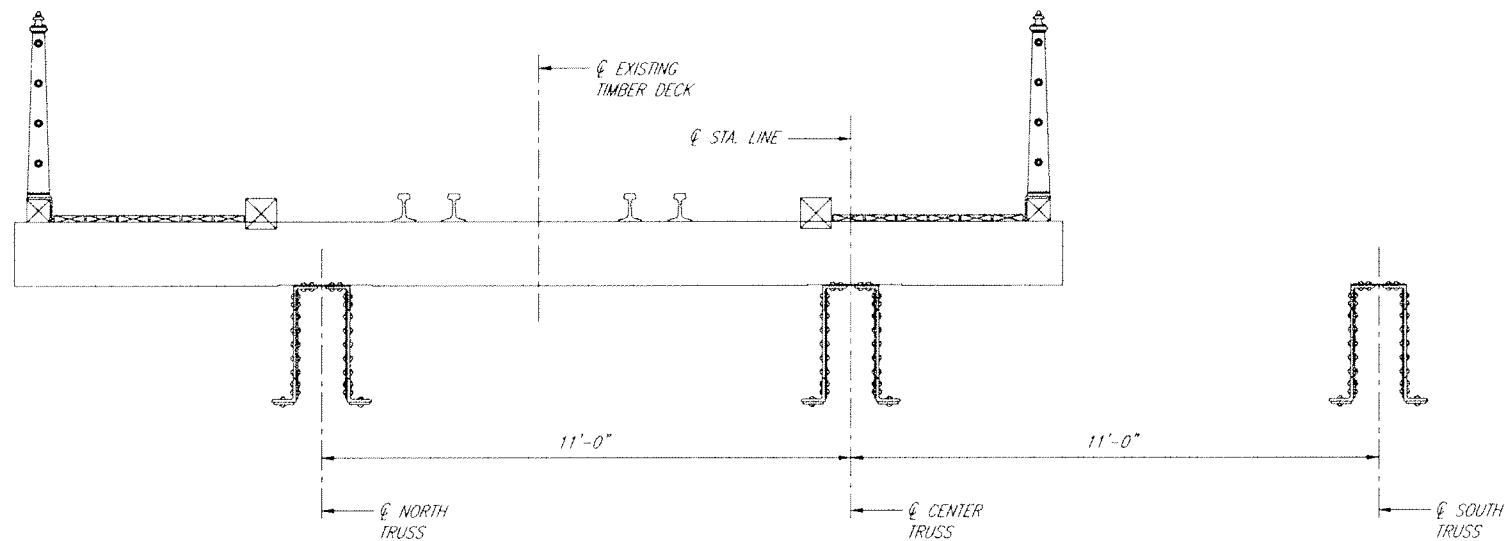

EXISTING SECTION A-A
(TRUSS SPAN - WEST APPROACH)
 SCALE: 1/2"=1'-0"

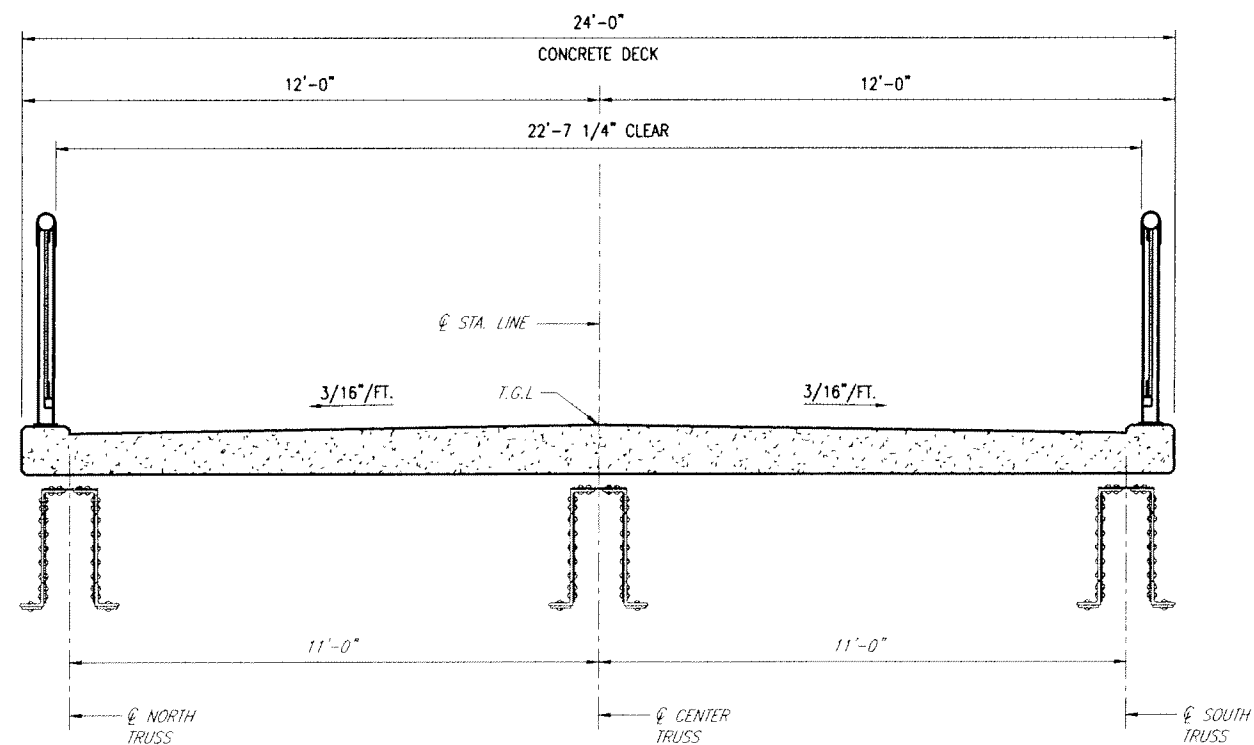

PROPOSED SECTION A-A
(TRUSS SPAN - WEST APPROACH)
 SCALE: 1/2"=1'-0"



STATE OF NEW YORK
 OFFICE OF PARKS, RECREATION AND HISTORIC PRESERVATION
 EASTERN DISTRICT - TACONIC REGION
 P.O. BOX 308, 75 MILLS MANSION DRIVE
 STAATSBURG, NEW YORK 12580
 (XXX) XXX-XXXX FAX: (XXX) XXX-XXXX

WARNING:
 ANY ALTERATIONS TO THIS DOCUMENT NOT
 CONFORMING TO SECTION 2000
 SUBDIVISION 2, NEW YORK STATE EDUCATION
 LAW, ARE STRICTLY PROHIBITED.



**WALKWAY OVER THE HUDSON
 POUGHKEEPSIE - HIGHLAND
 RAILROAD BRIDGE**
**TYPICAL DECK SECTIONS -
 TRUSS SPAN -
 WEST APPROACH**

XXX DESIGNED		
XXX DRAWN		
XXX CHECKED		
AS SHOWN SCALE		
FEB. 2008 DATE	NO. DATE	REVISIONS

SHEET NO. D-14

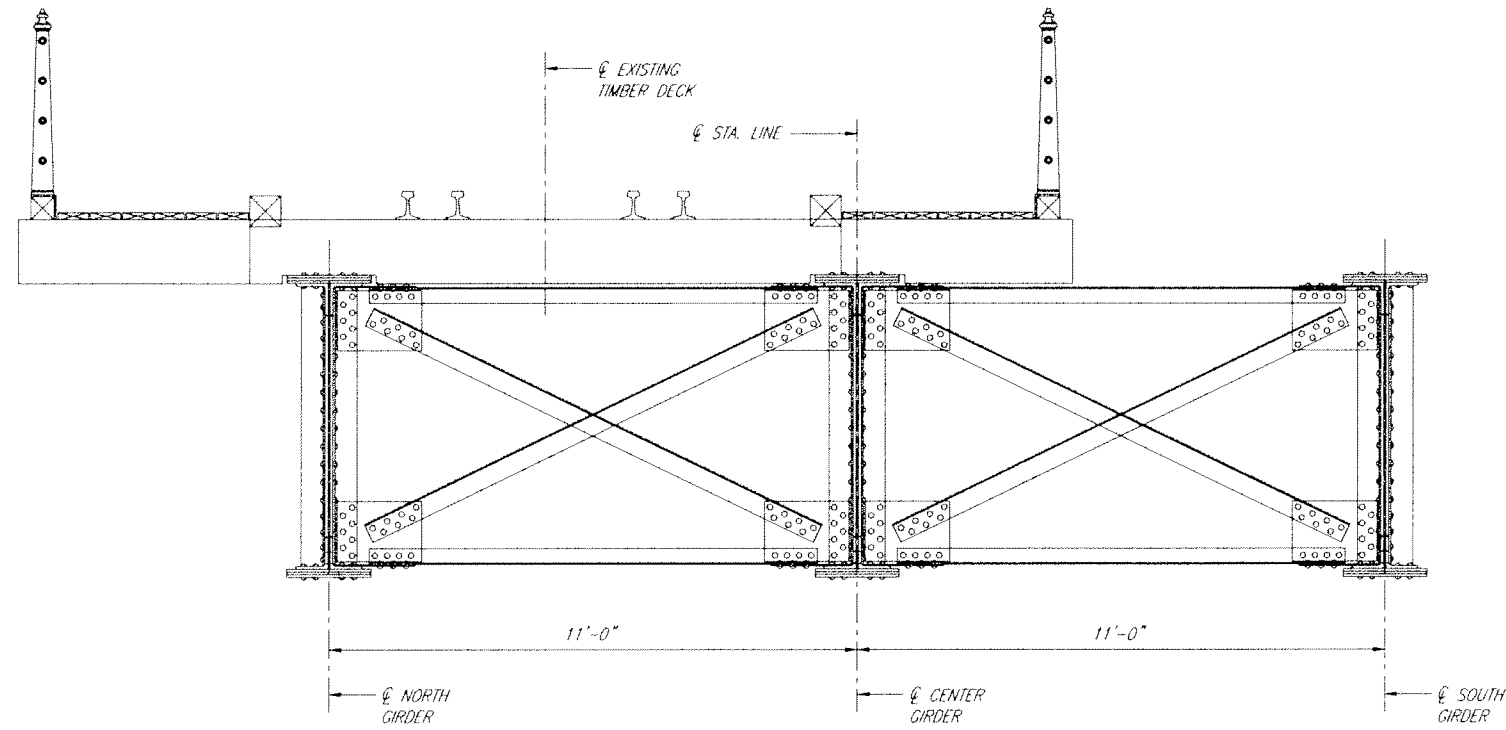

**EXISTING SECTION B-B
(GIRDER SPAN - EAST & WEST APPROACH)**

SCALE: 1/2" = 1'-0"

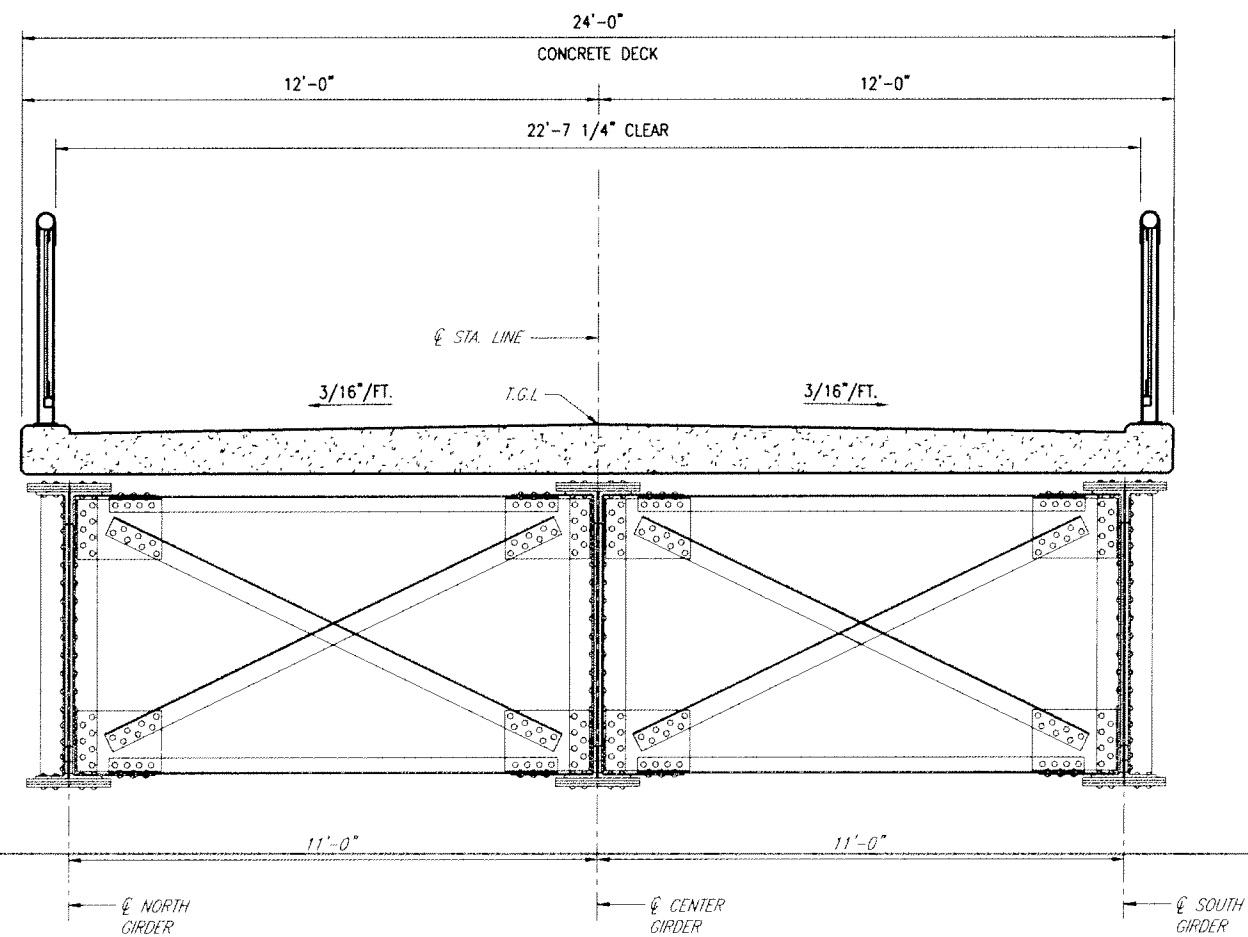

**PROPOSED SECTION B-B
(GIRDER SPAN - EAST & WEST APPROACH)**

SCALE: 1/2" = 1'-0"



STATE OF NEW YORK
OFFICE OF PARKS, RECREATION AND HISTORIC PRESERVATION
EASTERN DISTRICT - TACONIC REGION
P.O. BOX 308, 75 MILLS MANSION DRIVE
STAATSBURG, NEW YORK 12580
(XXX) XXX-XXXX FAX: (XXX) XXX-XXXX

WARNING:
ANY ALTERATIONS TO THIS DOCUMENT NOT
CONFORMING TO SECTION 2206
SUBDIVISION 2, NEW YORK STATE EDUCATION
LAW, ARE STRICTLY PROHIBITED.



WALKWAY OVER THE HUDSON
POUGHKEEPSIE - HIGHLAND
RAILROAD BRIDGE
TYPICAL DECK SECTIONS
GIRDER SPAN -
EAST & WEST APPROACH

XXX DESIGNED		
XXX DRAWN		
XXX CHECKED		
AS SHOWN SCALE		
FEB. 2008 DATE	NO.	DATE
	REVISIONS	

SHEET NO. D-15

FILE NO. 7494_SC2.DWG

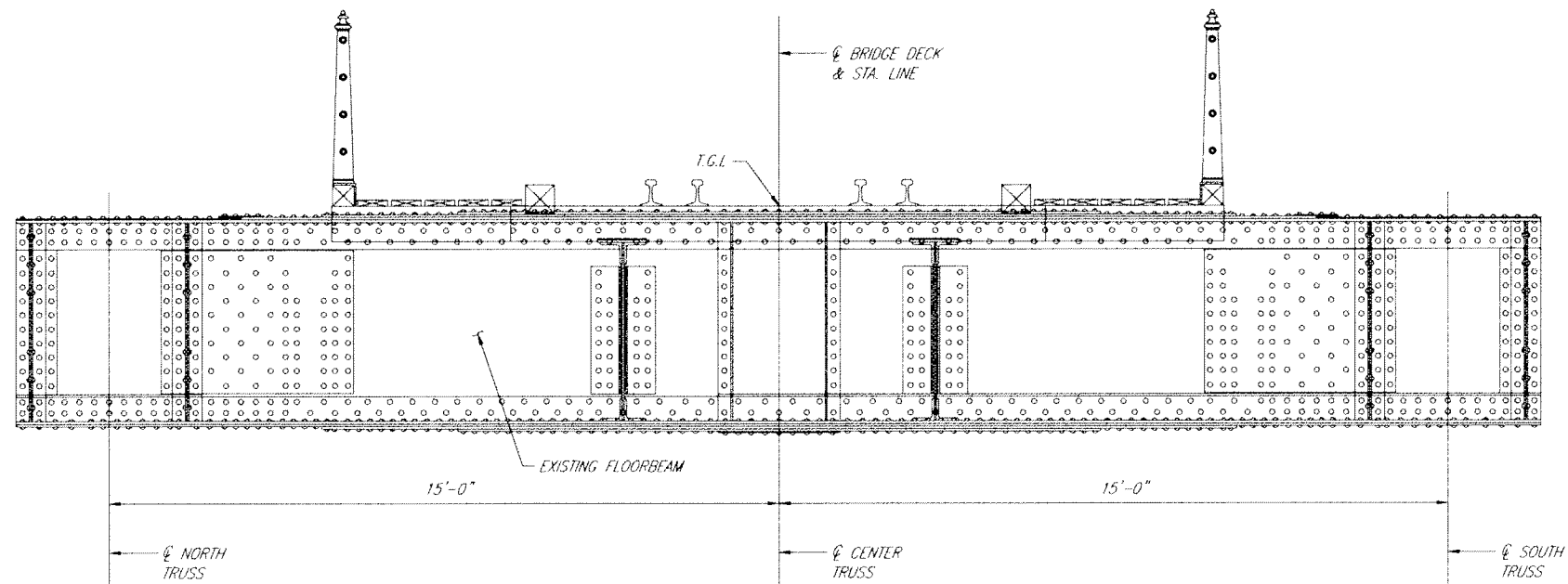

**EXISTING SECTION C-C
(MAIN SPAN)**
SCALE: 1/2" = 1'-0"

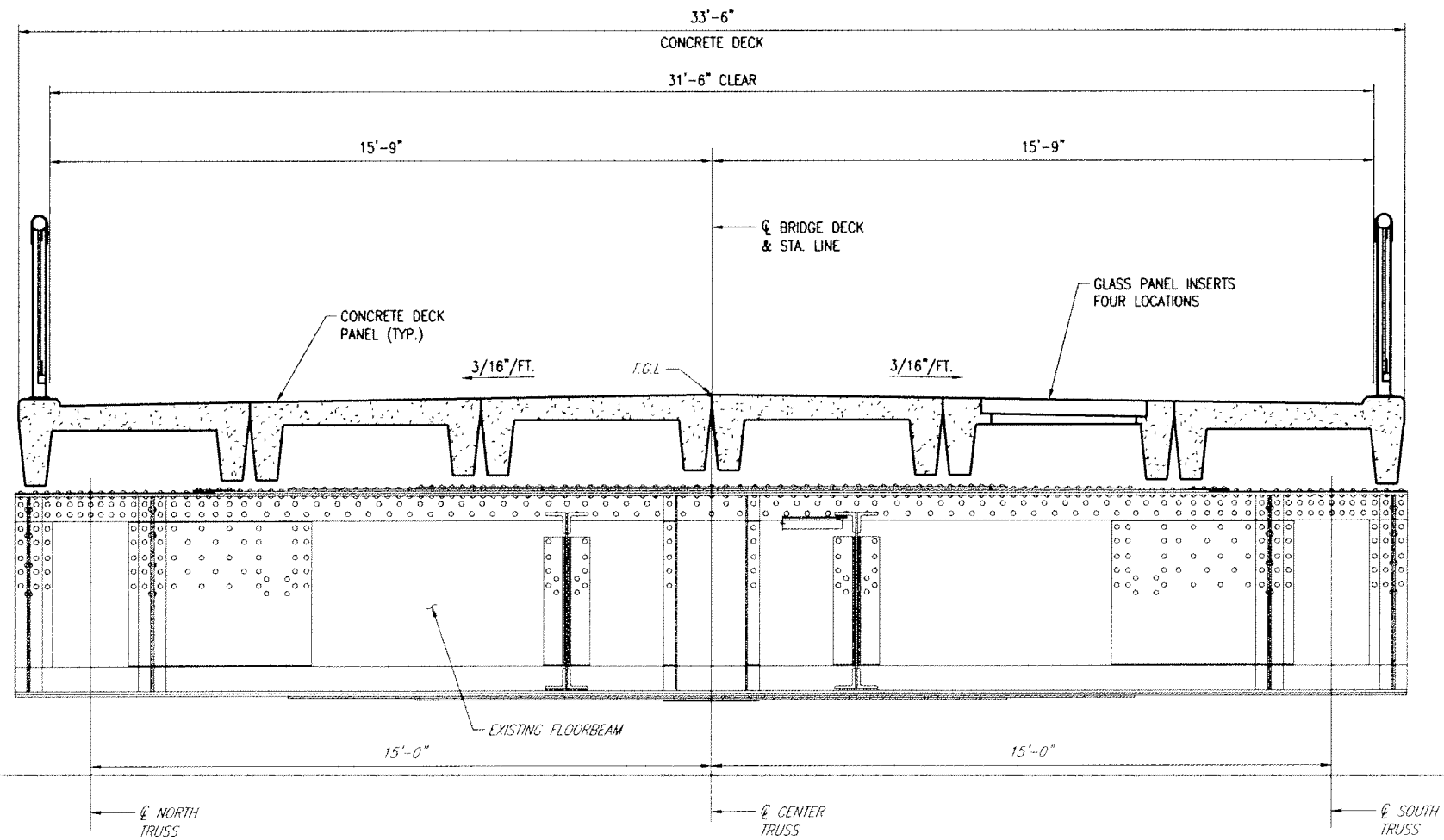

**PROPOSED SECTION C-C
(MAIN SPAN)**
SCALE: 1/2" = 1'-0"



STATE OF NEW YORK
OFFICE OF PARKS, RECREATION AND HISTORIC PRESERVATION
EASTERN DISTRICT - TACONIC REGION
P.O. BOX 308, 75 MILLS MANSION DRIVE
STAATSBURG, NEW YORK 12580
(XXX) XXX-XXXX FAX: (XXX) XXX-XXXX

WARNING:
ANY ALTERATIONS TO THIS DOCUMENT NOT
CONFORMING TO SECTION 7004
SUBDIVISION 2, NEW YORK STATE EDUCATION
LAW, ARE STRICTLY PROHIBITED.



WALKWAY OVER THE HUDSON
POUGHKEEPSIE - HIGHLAND
RAILROAD BRIDGE
TYPICAL DECK SECTIONS
MAIN SPAN

XXX DESIGNED		
XXX DRAWN		
XXX CHECKED		
AS SHOWN SCALE:		
FEB. 2008 DATE	NO.	DATE
	REVISIONS	

SHEET NO. D-16

FILE NO. 7494_SC3.DWG

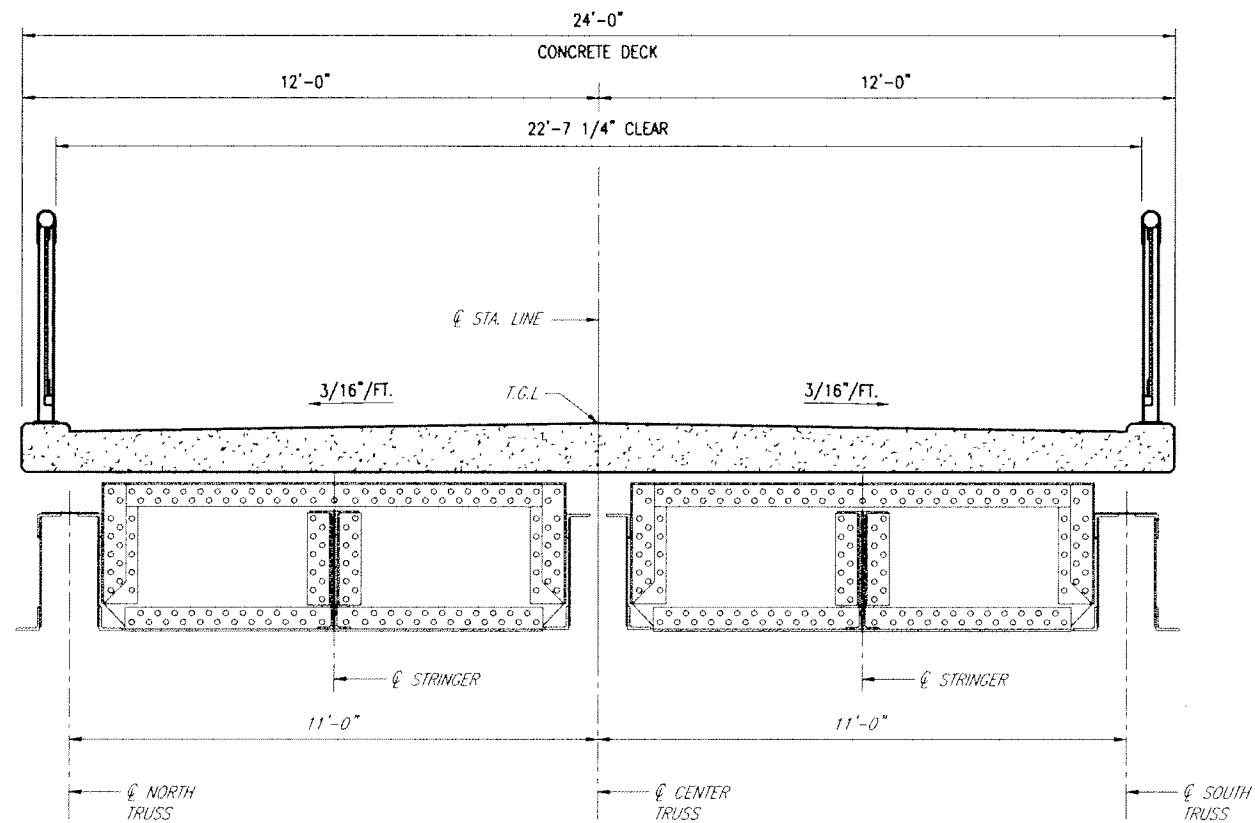

PROPOSED SECTION D-D
 (TRUSS SPAN - EAST APPROACH)
 SCALE: 1/2" = 1'-0"



OFFICE OF PARKS, RECREATION AND HISTORIC PRESERVATION
 STATE OF NEW YORK
 EASTERN DISTRICT - TACONIC REGION
 P.O. BOX 308, 75 MILLS MANSION DRIVE
 STAATSBURG, NEW YORK 12580
 (XXX) XXX-XXXX FAX: (XXX) XXX-XXXX

WARNING:
 ANY ALTERATIONS TO THIS DOCUMENT NOT
 CONFORMING TO SECTION 7296
 SUBDIVISION 3, NEW YORK STATE EDUCATION
 LAW, ARE STRICTLY PROHIBITED.



WALKWAY OVER THE HUDSON
 POUGHKEEPSIE - HIGHLAND
 RAILROAD BRIDGE
 TYPICAL DECK SECTION
 TRUSS SPAN -
 EAST APPROACH

XXX DESIGNED		
XXX DRAWN		
XXX CHECKED		
AS SHOWN SCALE		
FEB. 2008 DATE	NO.	DATE
	REVISIONS	

SHEET NO. D-17

