



West River Shoreline Trail

LANDSCAPE MANAGEMENT PLAN

Grand Island, NY

Virtual Public Meeting

5:30 pm, Tuesday | January 26th, 2021



Parks, Recreation
and Historic Preservation

Meeting Etiquette

- 1. All attendees are automatically muted due to the size of our meeting.**
- 2. This meeting will be recorded.**
- 3. We encourage people to participate and ask questions using the chat window at any point during the presentation. We will have time to discuss questions and comments at the end of the meeting.**
- 4. If you're joining the meeting by phone and cannot view the presentation, a pdf will be made available online.**



Meeting Agenda

- 1. Introduction & Quick Poll**
- 2. Ongoing Projects & Maintenance Operations**
- 3. Philosophy**
- 4. Landscape Management Plan Recommendations**
- 5. Other Initiatives**
- 6. Questions and Comments**



Purpose of the Meeting

- **To introduce the public to the landscape management plan and sustainable strategies for the West River Shoreline Trail**
- **To develop an understanding of the project's philosophy, goals and objectives**



Site Location

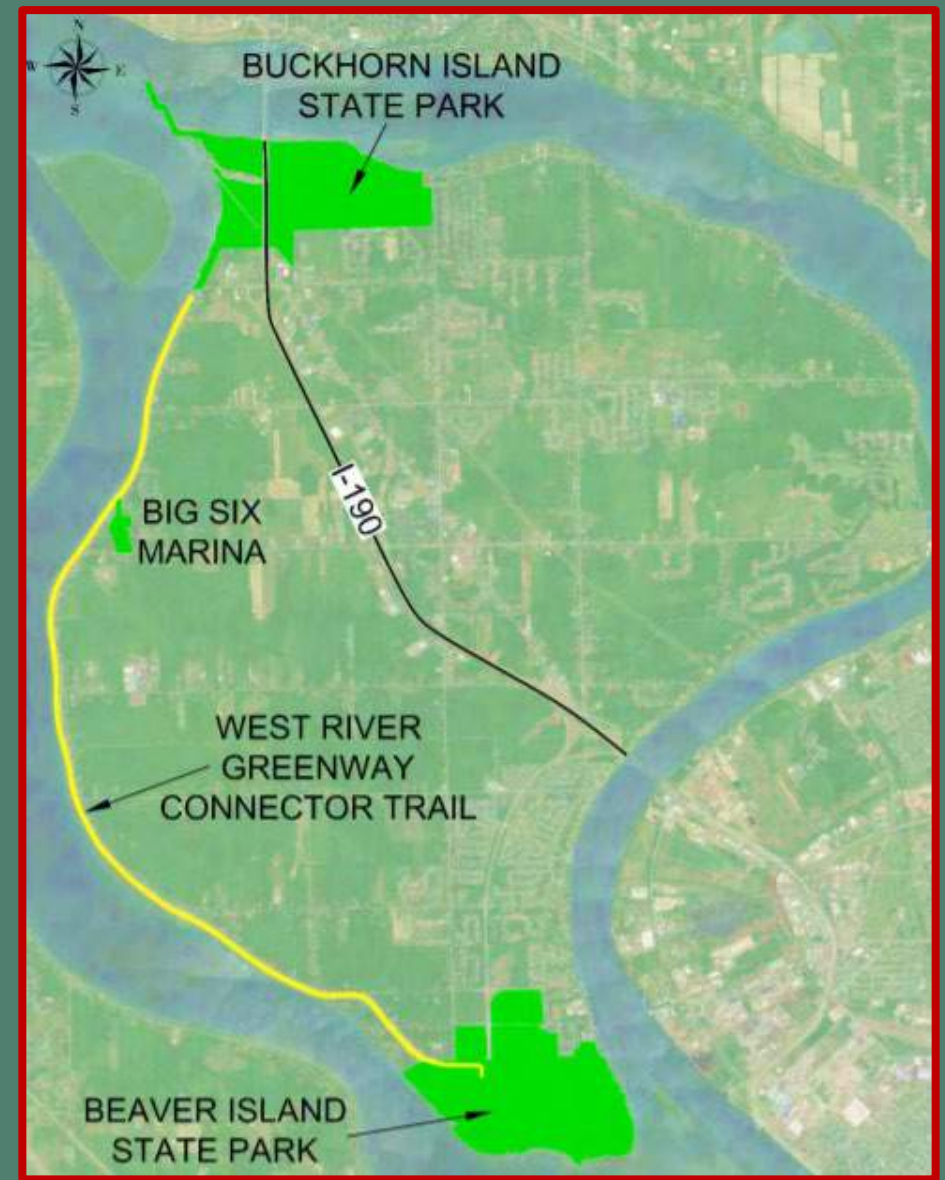
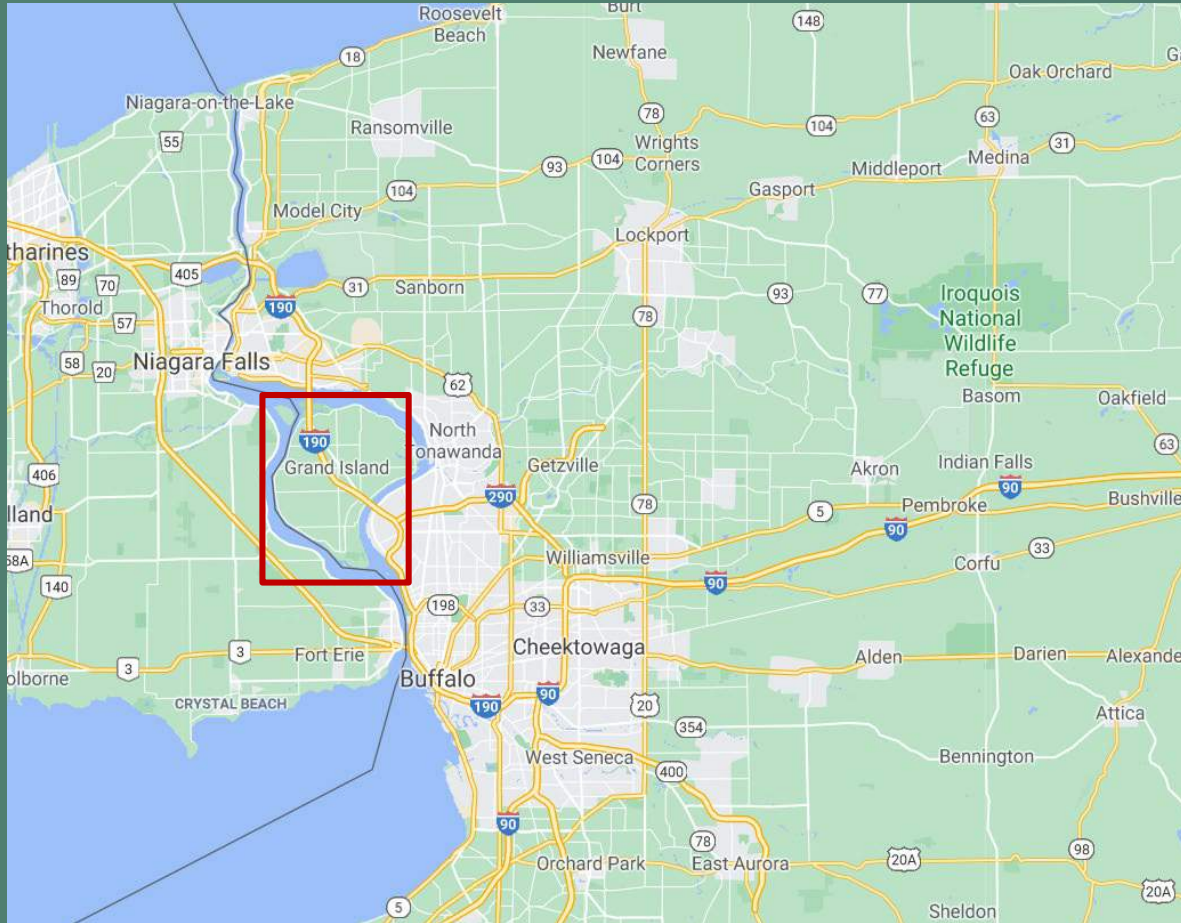

Ongoing Projects and Maintenance Operations

- 1) Parks has over \$200k invested in new equipment
- 2) Site clean-up: unpermitted structure, stair and tree removals
- 3) Drain inlet repairs



Ongoing Projects and Maintenance Operations

3) Parks FORCES Pilot Project: Shoreline Invasive Species Removal and Extensive Invasive Species Inventory Report



Project Philosophy

- Rich and varied landscapes bring people joy. They represent the web of life, in a balanced ecosystem of soil, plants, water, air and light. With this in mind, landscapes cannot be seen solely as an object to be manipulated into static artificiality.
- Our goal is to enhance the ecology and landscape quality of the Trail and Shoreline and create a natural and interesting landscape while preserving scenic viewsheds.



Project Philosophy

- This philosophy and goal motivate us to create a transition in select areas from mowed lawn to managed grassland.
- **20% will be managed as meadow/high-mow which is periodically mowed to 5” when growth reaches 24” max. height and 80% will be managed as mowed lawn/low-mow is mowed more frequently to 3”, when growth reaches 6” max. height.**



Project Philosophy

- **Trees are fundamental to park landscapes because they add visual interest and dimension. They are an indispensable kingpin in landscape ecology while inspiring a sense of awe, and physical comfort.**
- **Canopy species will have a significant presence in some areas of the trail and set an example for the future**
- **Flowering native trees are planned along the fringes of existing shrub and tree masses.**



Project Philosophy







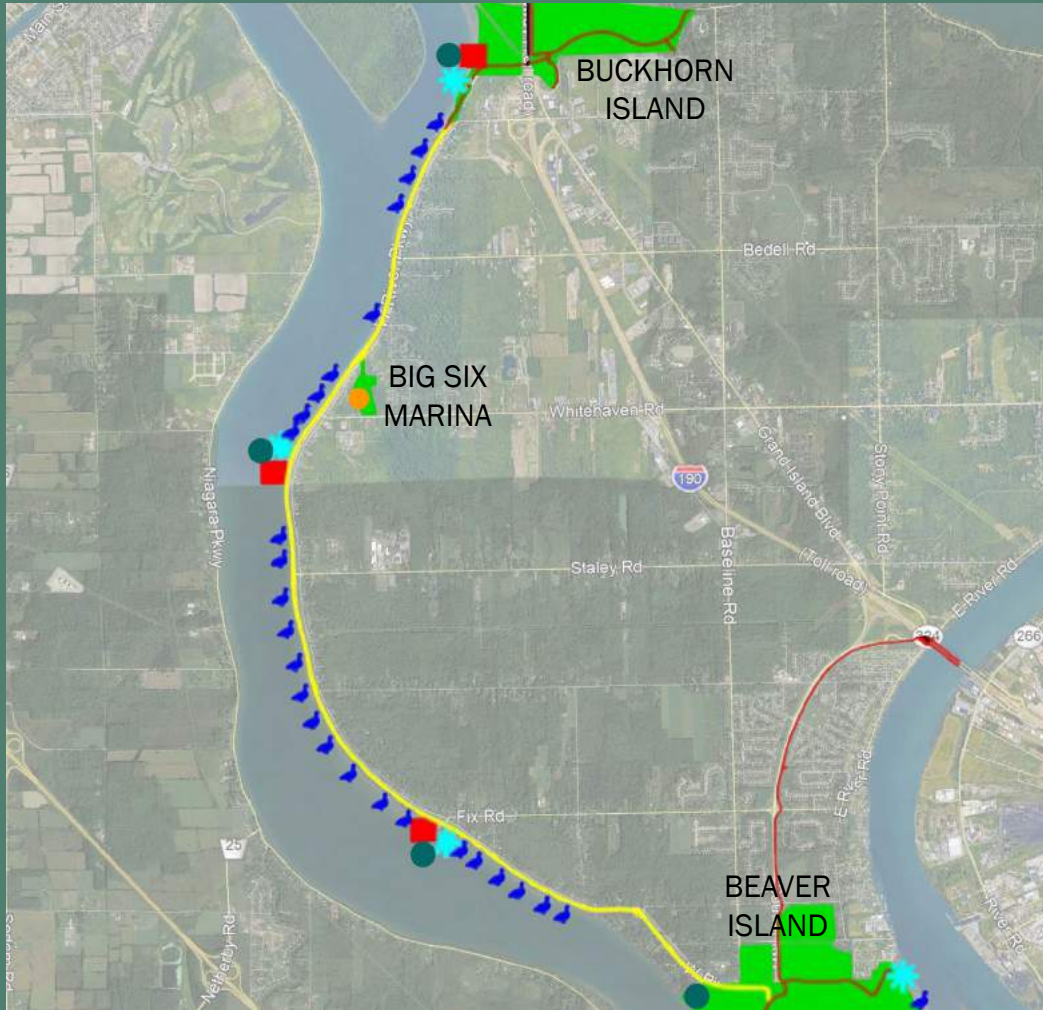

- Trail signs, portable toilets (4 each), trash and dog waste receptacles are installed and maintained by Parks at overlooks, parking areas, trail termini, and certain road and trail intersections.



Overall Amenities Map



LEGEND:

-  WEST RIVER SHORELINE TRAIL
-  EXISTING MULTI-USE TRAIL
-  NEW YORK STATE PARK
-  EXISTING OVERLOOK LOCATION
-  EXISTING PADDLE CRAFT LAUNCH
-  DUCK BLIND LOCATION
-  PORTABLE TOILET LOCATION
-  SEASONAL RESTROOM

Landscape Management Plan



**Parks, Recreation
and Historic Preservation**

West River Parkway: Landscape Management Plan

Key Recommendations



- 1) Maintain existing viewsheds towards the water
- 2) Allow regeneration of native vegetation along the shoreline and integrate invasive species management within the existing wooded areas
- 3) Enhance gateway connections into the Trail
- 4) Create high-mow areas around existing tree groupings to simplify mowing and to avoid mower damage to trees

Key Recommendations

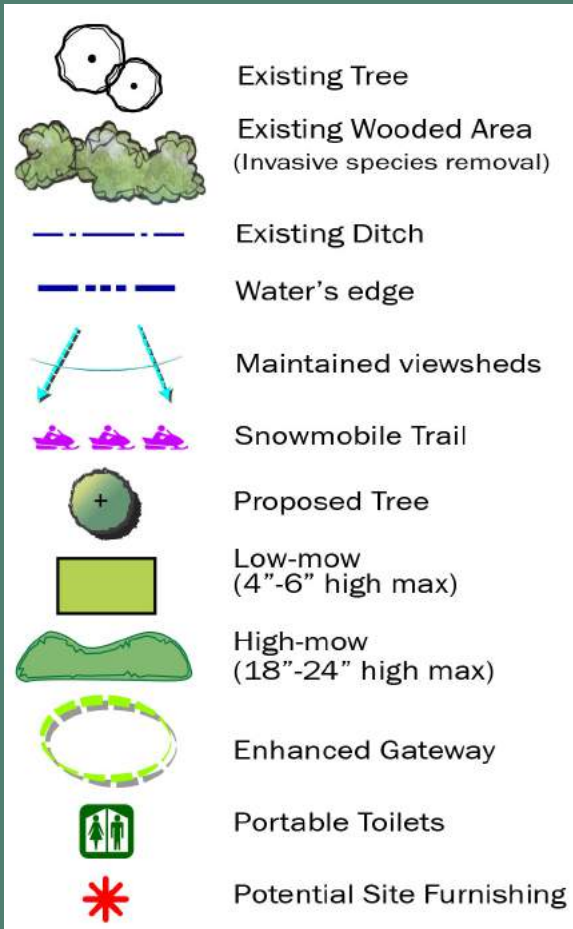

- 5) Provide a defined undulating/contoured mow edge that enhances the natural landscape
- 6) Where appropriate, provide mowed paths through naturalized meadows
- 7) Preserve and maintain existing ditches and drainage features
- 8) Provide (4) locations for portable toilets (two year-round & 2 seasonal) and additional site furnishing

Typical Plans & Section-Elevations

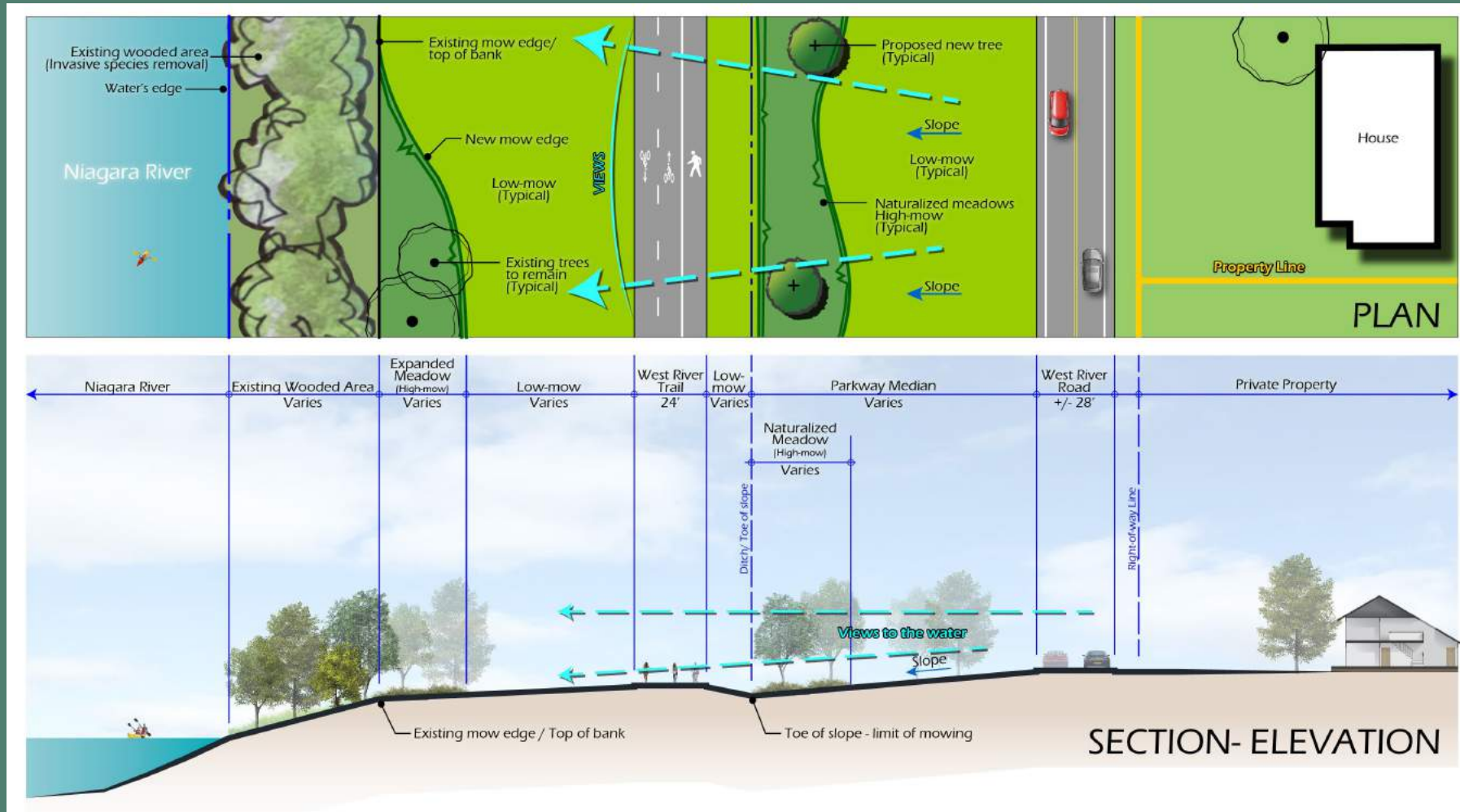

Typical Plans & Section-Elevations

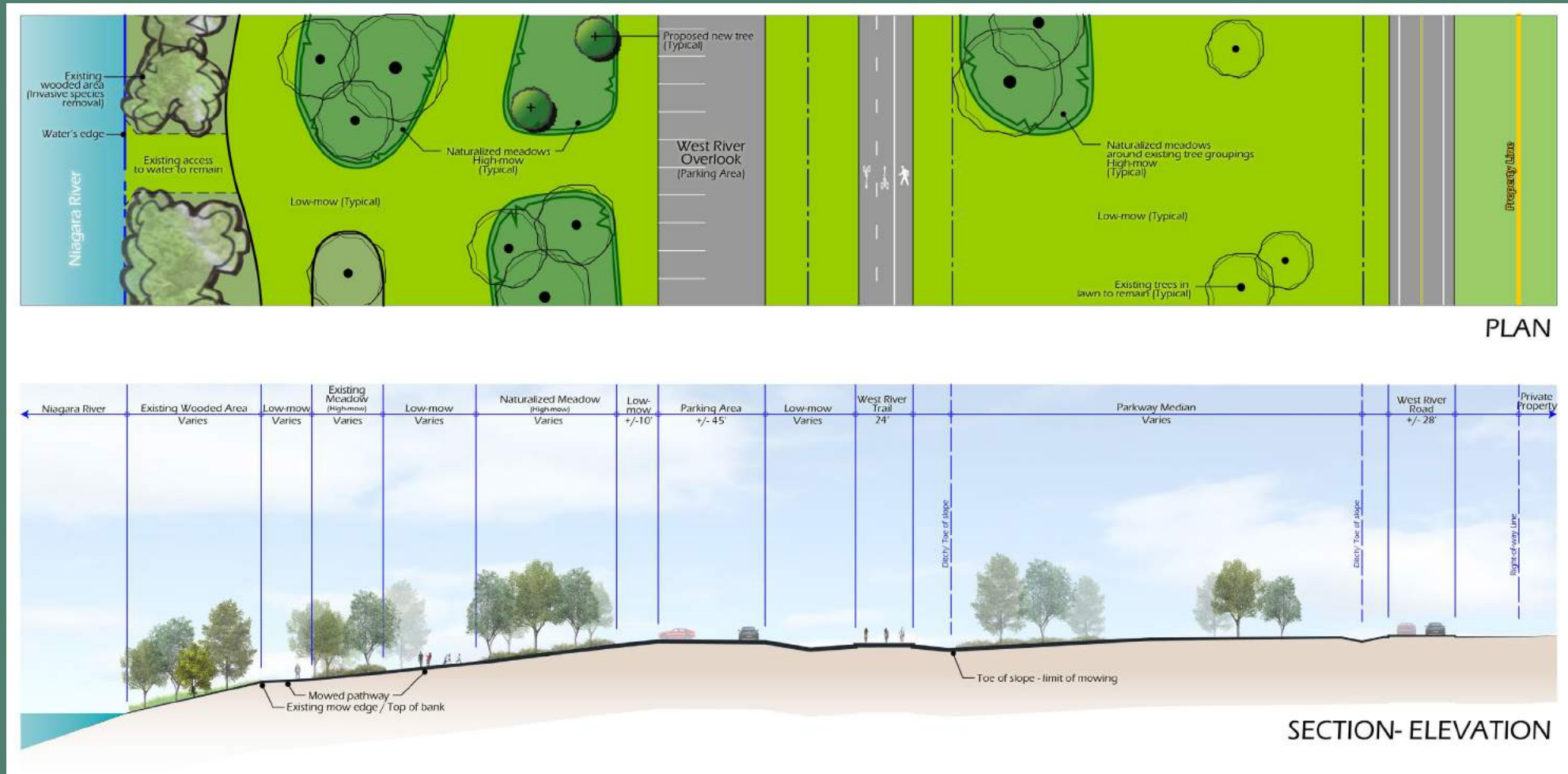

Key Plan & Legend



- Existing Tree
- Existing Wooded Area (Invasive species removal)
- Existing Ditch
- Water's edge
- Maintained viewsheds
- Snowmobile Trail
- Proposed Tree
- Low-mow (4"-6" high max)
- High-mow (18"-24" high max)
- Enhanced Gateway
- Portable Toilets
- Potential Site Furnishing



Parks, Recreation and Historic Preservation

West River Parkway: Landscape Management Plan

Key Plan & Legend



- Existing Tree
- Existing Wooded Area (Invasive species removal)
- Existing Ditch
- Water's edge
- Maintained viewsheds
- Snowmobile Trail
- Proposed Tree
- Low-mow (4"-6" high max)
- High-mow (18"-24" high max)
- Enhanced Gateway
- Portable Toilets
- Potential Site Furnishing















**Parks, Recreation
and Historic Preservation**

West River Parkway: Landscape Management Plan

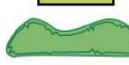
Key Plan & Legend



-  Existing Tree
-  Existing Wooded Area (Invasive species removal)
-  Existing Ditch
-  Water's edge
-  Maintained viewsheds
-  Snowmobile Trail
-  Proposed Tree
-  Low-mow (4"-6" high max)
-  High-mow (18"-24" high max)
-  Enhanced Gateway
-  Portable Toilets
-  Potential Site Furnishing

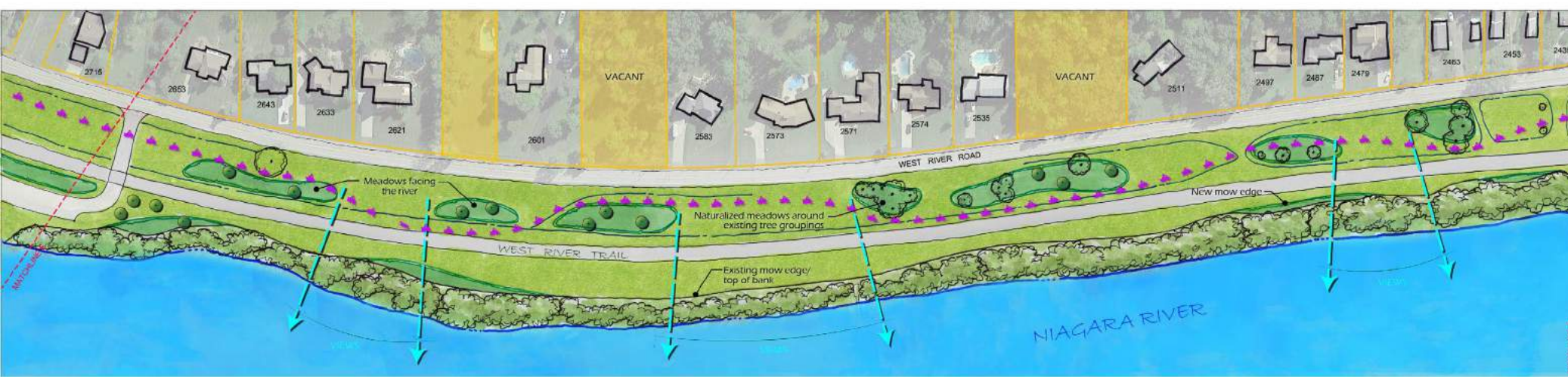

Parks, Recreation and Historic Preservation

West River Parkway: Landscape Management Plan

Key Plan & Legend



- Existing Tree
- Existing Wooded Area (Invasive species removal)
- Existing Ditch
- Water's edge
- Maintained viewsheds
- Snowmobile Trail
- Proposed Tree
- Low-mow (4"-6" high max)
- High-mow (18"-24" high max)
- Enhanced Gateway
- Portable Toilets
- Potential Site Furnishing















Parks, Recreation and Historic Preservation

West River Parkway: Landscape Management Plan

Key Plan & Legend



-  Existing Tree
-  Existing Wooded Area (Invasive species removal)
-  Existing Ditch
-  Water's edge
-  Maintained viewsheds
-  Snowmobile Trail
-  Proposed Tree
-  Low-mow (4"-6" high max)
-  High-mow (18"-24" high max)
-  Enhanced Gateway
-  Portable Toilets
-  Potential Site Furnishing

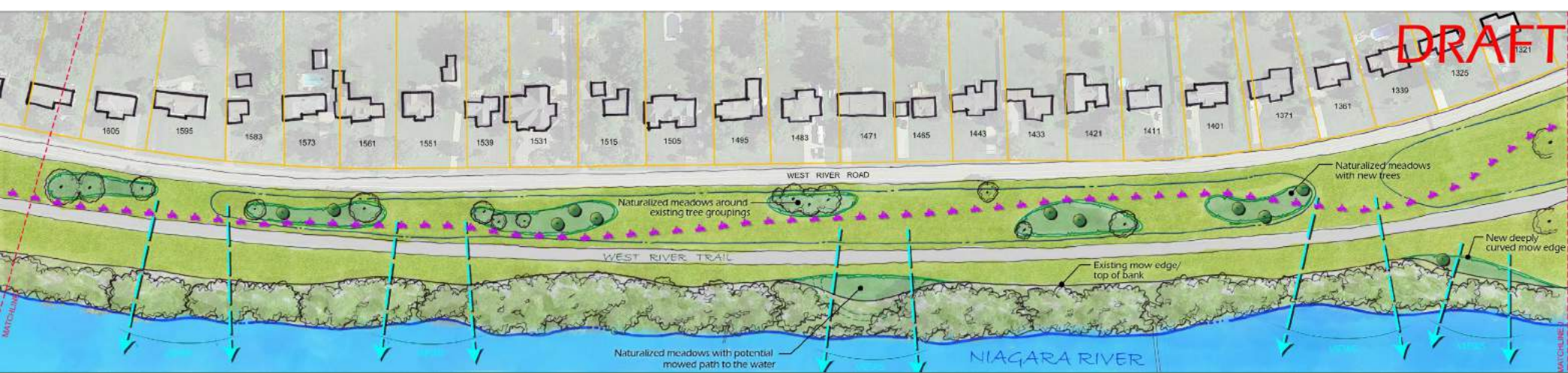













Parks, Recreation and Historic Preservation

West River Parkway: Landscape Management Plan

Key Plan & Legend



-  Existing Tree
-  Existing Wooded Area (Invasive species removal)
-  Existing Ditch
-  Water's edge
-  Maintained viewsheds
-  Snowmobile Trail
-  Proposed Tree
-  Low-mow (4"-6" high max)
-  High-mow (18"-24" high max)
-  Enhanced Gateway
-  Portable Toilets
-  Potential Site Furnishing

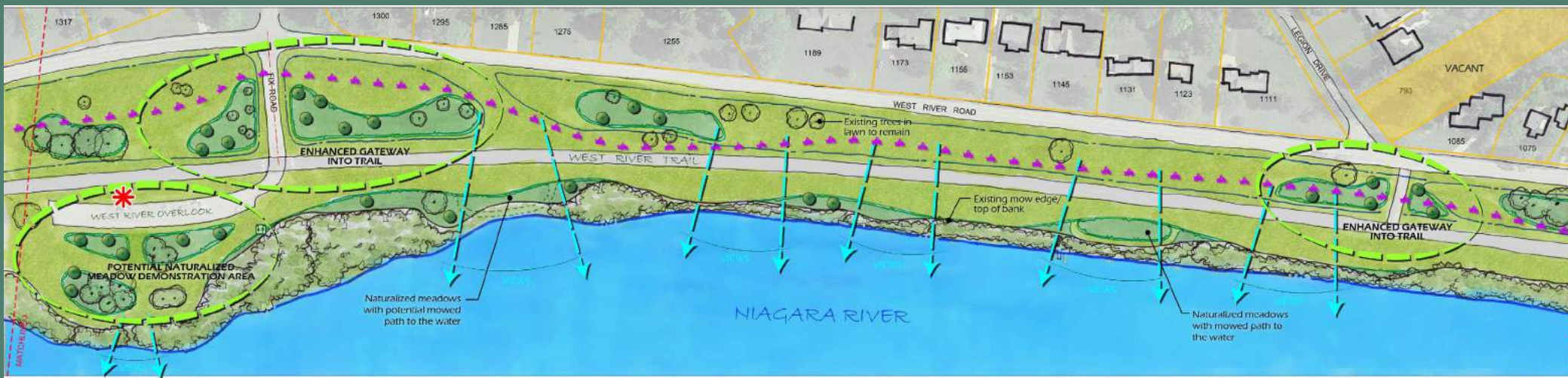













NEW YORK
STATE OF OPPORTUNITY.

**Parks, Recreation
and Historic Preservation**

West River Parkway: Landscape Management Plan

Key Plan & Legend



-  Existing Tree
-  Existing Wooded Area (Invasive species removal)
-  Existing Ditch
-  Water's edge
-  Maintained viewsheds
-  Snowmobile Trail
-  Proposed Tree
-  Low-mow (4"-6" high max)
-  High-mow (18"-24" high max)
-  Enhanced Gateway
-  Portable Toilets
-  Potential Site Furnishing

DRAFT









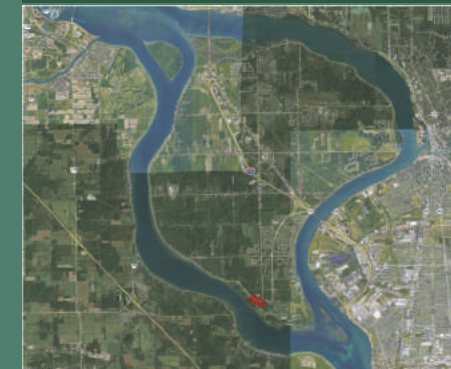





Parks, Recreation and Historic Preservation

West River Parkway: Landscape Management Plan

Key Plan & Legend



-  Existing Tree
-  Existing Wooded Area
(Invasive species removal)
-  Existing Ditch
-  Water's edge
-  Maintained viewsheds
-  Snowmobile Trail
-  Proposed Tree
-  Low-mow
(4"-6" high max)
-  High-mow
(18"-24" high max)
-  Enhanced Gateway
-  Portable Toilets
-  Potential Site Furnishing



NEW YORK
STATE OF OPPORTUNITY.

**Parks, Recreation
and Historic Preservation**

West River Parkway: Landscape Management Plan

Plant Palette



Acer x freemanii 'Jeffersred'
Autumn Blaze Maple



Acer rubrum 'October Glory'
October Glory Red Maple



Amelanchier x grandiflora
'Autumn Brilliance'
Autumn Brilliance Serviceberry



Celtis occidentalis
Hackberry



Cercis canadensis
Eastern Redbud



Crataegus crusgalli inermis
Thornless Cockspur Hawthorn



Gleditsia triacanthos inermis
'Skyline'
Skyline Honeylocust



Liriodendron tulipifera
Tuliptree



Malus 'Prairiefire'
Prairiefire Crabapple



Malus 'Profusion'
Profusion Crabapple



Malus x 'Robinson'
Robinson Crabapple



Platanus x acerifolia
'Bloodgood'
London Planetree



Prunus sargentii
Sargent Cherry



Prunus serotina
Black Cherry



Quercus palustris
Pin Oak



Quercus rubra
Red Oak



Tilia americana
American Basswood



Ulmus americana 'Princeton'
Princeton Elm



Ulmus x 'Accolade'
Accolade Elm



Ulmus x 'Triumph'
Triumph Elm

Other Initiatives



West River Shoreline Habitat Enhancement

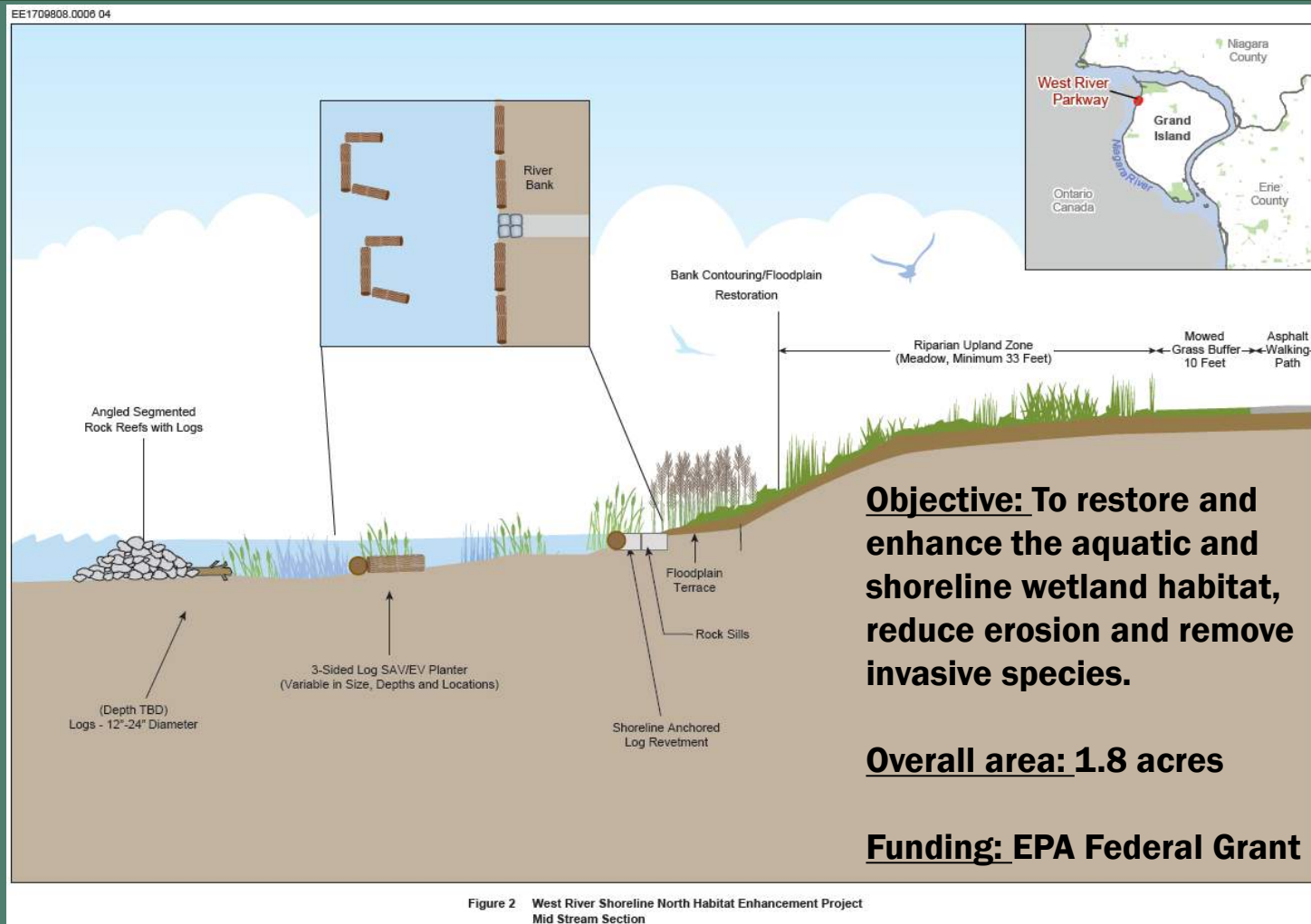
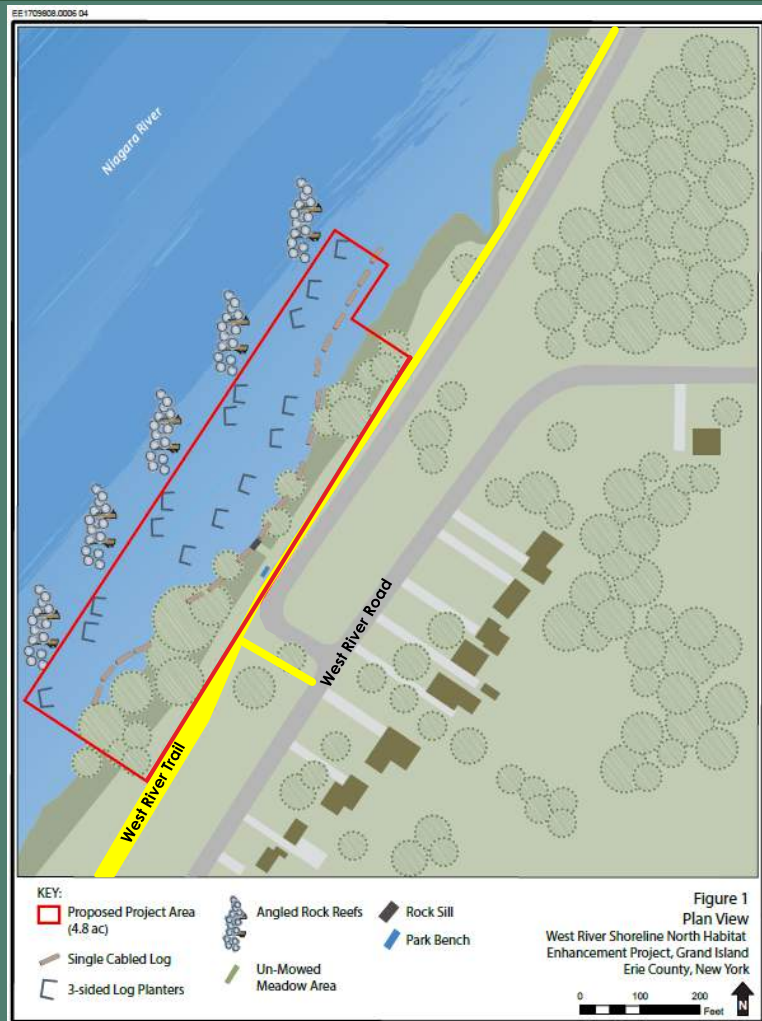

PCA- Pollinator Conservation Area

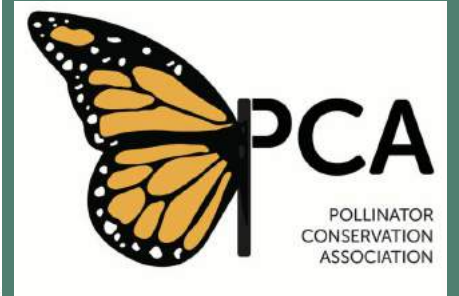
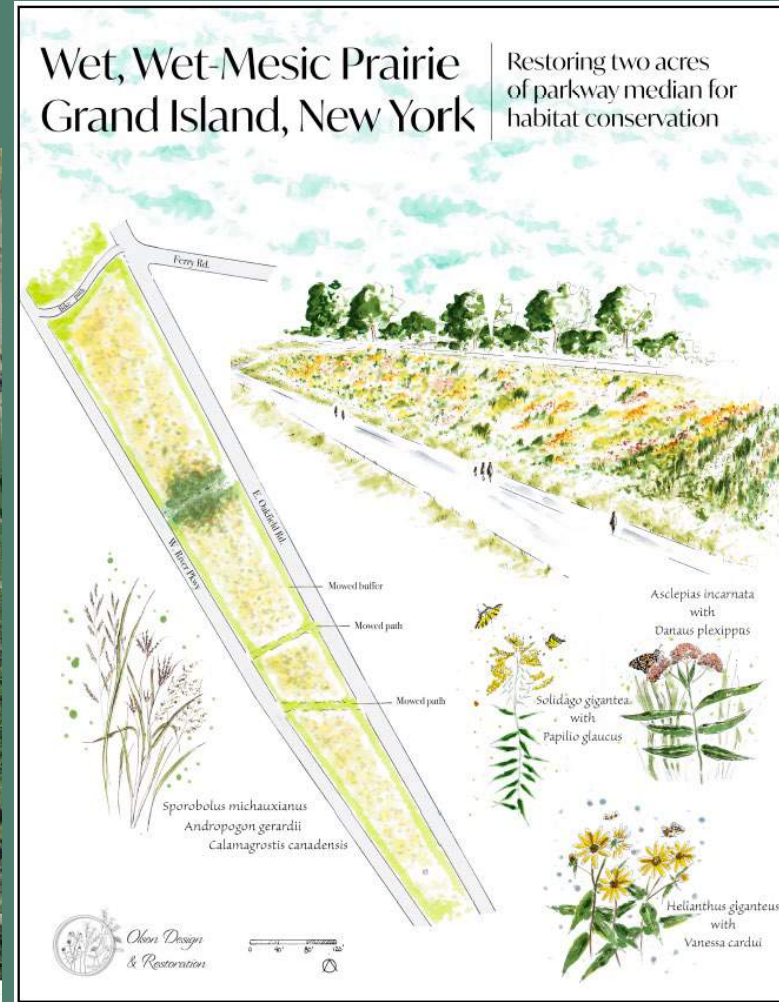

**Parks, Recreation
and Historic Preservation**

West River Parkway: Landscape Management Plan

**Please send any additional
questions or comments to:
Angela.berti@parks.ny.gov**





Questions and Comments



**Parks, Recreation
and Historic Preservation**