

# SNOWMOBILE MAP

## LETCWORTH STATE PARK

"The Grand Canyon of the East"



New York State  
Parks, Recreation and  
Historic Preservation

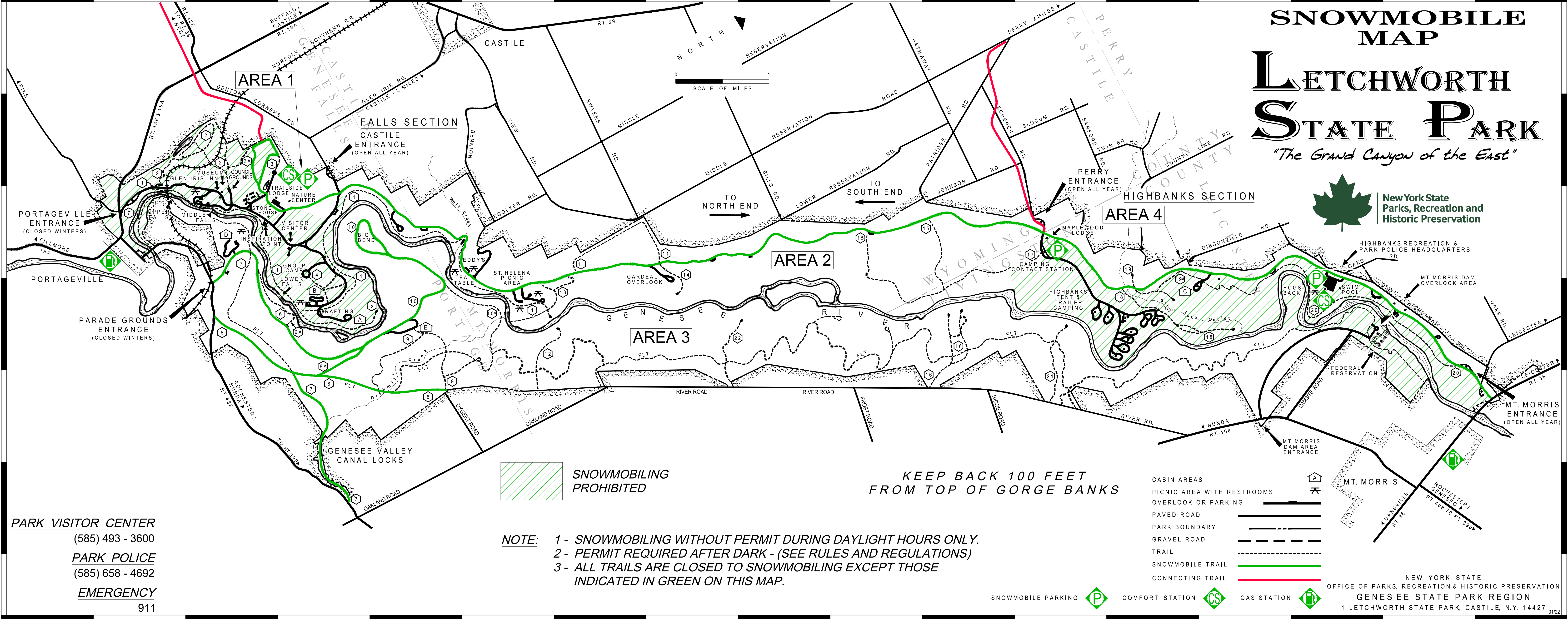

**PARK VISITOR CENTER**  
(585) 493 - 3600

**PARK POLICE**  
(585) 658 - 4692

**EMERGENCY**  
911

**SNOWMOBILING PROHIBITED**

**KEEP BACK 100 FEET FROM TOP OF GORGE BANKS**

**NOTE:**

- 1 - SNOWMOBILING WITHOUT PERMIT DURING DAYLIGHT HOURS ONLY.
- 2 - PERMIT REQUIRED AFTER DARK - (SEE RULES AND REGULATIONS)
- 3 - ALL TRAILS ARE CLOSED TO SNOWMOBILING EXCEPT THOSE INDICATED IN GREEN ON THIS MAP.

CABIN AREAS	
PICNIC AREA WITH RESTROOMS	
OVERLOOK OR PARKING	
PAVED ROAD	
PARK BOUNDARY	
GRAVEL ROAD	
TRAIL	
SNOWMOBILE TRAIL	
CONNECTING TRAIL	
SNOWMOBILE PARKING	
COMFORT STATION	
GAS STATION	

NEW YORK STATE  
OFFICE OF PARKS, RECREATION & HISTORIC PRESERVATION  
GENESEE STATE PARK REGION  
1 LETCORTH STATE PARK, CASTILE, N.Y. 14427 01/22

### LETCWORTH STATE PARK SNOWMOBILE AREAS

**AREA 1** (2.47 Miles)

All Land Between the West Park Boundary and the West Side of the Park Road Between the Portageville Entrance Road and the Trailside Lodge Road *Except:*

- a. Area within 100 Feet of Trailside Lodge Recreation Area. (Snow-Tubing Hill and Ice Skating Pond)
- b. Within 100 Feet of Top of Gorge Banks and All Cliffs and Ravines.
- c. Area South of the Archery Field and East of the Snowmobile Trail. (Archery Field Service Road)

**AREA 2** (8.60 Miles)

All Land Between the West Park Boundary and the Genesee River and Between the Castile Entrance Road and the Perry Entrance Road *Except:*

- a. Within 100 Feet of Top of Gorge Banks and All Cliffs and Ravines.
- b. Within 100 Feet of Any Building.

**AREA 4** (5.70 Miles)

All Land Between the West Park Boundary and the West Side of the Park Road and Between the Perry Entrance Road and Route 36 and the Mt. Morris Entrance *Except:*

- a. Within 100 Feet of Any Building.
- b. Any Land on Kisil Point.

**AREA 3** (10.60 Miles)

All Land Between the East Side of the Genesee River South of the Mt. Morris Dam Federal Reservation Boundary and Road *Except:*

- a. Within 100 Feet of Top of Gorge Banks and All Cliffs and Ravines.
- b. Within 100 Feet of Any Building.
- c. Any Land on Hogsback.