

**JONES BEACH STATE PARK**  
**A REVITALIZATION INITIATIVE**  
DRAFT CONCEPTUAL PROPOSAL

MARCH 20, 2014



# THE PARK: END TO END



# FOCUS AREA : WEST BATHHOUSE, CENTRAL MALL, AND EAST BATHHOUSE



# CENTRAL MALL: RESTORED FORMAL LANDSCAPE/ PLANTINGS AND DEVELOPMENT OF EAST MALL SITE



# WEST BATHHOUSE

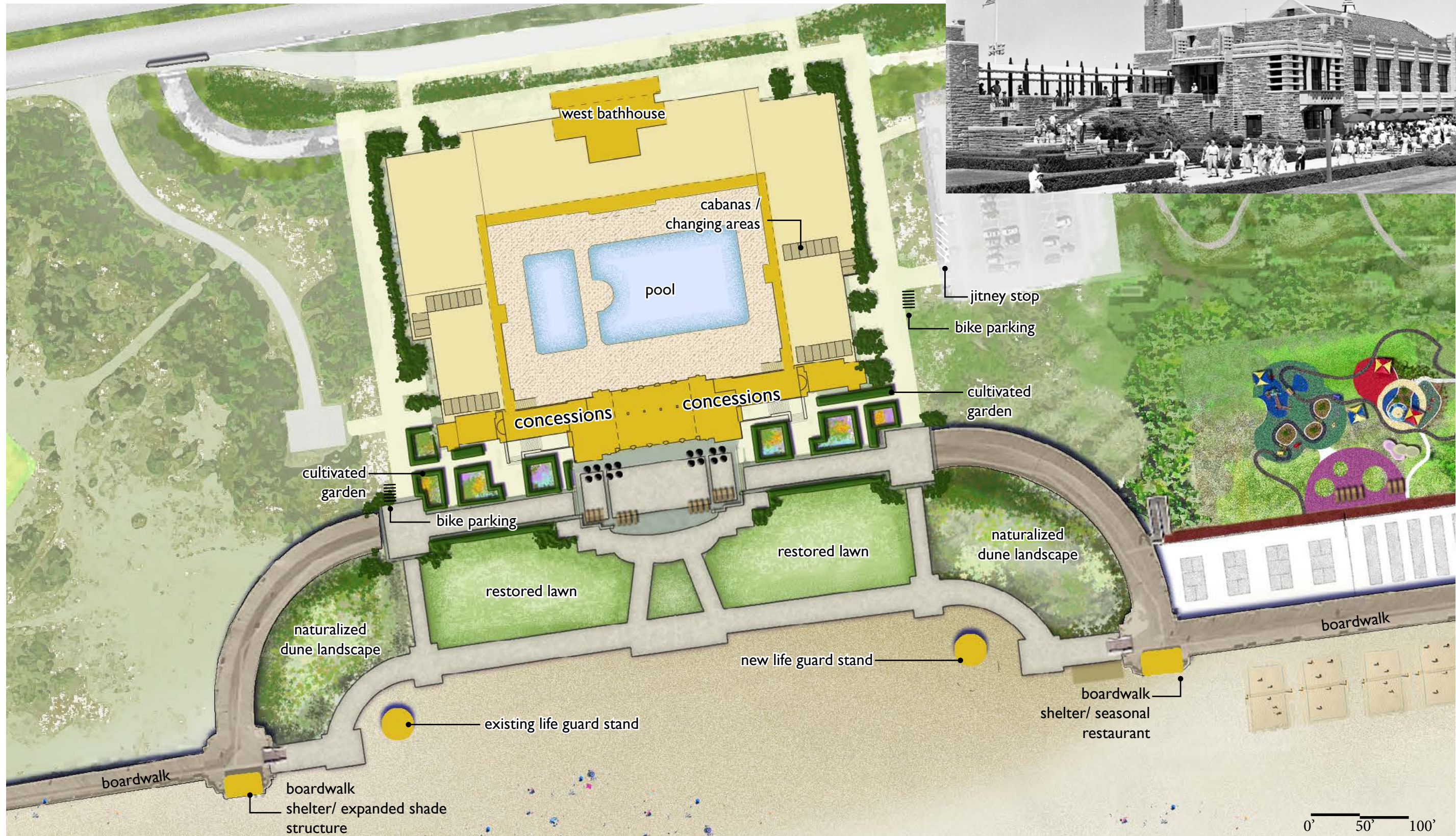

# NEW FOOD/ RETAIL CONCESSIONS



## WEST BATHHOUSE

WBI: SOUTH BUILDING - CONCESSION  
 ESS: EXPANDED SHADE STRUCTURE  
 SR: SEASONAL RESTAURANT

## CENTRAL MALL

CMI: EAST MALL BUILDING - NEW MARKET/RETAIL COMMISSARY  
 CM2: WEST MALL BUILDING - RESTAURANT  
 CM3: ADMINISTRATION BUILDING - MUSEUM/INFO/GIFT SHOP  
 SS: SHADE STRUCTURES

## EAST BATHHOUSE

EBI: SOUTH BUILDING - CONCESSION  
 ESS: EXPANDED SHADE STRUCTURE  
 SR: SEASONAL RESTAURANT

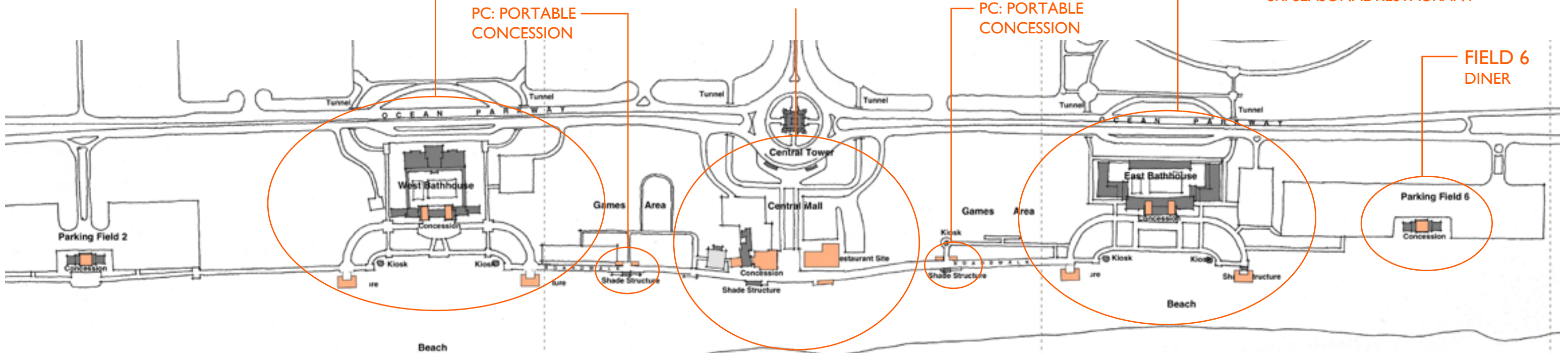

# CIRCULATION: NEW BIKE PATH, JITNEY LOOP, AND AUTOMATED TOLL PLAZA

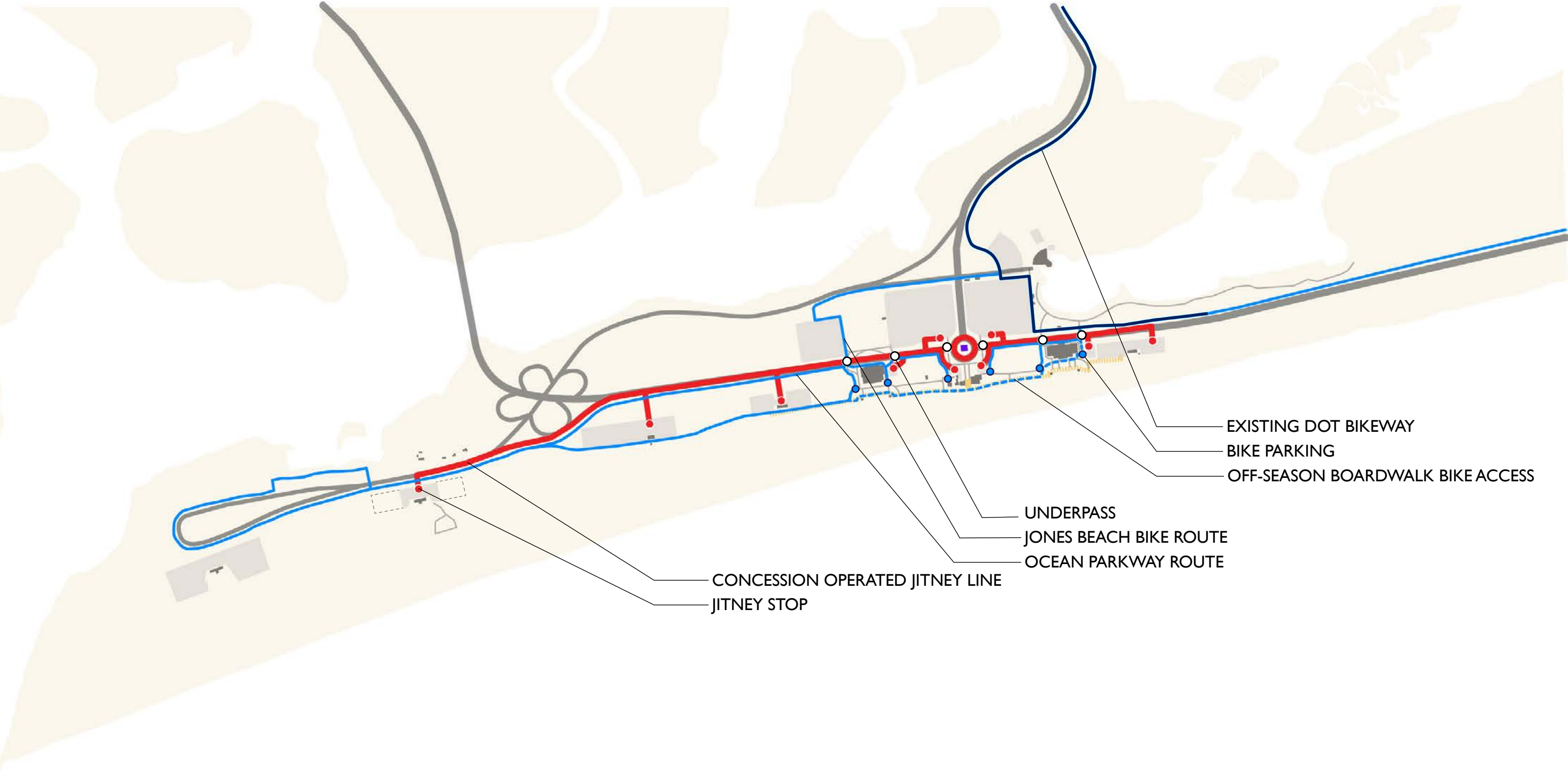

EXISTING DOT BIKEWAY  
BIKE PARKING  
OFF-SEASON BOARDWALK BIKE ACCESS

UNDERPASS  
JONES BEACH BIKE ROUTE  
OCEAN PARKWAY ROUTE

CONCESSION OPERATED JITNEY LINE  
JITNEY STOP

# SPORTS FIELDS DIAGRAM





# EAST GAMES: FLOOD RESISTANT VEGETATION, ELEVATED PLAYGROUND, AND PICNIC AREA



SUMMER 2014 FOOD PILOT ON EAST MALL SITE

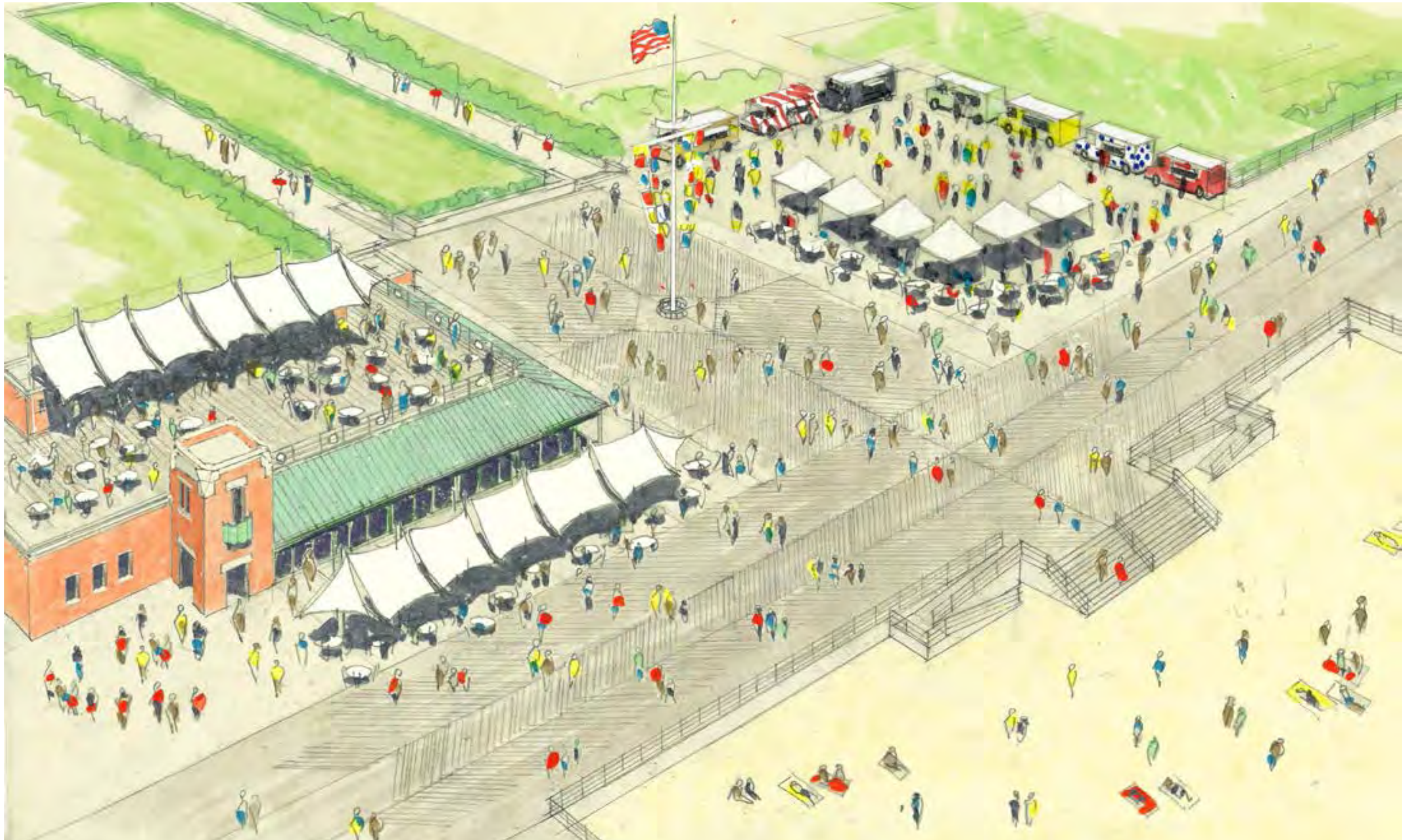

# SUMMER 2014 BEACH-SIDE RESTAURANT BETWEEN EAST BATHHOUSE AND FIELD 6



# AERIAL VIEW OF RESTORED FORMAL LANDSCAPE AND CENTRAL MALL DEVELOPMENT



BOARDWALK VIEW OF EAST MALL MARKETPLACE

