

**BLACK DIAMOND TRAIL**

**MASTER PLAN**

**FIGURE MP 1**  
2008

**Robert H. Treman State Park to Buttermilk Falls State Park**

**Legend**

- Black Diamond Trail Alignment
- Black Diamond Trail Spurs
- Finger Lakes Trail
- Bridge/Creek Crossing
- Road Crossing
- Black Diamond Trail Stations
- Trailheads
- Emergency Access
- Kiosk
- Interpretive Site
- Seating Area
- Areas of Enlargement
- Buildings (1992)
- Municipal Boundaries
- Rail Road
- NYS Parks Lands
- Property to be Acquired
- Other Public Lands
- Forested Areas
- Taxparcels

**References:**  
Tompkins County GIS Program  
Digital Planimetric Series  
2006 Tax Parcels

**NYS Office of Parks, Recreation, & Historic Preservation  
Finger Lakes Region  
Trumansburg, N.Y. 14886**

**Consultants**  
**Larsen Engineers  
Northeast Greenways  
Greg Potter**

N  
W E  
S

New York State Plane  
Central Projection  
1983 North American Datum

**1:6500**

300 0 300 600 Feet  
60 0 60 120 Meters

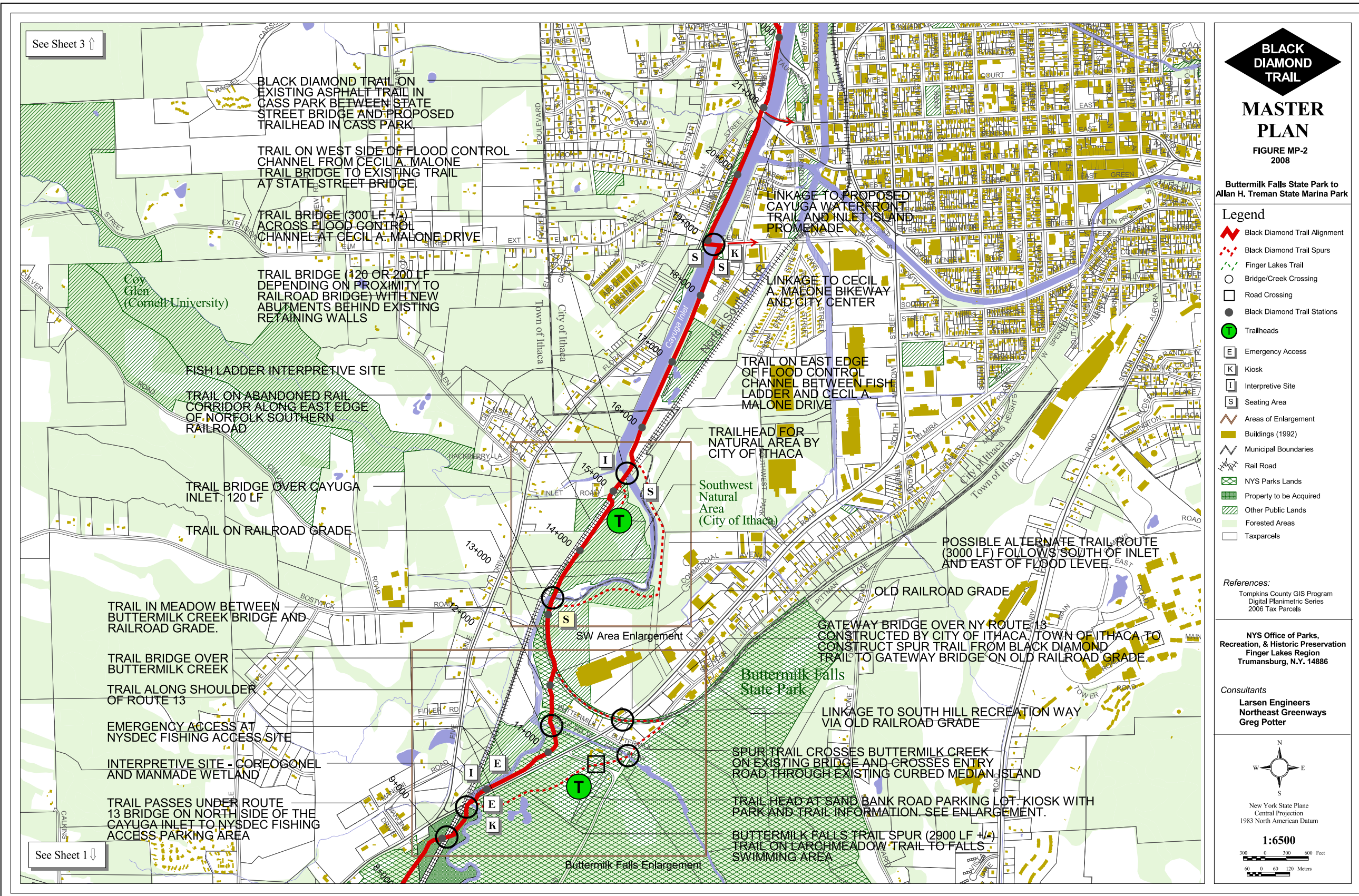

**BLACK DIAMOND TRAIL**  
**MASTER PLAN**  
 FIGURE MP-2  
 2008

Buttermilk Falls State Park to  
 Allan H. Treman State Marina Park

- Legend**
- Black Diamond Trail Alignment
  - Black Diamond Trail Spurs
  - Finger Lakes Trail
  - Bridge/Creek Crossing
  - Road Crossing
  - Black Diamond Trail Stations
  - Trailheads
  - Emergency Access
  - Kiosk
  - Interpretive Site
  - Seating Area
  - Areas of Enlargement
  - Buildings (1992)
  - Municipal Boundaries
  - Rail Road
  - NYS Parks Lands
  - Property to be Acquired
  - Other Public Lands
  - Forested Areas
  - Taxparcels

**References:**  
 Tompkins County GIS Program  
 Digital Planimetric Series  
 2006 Tax Parcels

**NYS Office of Parks,  
 Recreation, & Historic Preservation  
 Finger Lakes Region  
 Trumansburg, N.Y. 14886**

**Consultants  
 Larsen Engineers  
 Northeast Greenways  
 Greg Potter**

North Arrow

New York State Plane  
 Central Projection  
 1983 North American Datum

**1:6500**

Scale bar: 0, 300, 600 Feet / 0, 60, 120 Meters

See Sheet 3 ↑

See Sheet 1 ↓

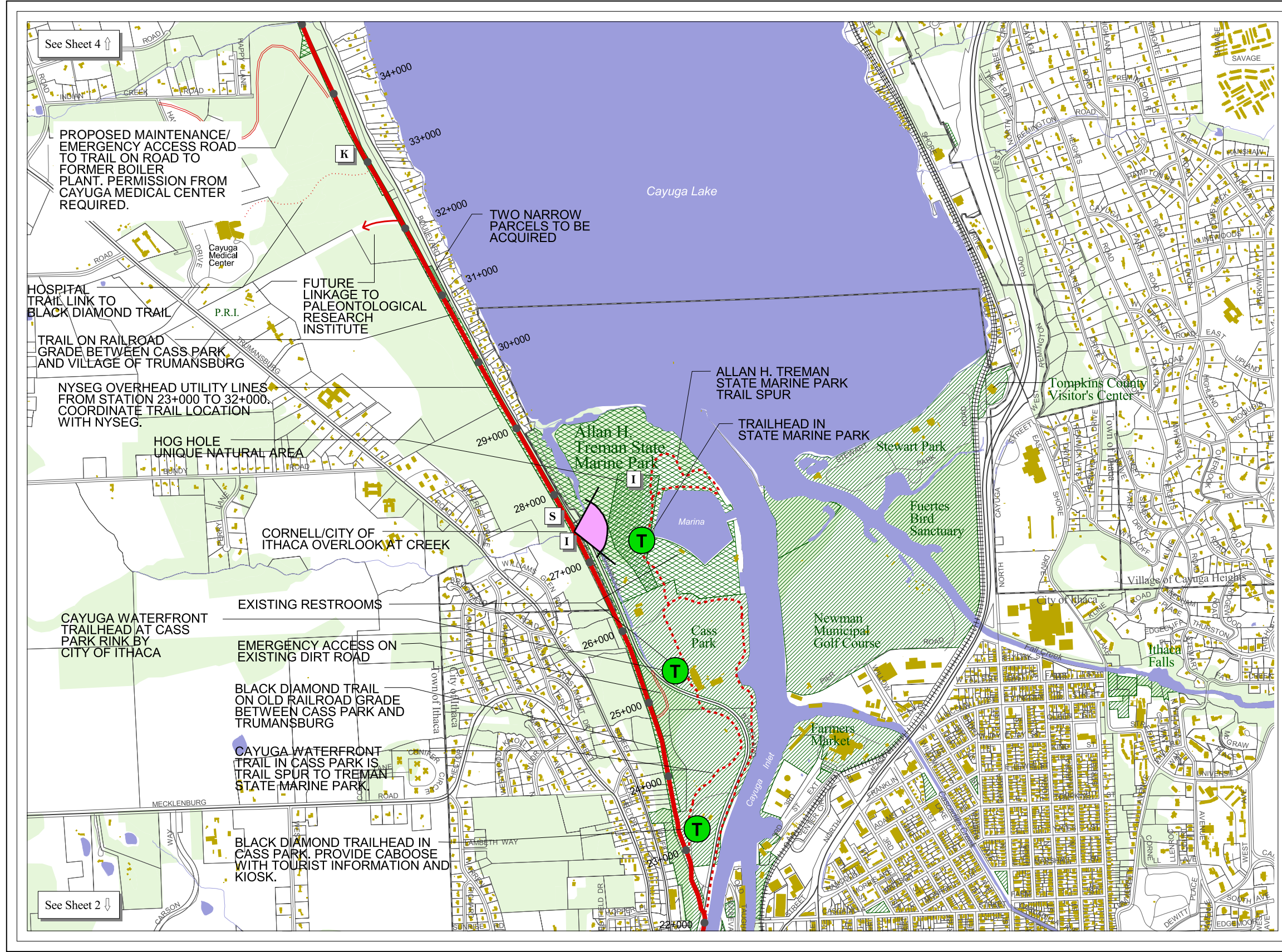

See Sheet 4 ↑

PROPOSED MAINTENANCE/  
EMERGENCY ACCESS ROAD  
TO TRAIL ON ROAD TO  
FORMER BOILER  
PLANT. PERMISSION FROM  
CAYUGA MEDICAL CENTER  
REQUIRED.

HOSPITAL  
TRAIL LINK TO  
BLACK DIAMOND TRAIL

TRAIL ON RAILROAD  
GRADE BETWEEN CASS PARK  
AND VILLAGE OF TRUMANSBURG

NYSEG OVERHEAD UTILITY LINES  
FROM STATION 23+000 TO 32+000.  
COORDINATE TRAIL LOCATION  
WITH NYSEG.

HOG HOLE  
UNIQUE NATURAL AREA

CORNELL/CITY OF  
ITHACA OVERLOOK AT CREEK

CAYUGA WATERFRONT  
TRAILHEAD AT CASS  
PARK RINK BY  
CITY OF ITHACA

EXISTING RESTROOMS

EMERGENCY ACCESS ON  
EXISTING DIRT ROAD

BLACK DIAMOND TRAIL  
ON OLD RAILROAD GRADE  
BETWEEN CASS PARK AND  
TRUMANSBURG

CAYUGA WATERFRONT  
TRAIL IN CASS PARK IS  
TRAIL SPUR TO TREMAN  
STATE MARINE PARK.

BLACK DIAMOND TRAILHEAD IN  
CASS PARK. PROVIDE CABOOSE  
WITH TOURIST INFORMATION AND  
KIOSK.

See Sheet 2 ↓

# BLACK DIAMOND TRAIL

## MASTER PLAN

FIGURE MP-3  
2008

Allan H. Treman State Marina Park  
to Taughannock Falls State Park

### Legend

- Black Diamond Trail Alignment
- Black Diamond Trail Spurs
- Finger Lakes Trail
- Bridge/Creek Crossing
- Road Crossing
- Black Diamond Trail Stations
- Trailheads
- Emergency Access
- Kiosk
- Interpretive Site
- Seating Area
- Areas of Enlargement
- Buildings (1992)
- Municipal Boundaries
- Rail Road
- NYS Parks Lands
- Property to be Acquired
- Other Public Lands
- Forested Areas
- Taxparcels

References:  
Tompkins County GIS Program  
Digital Planimetric Series  
2006 Tax Parcels

NYS Office of Parks,  
Recreation, & Historic Preservation  
Finger Lakes Region  
Trumansburg, N.Y. 14886

Consultants  
**Larsen Engineers**  
**Northeast Greenways**  
**Greg Potter**

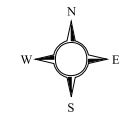

New York State Plane  
Central Projection  
1983 North American Datum

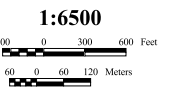

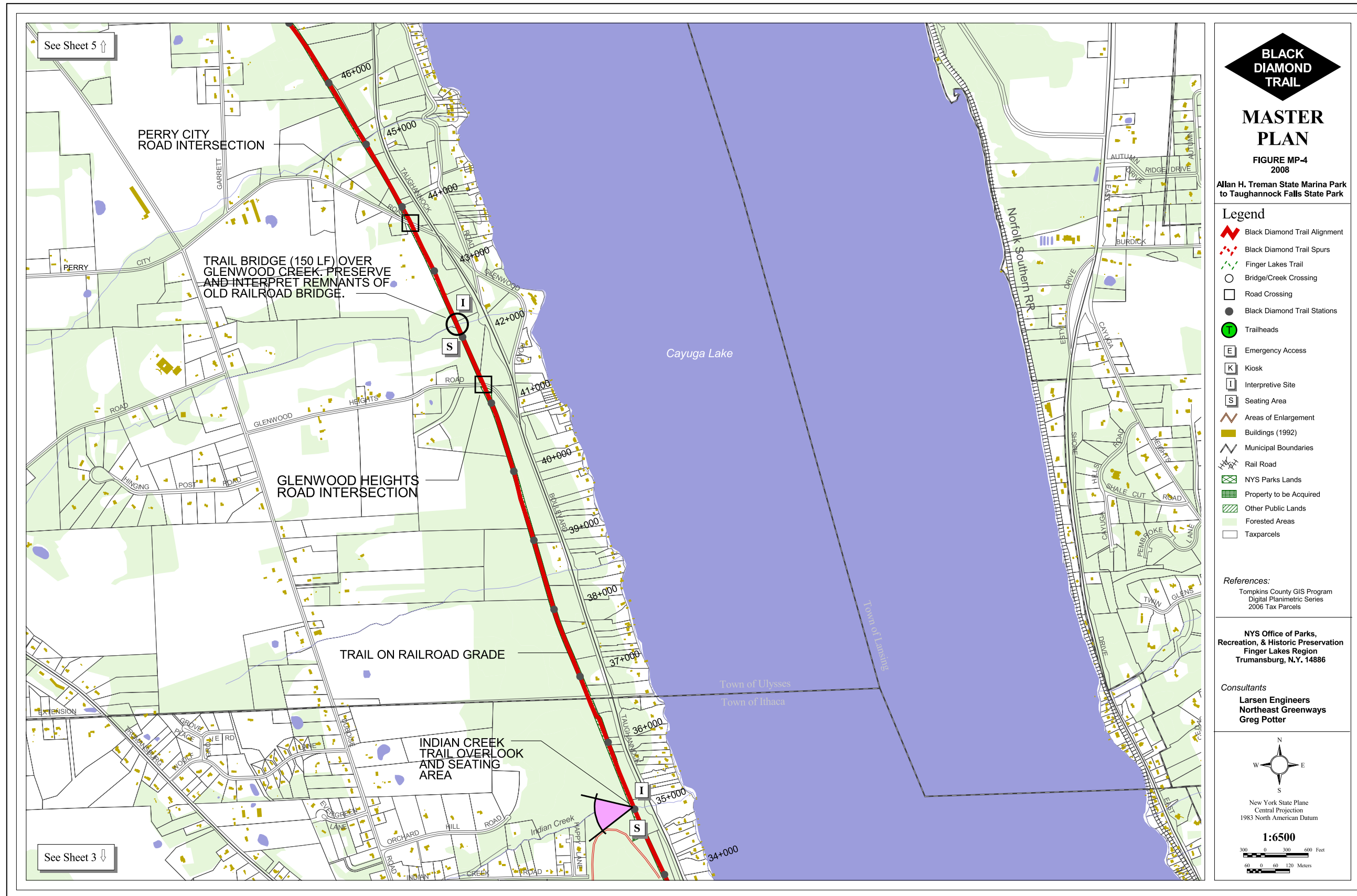

**BLACK  
DIAMOND  
TRAIL**

**MASTER  
PLAN**

FIGURE MP-4  
2008

Allan H. Treman State Marina Park  
to Taughanock Falls State Park

- Legend**
- Black Diamond Trail Alignment
  - Black Diamond Trail Spurs
  - Finger Lakes Trail
  - Bridge/Creek Crossing
  - Road Crossing
  - Black Diamond Trail Stations
  - Trailheads
  - Emergency Access
  - Kiosk
  - Interpretive Site
  - Seating Area
  - Areas of Enlargement
  - Buildings (1992)
  - Municipal Boundaries
  - Rail Road
  - NYS Parks Lands
  - Property to be Acquired
  - Other Public Lands
  - Forested Areas
  - Taxparcels

**References:**  
Tompkins County GIS Program  
Digital Planimetric Series  
2006 Tax Parcels

**NYS Office of Parks,  
Recreation, & Historic Preservation  
Finger Lakes Region  
Trumansburg, N.Y. 14886**

**Consultants  
Larsen Engineers  
Northeast Greenways  
Greg Potter**

N  
W E  
S

New York State Plane  
Central Projection  
1983 North American Datum

**1:6500**

0 300 600 Feet  
0 60 120 Meters

See Sheet 5 ↑

See Sheet 3 ↓

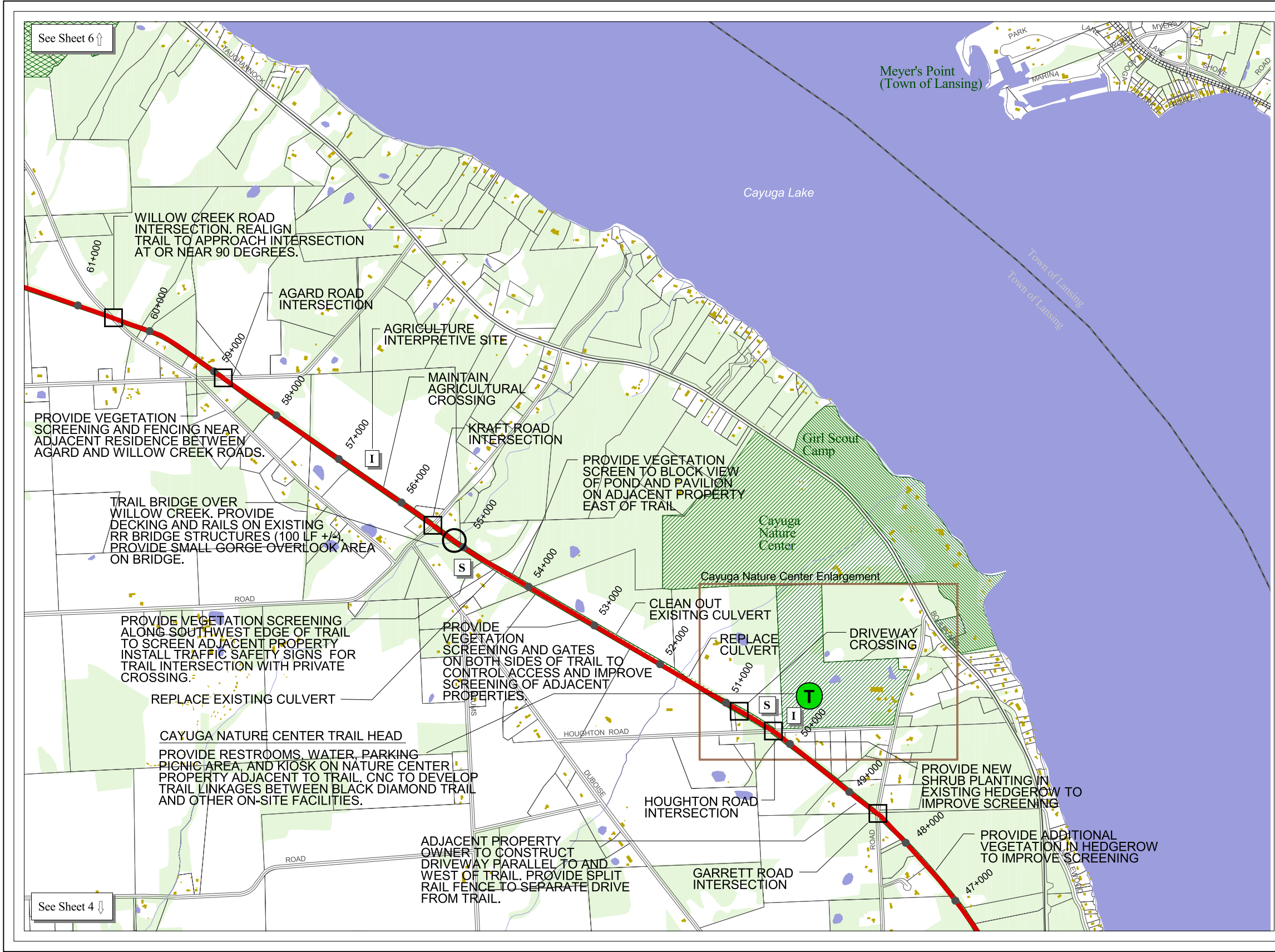

See Sheet 6 ↑

See Sheet 4 ↓

**BLACK DIAMOND TRAIL**

**MASTER PLAN**

FIGURE MP-5  
2008

Allan H. Treman State Marina Park to Taughannock Falls State Park

- Legend**
- Black Diamond Trail Alignment
  - Black Diamond Trail Spurs
  - Finger Lakes Trail
  - Bridge/Creek Crossing
  - Road Crossing
  - Black Diamond Trail Stations
  - Trailheads
  - Emergency Access
  - Kiosk
  - Interpretive Site
  - Seating Area
  - Areas of Enlargement
  - Buildings (1992)
  - Municipal Boundaries
  - Rail Road
  - NYS Parks Lands
  - Property to be Acquired
  - Other Public Lands
  - Forested Areas
  - Taxparcels

**References:**

Tompkins County GIS Program  
Digital Planimetric Series  
2006 Tax Parcels

NYS Office of Parks, Recreation, & Historic Preservation  
Finger Lakes Region  
Trumansburg, N.Y. 14886

**Consultants**

Larsen Engineers  
Northeast Greenways  
Greg Potter

North arrow pointing up.

New York State Plane  
Central Projection  
1983 North American Datum

**1:6500**

Scale bar: 0 to 600 Feet and 0 to 120 Meters.

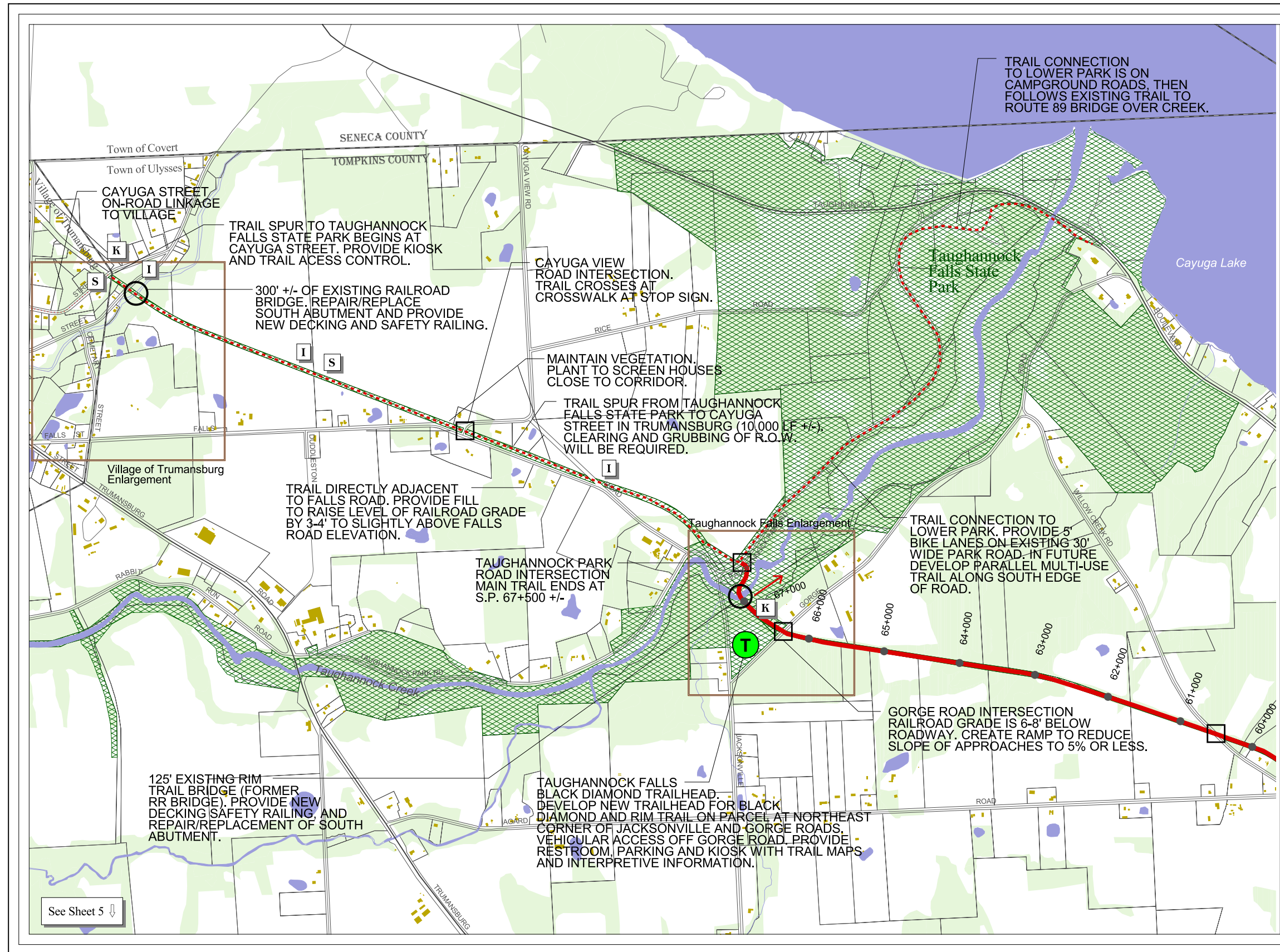

**BLACK  
DIAMOND  
TRAIL**

**MASTER  
PLAN**

FIGURE MP-6  
2008

Allan H. Treman State Marina Park  
to Taughannock Falls State Park

- Legend**
- Black Diamond Trail Alignment
  - Black Diamond Trail Spurs
  - Finger Lakes Trail
  - Bridge/Creek Crossing
  - Road Crossing
  - Black Diamond Trail Stations
  - Trailheads
  - Emergency Access
  - Kiosk
  - Interpretive Site
  - Seating Area
  - Areas of Enlargement
  - Buildings (1992)
  - Municipal Boundaries
  - Rail Road
  - NYS Parks Lands
  - Property to be Acquired
  - Other Public Lands
  - Forested Areas
  - Taxparcels

**References:**  
 Tompkins County GIS Program  
 Digital Planimetric Series  
 2006 Tax Parcels

**NYS Office of Parks,  
 Recreation, & Historic Preservation  
 Finger Lakes Region  
 Trumansburg, N.Y. 14886**

**Consultants**  
**Larsen Engineers  
 Northeast Greenways  
 Greg Potter**

N  
W E  
S

New York State Plane  
 Central Projection  
 1983 North American Datum

**1:6500**

300 0 300 600 Feet  
 60 0 60 120 Meters

See Sheet 5 ↓